



Microsoft

Exam Questions AZ-303



Microsoft Azure Architect Technologies (beta)

NEW QUESTION 1

- (Exam Topic 1)

You need to configure the Device settings to meet the technical requirements and the user requirements. Which two settings should you modify? To answer, select the appropriate settings in the answer area.

Answer Area

 Save  Discard

Users may join devices to Azure AD ⓘ

All Selected None

Selected

No member selected

Additional local administrators on Azure AD joined devices ⓘ

Selected None

Selected

No member selected

Users may register their devices with Azure AD ⓘ

All None

Require Multi-Factor Auth to join devices ⓘ

Yes No

Maximum number of devices per user ⓘ

50

Users may sync settings and app data across devices ⓘ

All Selected None

Selected

No member selected

- A. Mastered
- B. Not Mastered

Answer: A

Explanation:

Box 1: Selected

NEW QUESTION 2

- (Exam Topic 1)

You need to recommend an identify solution that meets the technical requirements. What should you recommend?

- A. federated single-on (SSO) and Active Directory Federation Services (AD FS)
- B. password hash synchronization and single sign-on (SSO)
- C. cloud-only user accounts
- D. Pass-through Authentication and single sign-on (SSO)

Answer: D

Explanation:

Active Directory Federation Services is a feature and web service in the Windows Server Operating System that allows sharing of identity information outside a company's network.

Scenario: Technical Requirements include:

Prevent user passwords or hashes of passwords from being stored in Azure. References: <https://www.sherweb.com/blog/active-directory-federation-services/>

NEW QUESTION 3

- (Exam Topic 1)

You need to implement a backup solution for App1 after the application is moved. What should you create first?

- A. a recovery plan
- B. an Azure Backup Server
- C. a backup policy
- D. a Recovery Services vault

Answer: D

Explanation:

A Recovery Services vault is a logical container that stores the backup data for each protected resource, such as Azure VMs. When the backup job for a protected resource runs, it creates a recovery point inside the Recovery Services vault.

Scenario:

There are three application tiers, each with five virtual machines. Move all the virtual machines for App1 to Azure.

Ensure that all the virtual machines for App1 are protected by backups.

References: <https://docs.microsoft.com/en-us/azure/backup/quick-backup-vm-portal>

NEW QUESTION 4

- (Exam Topic 1)

You need to meet the user requirement for Admin1. What should you do?

- A. From the Subscriptions blade, select the subscription, and then modify the Properties.
- B. From the Subscriptions blade, select the subscription, and then modify the Access control (IAM) settings.
- C. From the Azure Active Directory blade, modify the Properties.
- D. From the Azure Active Directory blade, modify the Groups.

Answer: A

Explanation:

Change the Service administrator for an Azure subscription

- Sign in to Account Center as the Account administrator.
- Select a subscription.
- On the right side, select Edit subscription details.

Scenario: Designate a new user named Admin1 as the service administrator of the Azure subscription. References: <https://docs.microsoft.com/en-us/azure/billing/billing-add-change-azure-subscription-administrator>

NEW QUESTION 5

- (Exam Topic 2)

You have Azure Storage accounts as shown in the following exhibit.

NAME	TYPE	KIND	RESOURCE	LOCATION	SUBSCRIPTL	ACCESS T	REPLICAT
storageaccount1	Storage account	Storage	ContosoRG1	East US	Subscription 1	-	Read-access ge...
storageaccount2	Storage account	StorageV2	ContosoRG1	Central US	Subscription 1	Hot	Geo-redundant...
storageaccount3	Storage account	BlobStorage	ContosoRG1	East US	Subscription 1	Hot	Locally-redund...

Use the drop-down menus to select the answer choice that completes each statement based on the information presented in the graphic.
NOTE: Each correct selection is worth one point.

You can use [answer choice] for Azure Table Storage.

- storageaccount1 only
- storageaccount2 only
- storageaccount3 only
- storageaccount1 and storageaccount2 only
- storageaccount2 and storageaccount3 only

You can use [answer choice] for Azure Blob storage.

- storageaccount3 only
- storageaccount2 and storageaccount3 only
- storageaccount1 and storageaccount3 only
- all the storage accounts

- A. Mastered
- B. Not Mastered

Answer: A

Explanation:

Note: The three different storage account options are: General-purpose v2 (GPv2) accounts, General-purpose v1 (GPv1) accounts, and Blob storage accounts.

- General-purpose v2 (GPv2) accounts are storage accounts that support all of the latest features for blobs, files, queues, and tables.
- Blob storage accounts support all the same block blob features as GPv2, but are limited to supporting only block blobs.

➤ General-purpose v1 (GPv1) accounts provide access to all Azure Storage services, but may not have the latest features or the lowest per gigabyte pricing.
References:
<https://docs.microsoft.com/en-us/azure/storage/common/storage-account-options>

NEW QUESTION 6

- (Exam Topic 2)

You have an Azure SQL database named Db1 that runs on an Azure SQL server named SQLserver1. You need to ensure that you can use the query editor on the Azure portal to query Db1.
What should you do?

- A. Modify the Advanced Data Security settings of Db1
- B. Configure the Firewalls and virtual networks settings for SQLserver1
- C. Copy the ADO.NET connection string of Db1 and paste the string to the query editor
- D. Approve private endpoint connections for SQLserver1

Answer: B

Explanation:

Reference:
<https://docs.microsoft.com/en-us/azure/sql-database/sql-database-connect-query-portal>

NEW QUESTION 7

- (Exam Topic 2)

You have an Azure subscription named Subscription1 that is used by several departments at your company. Subscription1 contains the resources in the following table.

Name	Type
Storage1	Storage account
RG1	Resource group
Container1	Blob container
Share1	File share

Another administrator deploys a virtual machine named VM1 and an Azure Storage account named Storage2 by using a single Azure Resource Manager template. You need to view the template used for the deployment.
From which blade can you view the template that was used for the deployment?

- A. Container1
- B. VM1
- C. Storage2
- D. RG1

Answer: D

NEW QUESTION 8

- (Exam Topic 2)

You create a virtual machine scale set named Scale1. Scale1 is configured as shown in the following exhibit. The subscription contains the Azure SQL databases shown in the following table.

INSTANCES

* Instance count ⓘ

4

* Instance size (View full pricing details) ⓘ

DS1_v2 (1 vCPU, 3.5 GB)

Deploy as low priority ⓘ

NoYes

Use managed disks ⓘ

NoYes

+ Show advanced settings

AUTOSCALE

Autoscale ⓘ

DisabledEnabled

* Minimum number of VMs ⓘ

2

* Maximum number of VMs ⓘ

10

Scale out

* CPU threshold (%) ⓘ

80

* Number of VMs to increase by ⓘ

2

Scale in

* CPU threshold (%) ⓘ

30

* Number of VMs to decrease by ⓘ

4

Use the drop-down menus to select the answer choice that completes each statement based on the information presented in the graphic.
NOTE: Each correct selection is worth one point.

If Scale1 is utilized at 85 percent for six minutes, Scale1 will be running [answer choice].

2 virtual machines

4 virtual machines

6 virtual machines

8 virtual machines

10 virtual machines

If Scale1 is first utilized at 25 percent for six minutes, and then utilized at 50 percent for six minutes, Scale1 will be running [answer choice].

2 virtual machines

4 virtual machines

6 virtual machines

8 virtual machines

10 virtual machines

- A. Mastered
- B. Not Mastered

Answer: A

Explanation:

Box 1:
The Autoscale scale out rule increases the number of VMs by 2 if the CPU threshold is 80% or higher. The initial instance count is 4 and rises to 6 when the 2 extra instances of VMs are added.
Box 2:
The Autoscale scale in rule decreases the number of VMs by 4 if the CPU threshold is 30% or lower. The initial instance count is 4 and thus cannot be reduced to 0 as the minimum instances is set to 2. Instances are only added when the CPU threshold reaches 80%.
References:
<https://docs.microsoft.com/en-us/azure/azure-monitor/platform/autoscale-overview>
<https://docs.microsoft.com/en-us/azure/azure-monitor/platform/autoscale-best-practices> <https://docs.microsoft.com/en-us/azure/azure-monitor/platform/autoscale-common-scale-patterns>

NEW QUESTION 9

- (Exam Topic 2)
A company hosts virtual machines (VMs) in an on-premises datacenter and in Azure. The on-premises and Azure-based VMs communicate using ExpressRoute. The company wants to be able to continue regular operations if the ExpressRoute connection fails. Failover connections must use the Internet and must not require Multiprotocol Label Switching (MPLS) support.
You need to recommend a solution that provides continued operations. What should you recommend?

- A. Set up a second ExpressRoute connection.
- B. Increase the bandwidth of the existing ExpressRoute connection.
- C. Increase the bandwidth for the on-premises internet connection.

Guaranteed success with Our exam guides

visit - <https://www.certshared.com>

D. Set up a VPN connection.

Answer: D

Explanation:

References:

<https://docs.microsoft.com/en-us/azure/architecture/reference-architectures/hybrid-networking/expressroutevpn->

NEW QUESTION 10

- (Exam Topic 2)

You have 10 Azure virtual machines on a subnet named Subnet1. Subnet1 is on a virtual network named VNet1.

You plan to deploy a public Azure Standard Load Balancer named LB1 to the same Azure region as the 10 virtual machines.

You need to ensure that traffic from all the virtual machines to the internet flows through LB1. The solution must prevent the virtual machines from being accessible on the internet.

Which three actions should you perform? Each correct answer presents part of the solution.

NOTE: Each correct selection is worth one point.

- A. Add health probes to LB1.
- B. Add the network interfaces of the virtual machines to the backend pool of LB1.
- C. Add an inbound rule to LB1.
- D. Add an outbound rule to LB1.
- E. Associate a network security group (NSG) to Subnet1.
- F. Associate a user-defined route to Subnet1.

Answer: ABD

Explanation:

Reference:

<https://docs.microsoft.com/en-us/azure/load-balancer/tutorial-load-balancer-standard-manage-portal2>

NEW QUESTION 10

- (Exam Topic 2)

Note: This question is part of series of questions that present the same scenario. Each question in the series contains a unique solution that might meet the stated goals. Some question sets might have more than one correct solution, while others might not have a correct solution.

After you answer a question in this section, you will NOT be able to return to it. As a result, these questions will not appear in the review screen.

You have a server named Server1 that runs Windows Server 2019. Server1 is a container host. You are creating a Dockerfile to build a container image.

You need to add a file named File1.txt from Server1 to a folder named C:\Folder1 in the container image. Solution: You add the following line to the Dockerfile.

ADD File1.txt C:/Folder1/

You then build the container image. Does this meet the goal?

- A. Yes
- B. No

Answer: B

Explanation:

Copy is the correct command to copy a file to the container image. The ADD command can also be used. However, the root directory is specified as '/' and not as 'C:/'.

Reference:

https://docs.docker.com/develop/develop-images/dockerfile_best-practices/#add-or-copy <https://docs.docker.com/engine/reference/builder/>

NEW QUESTION 13

- (Exam Topic 2)

You have an Azure subscription that contains the storage accounts shown in the following table.

Name	Contains
storagecontoso1	A blob service and a table service
storagecontoso2	A blob service and a file service
storagecontoso3	A queue service
storagecontoso4	A file service and a queue service
storagecontoso5	A table service

You enable Azure Advanced Threat Protection (ATP) for all the storage accounts. You need to identify which storage accounts will generate Azure ATP alerts. Which two storage accounts should you identify? Each correct answer presents part of the solution. NOTE: Each correct selection is worth one point.

- A. storagecontoso1
- B. storagecontoso2
- C. storagecontoso3
- D. storagecontoso4
- E. storaacontoso5

Answer: AB

Explanation:

Advanced threat protection for Azure Storage is currently available only for Blob Storage.

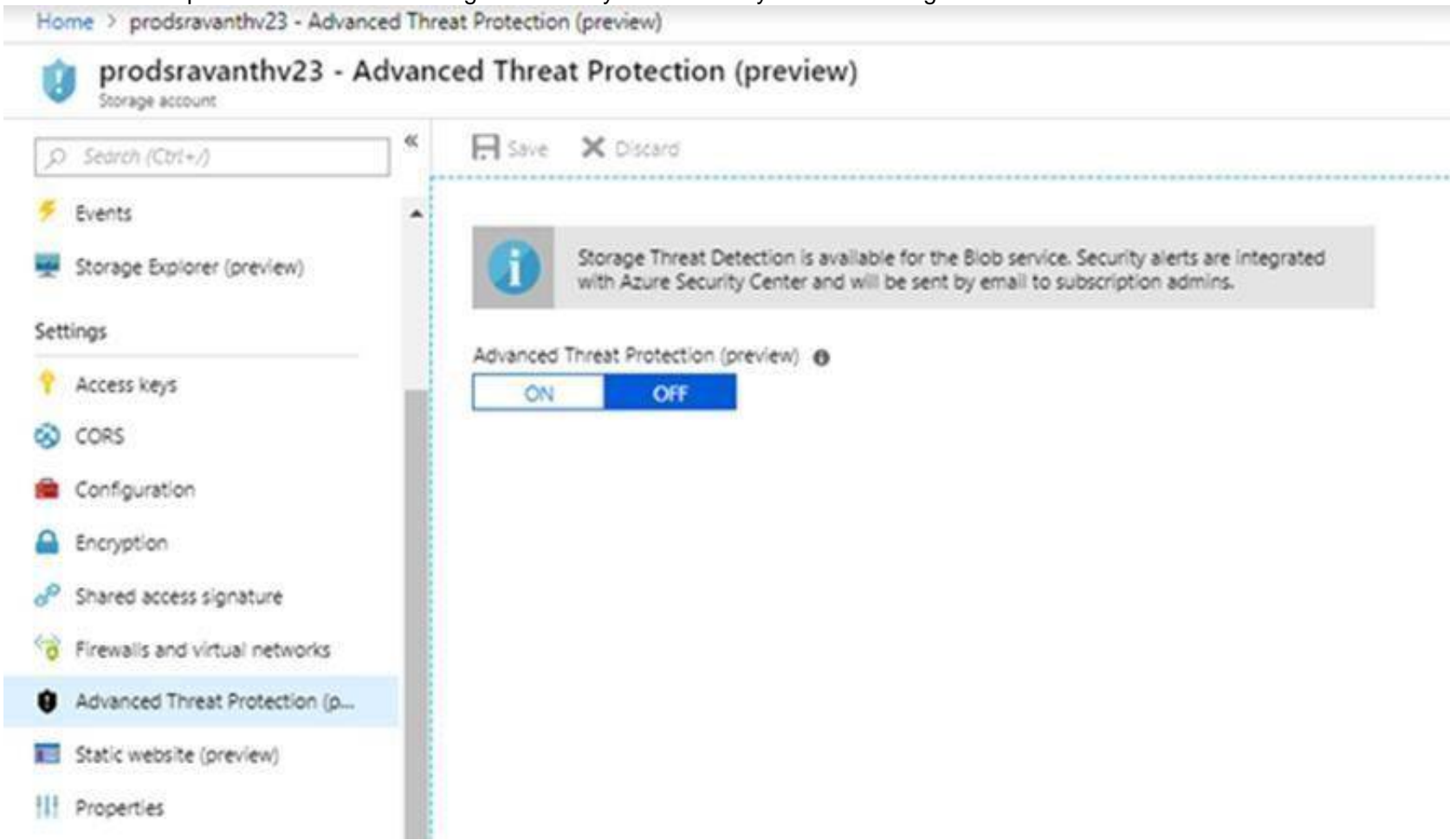

https://docs.microsoft.com/en-us/azure/storage/common/storage-advanced-threat-protection?tabs=azure-portal

NEW QUESTION 15

- (Exam Topic 2)

You have an Azure Active Directory (Azure AD) tenant named contoso.com. The tenant contains the users shown in the following table.

Name	Member of
User1	Group1
User2	Group2

The tenant contains computers that run Windows 10. The computers are configured as shown in the following table.

Name	Member of
Computer1	GroupA
Computer2	GroupA
Computer3	GroupB

You enable Enterprise State Roaming in contoso.com for Group1 and GroupA.
For each of the following statements, select Yes if the statement is true. Otherwise, select No.
NOTE: Each correct selection is worth one point.

Answer Area

Statements	Yes	No
If User1 modifies the desktop background of Computer1, User1 will see the changed background when signing in to Computer3.	<input type="radio"/>	<input type="radio"/>
If User2 modifies the desktop background of Computer1, User2 will see the changed background when signing in to Computer2.	<input type="radio"/>	<input type="radio"/>
If User1 modifies the desktop background of Computer3, User1 will see the changed background when signing in to Computer2.	<input type="radio"/>	<input type="radio"/>

- A. Mastered
- B. Not Mastered

Answer: A

Explanation:

Enterprise State Roaming provides users with a unified experience across their Windows devices and reduces the time needed for configuring a new device.

Box 1: Yes

Box 2: No

Box 3: Yes References:

https://docs.microsoft.com/en-us/azure/active-directory/devices/enterprise-state-roaming-overview

NEW QUESTION 16

- (Exam Topic 2)

You plan to automate the deployment of a virtual machine scale set that uses the Windows Server 2016 Datacenter image. You need to ensure that when the scale set virtual machines are provisioned, they have web server components installed. Which two actions should you perform? Each correct answer presents part of the solution. NOTE: Each correct selection is worth one point.

- A. Create a new virtual machine scale set in the Azure portal.
- B. Create an automation account.
- C. Upload a configuration script.
- D. Modify the extensionProfile section of the Azure Resource Manager template.
- E. Create an Azure policy.

Answer: AD

Explanation:

References:

<https://docs.microsoft.com/en-us/azure/virtual-machine-scale-sets/tutorial-install-apps-template>

NEW QUESTION 17

- (Exam Topic 2)

You plan to create an Azure Storage account named storage1 that will store blobs and be accessed by Azure Databricks. You need to ensure that you can set permissions for individual blobs by using Azure Active Directory (Azure AD) authentication. Which Advanced setting should you enable for storage1?

- A. Hierarchical namespace
- B. Large file shares
- C. Blob soft delete
- D. NFSv3

Answer: C

NEW QUESTION 22

- (Exam Topic 2)

You have an Azure subscription.

You have an on-premises virtual machine named VM1. The settings for VM1 are shown in the exhibit. (Click the Exhibit tab.)

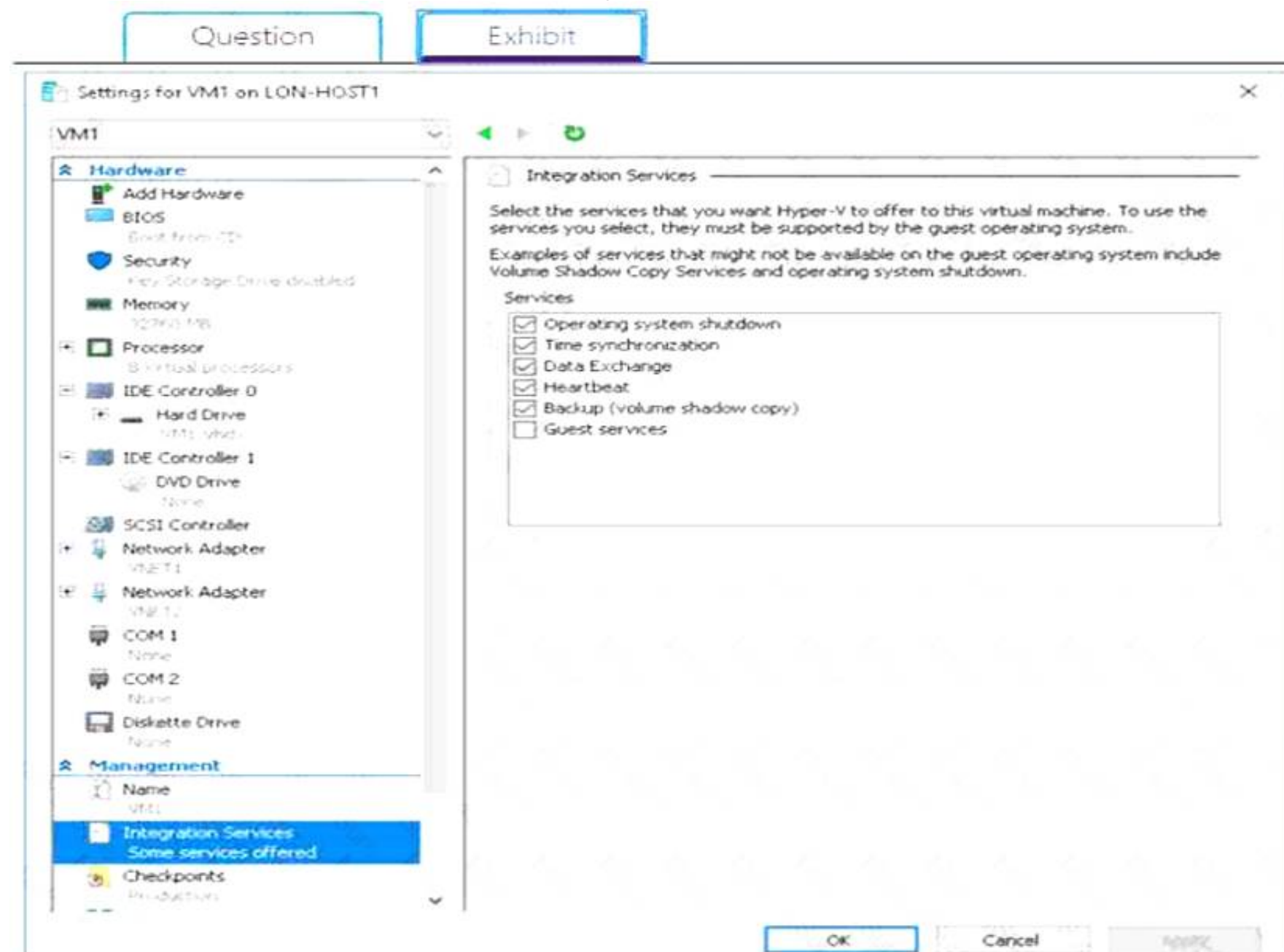

You need to ensure that you can use the disks attached to VM1 as a template for Azure virtual machines. What should you modify on VM1?

- A. the hard drive
- B. Integration Services
- C. the memory
- D. the network adapters
- E. the processor

Answer: A

Explanation:

From the exhibit we see that the disk is in the VHDX format.

Before you upload a Windows virtual machines (VM) from on-premises to Microsoft Azure, you must prepare the virtual hard disk (VHD or VHDX). Azure supports only generation 1 VMs that are in the VHD file format and have a fixed sized disk. The maximum size allowed for the VHD is 1,023 GB. You can convert a generation 1 VM from the VHDX file system to VHD and from a dynamically expanding disk to fixed-sized.

References:

<https://docs.microsoft.com/en-us/azure/virtual-machines/windows/prepare-for-upload-vhd-image?toc=azure-virtual-machines-windows-toc.json>

NEW QUESTION 25

- (Exam Topic 2)

You have an Azure subscription named Subscription1. Subscription1 contains the resources in the following table:

Name	Type
RG1	Resource group
RG2	Resource group
VNet1	Virtual network
VNet2	Virtual network

VNet1 is in RG1. VNet2 is in RG2. There is no connectivity between VNet1 and VNet2. An administrator named Admin1 creates an Azure virtual machine VM1 in RG1. VM1 uses a disk named Disk1 and connects to VNet1. Admin1 then installs a custom application in VM1.

You need to move the custom application to VNet2. The solution must minimize administrative effort. Which two actions should you perform? To answer, select the appropriate options in the answer area. NOTE: Each correct selection is worth one point.

First action:

	<input type="checkbox"/>
Create a network interface in RG2.	<input type="checkbox"/>
Detach a network interface.	<input type="checkbox"/>
Delete VM1.	<input type="checkbox"/>
Move a network interface to RG2.	<input type="checkbox"/>

Second action:

	<input type="checkbox"/>
Attach a network interface.	<input type="checkbox"/>
Create a network interface in RG2.	<input type="checkbox"/>
Create a new virtual machine.	<input type="checkbox"/>
Move VM1 to RG2.	<input type="checkbox"/>

- A. Mastered
- B. Not Mastered

Answer: A

Explanation:

We cannot just move a virtual machine between networks. What we need to do is identify the disk used by the VM, delete the VM itself while retaining the disk, and recreate the VM in the target virtual network and then attach the original disk to it.

Reference:

<https://blogs.technet.microsoft.com/canitpro/2014/06/16/step-by-step-move-a-vm-to-a-different-vnet-on-azure/>

<https://4sysops.com/archives/move-an-azure-vm-to-another-virtual-network-vnet/#migrate-an-azure-vm-between-virtual-networks>

NEW QUESTION 28

- (Exam Topic 2)

You have an Azure subscription that contains 100 virtual machines.

You have a set of Pester tests in PowerShell that validate the virtual machine environment.

You need to run the tests whenever there is an operating system update on the virtual machines. The solution must minimize implementation time and recurring costs.

D18912E1457D5D1DDCBD40AB3BF70D5D

Which three resources should you use to implement the tests? Each correct answer presents part of the solution.

NOTE: Each correct selection is worth one point.

- A. Azure Automation runbook
- B. an alert rule
- C. an Azure Monitor query
- D. a virtual machine that has network access to the 100 virtual machines
- E. an alert action group

Answer: ABE

Explanation:

<https://docs.microsoft.com/en-us/azure/automation/automation-create-alert-triggered-runbook> <https://techsnips.io/snips/how-to-create-and-test-azure-monitor-alerts/?page=13>

- (Exam Topic 2)

NOTE: Each correct selection is worth one point.

'Microsoft.Network/publicIPAddresses/'
'Microsoft.Network/virtualNetworks/'
'Microsoft.Network/networkInterfaces/'
'Microsoft.Network/virtualNetworks/subnets'
'Microsoft.Storage/storageAccounts/'

'Microsoft.Network/publicIPAddresses/'
'Microsoft.Network/virtualNetworks/'
'Microsoft.Network/networkInterfaces/'
'Microsoft.Network/virtualNetworks/subnets'
'Microsoft.Storage/storageAccounts/'

- Answer: A**

Within your template, the `dependsOn` element enables you to define one resource as a dependent on one or more resources. Its value can be a comma-separated list of resource names.

This resource is a virtual machine. It depends on two other resources: Microsoft.Storage/storageAccounts Microsoft.Network/networkInterfaces

The `dependsOn` element enables you to define one resource as a dependent on one or more resources. The resource depends on two other resources: `Microsoft.Network/publicIPAddresses` `Microsoft.Network/virtualNetworks`

```
"resources": [
  {
  },
  {
  },
  {
  },
  {
  },
  {
    "type": "Microsoft.Network/networkInterfaces",
    "name": "[variables('nicName')]",
    "location": "[parameters('location')]",
    "apiVersion": "2018-08-01",
    "dependsOn": [
      "[resourceId('Microsoft.Network/publicIPAddresses/', variables('publicIPAddressName'))]",
      "[resourceId('Microsoft.Network/virtualNetworks/', variables('virtualNetworkName'))]"
    ],
    "properties": {
      "ipConfigurations": [
        {
          "name": "ipconfig1",
          "properties": {
            "privateIPAllocationMethod": "Dynamic",
            "publicIPAddress": {
              "id": "[resourceId('Microsoft.Network/publicIPAddresses', variables('publicIPAddressName'))]"
            },
            "subnet": {
              "id": "[variables('subnetRef')]"
            }
          }
        }
      ]
    }
  }
],
}
```

References:

<https://docs.microsoft.com/en-us/azure/azure-resource-manager/resource-manager-tutorial-create-templates-with>

NEW QUESTION 34

- (Exam Topic 2)

You create and save an Azure Resource Manager template named Template1 that includes the following four sections.

```
{
  "$schema": "https://schema.management.azure.com/schemas/2015-01-01/deploymentTemplate.json#",
  "contentVersion": "1.0.0.0",
  "parameters": {
    "windowsOSVersion": {
      "defaultValue": "2019-Datacenter",
      "allowedValues": [
        "2012-Datacenter",
        "2012-R2-Datacenter",
        "2016-Datacenter",
        "2019-Datacenter"
      ]
    }
  },
}
```

Section2.

```
  "variables": {
    "windowsOSVersion": "2012-Datacenter",
```

Section3.

```
  },
  "resources": [
    {
      "type": "Microsoft.Compute/virtualMachines",
```

Section4.

```
    "storageProfile": {
      "imageReference": {
        "publisher": "MicrosoftWindowsServer",
        "offer": "WindowsServer",
        "sku": "2012-R2-Datacenter",
        "version": "latest"
      },
```

You deploy template1.

For each of the following statement, select Yes if the statement is true. Otherwise, select No. NOTE: Each correct selection is worth one point.

Answer Area

Statements	Yes	No
Windows Server 2012 R2 Datacenter will be deployed to the Azure virtual machine.	<input type="radio"/>	<input type="radio"/>
A custom image of Windows Server will be deployed.	<input type="radio"/>	<input type="radio"/>
During the deployment of Template1, an administrator will be prompted to select a version of Windows Server.	<input type="radio"/>	<input type="radio"/>

- A. Mastered
B. Not Mastered

Answer: A

Explanation:

Answer Area

Statements	Yes	No
Windows Server 2012 R2 Datacenter will be deployed to the Azure virtual machine.	<input checked="" type="radio"/>	<input type="radio"/>
A custom image of Windows Server will be deployed.	<input type="radio"/>	<input checked="" type="radio"/>
During the deployment of Template1, an administrator will be prompted to select a version of Windows Server.	<input type="radio"/>	<input checked="" type="radio"/>

NEW QUESTION 38

- (Exam Topic 2)

Note: This question is part of series of questions that present the same scenario. Each question in the series contains a unique solution that might meet the stated goals. Some question sets might have more than one correct solution, while others might not have a correct solution.

After you answer a question in this section, you will NOT be able to return to it. As a result, these questions will not appear in the review screen.

You have an Azure Active Directory (Azure AD) tenant named contoso.com.

A user named Admin1 attempts to create an access review from the Azure Active Directory admin center and discovers that the Access reviews settings are unavailable. Admin1 discovers that all the other Identity Governance settings are available.

Admin1 is assigned the User administrator, Compliance administrator, and Security administrator roles. You need to ensure that Admin1 can create access reviews in contoso.com.

Solution: You assign the Service administrator role to Admin1. Does this meet the goal?

- A. Yes
B. No

Answer: B

Explanation:

Instead use Azure AD Privileged Identity Management.

Note: PIM essentially helps you manage the who, what, when, where, and why for resources that you care about. Key features of PIM include:

➤ Conduct access reviews to ensure users still need roles References:

<https://docs.microsoft.com/en-us/azure/active-directory/privileged-identity-management/pim-configure>

NEW QUESTION 42

- (Exam Topic 2)

You have an Azure virtual machine named VM1 and an Azure Active Directory (Azure AD) tenant named adatum.com.

D18912E1457D5D1DDCBD40AB3BF70D5D

VM1 has the following settings:

- IP address: 10.10.0.10
➤ System-assigned managed identity: On

You need to create a script that will run from within VM1 to retrieve the authentication token of VM1. Which address should you use in the script?

- A. vm1.adatum.com.onmicrosoft.com
B. 169.254.169.254
C. 10.10.0.10
D. vm1.adatum.com

Answer: B

Explanation:

Your code that's

running on the VM can request a token from the Azure Instance Metadata Service identity endpoint, accessible only from within the VM:

<http://169.254.169.254/metadata/identity/oauth2/token>

Reference:

<https://docs.microsoft.com/en-us/azure/active-directory/managed-identities-azure-resources/overview>

NEW QUESTION 47

- (Exam Topic 2)

Note: This question is part of series of questions that present the same scenario. Each question in the series contains a unique solution that might meet the stated goals. Some question sets might have more than one correct solution, while others might not have a correct solution.

After you answer a question in this section, you will NOT be able to return to it. As a result, these questions will not appear in the review screen.

You have an Azure Active Directory (Azure AD) tenant that contains a group named Group1. You need to enable multi-factor authentication (MFA) for the users in Group1 only.

Solution: From Multi-Factor Authentication, you select Bulk update, and you provide a CSV file that contains the members of Group1.

Does this meet the goal?

- A. Yes
- B. No

Answer: B

Explanation:

We should use a Conditional Access policy.

Note: There are two ways to secure user sign-in events by requiring multi-factor authentication in Azure AD. The first, and preferred, option is to set up a Conditional Access policy that requires multi-factor authentication under certain conditions. The second option is to enable each user for Azure Multi-Factor Authentication. When users are enabled individually, they perform multi-factor authentication each time they sign in (with some exceptions, such as when they sign in from trusted IP addresses or when the remembered devices feature is turned on).

Enabling Azure Multi-Factor Authentication using Conditional Access policies is the recommended approach. Changing user states is no longer recommended unless your licenses don't include Conditional Access as it requires users to perform MFA every time they sign in.

Reference:

<https://docs.microsoft.com/en-us/azure/active-directory/authentication/howto-mfa-userstates>

NEW QUESTION 48

- (Exam Topic 2)

You create a container image named Image1 on a developer workstation.

You plan to create an Azure Web App for Containers named WebAppContainer that will use Image1. You need to upload Image1 to Azure. The solution must ensure that WebAppContainer can use Image1. To which storage type should you upload Image1?

- A. Azure Container Registry
- B. an Azure Storage account that contains a blob container
- C. an Azure Storage account that contains a file share
- D. Azure Container Instances

Answer: A

Explanation:

Configure registry credentials in web app.

App Service needs information about your registry and image to pull the private image. In the Azure portal, go to Container settings from the web app and update the Image source, Registry and save.

References:

<https://docs.microsoft.com/en-us/azure/devops/pipelines/targets/webapp-on-container-linux>

NEW QUESTION 50

- (Exam Topic 2)

You have an Azure logic app named App1 and an Azure Service Bus queue named Queue1.

You need to ensure that App1 can read messages from Queue1. App1 must authenticate by using Azure Active Directory (Azure AD).

What should you do? To answer, select the appropriate options in the answer area. NOTE: Each correct selection is worth one point.

On App1:

- Add a logic app step
- Configure Access control (IAM)
- Regenerate the access key
- Turn on the managed identity

On Queue1:

- Add a read-only lock
- Add a shared access policy
- Configure Access control (IAM)
- Modify the properties

- A. Mastered
- B. Not Mastered

Answer: A

Explanation:

On App1: Turn on the managed identity

To use Service Bus with managed identities, you need to assign the identity the role and the appropriate scope. The procedure in this section uses a simple application that runs under a managed identity and accesses Service Bus resources.

Once the application is created, follow these steps:

- > Go to Settings and select Identity.
- > Select the Status to be On.
- > Select Save to save the setting.

On Queue1: Configure Access Control (IAM)
Azure Active Directory (Azure AD) authorizes access rights to secured resources through role-based access control (RBAC). Azure Service Bus defines a set of built-in RBAC roles that encompass common sets of permissions used to access Service Bus entities and you can also define custom roles for accessing the data. Assign RBAC roles using the Azure portal
In the Azure portal, navigate to your Service Bus namespace. Select Access Control (IAM) on the left menu to display access control settings for the namespace. If you need to create a Service Bus namespace.
Select the Role assignments tab to see the list of role assignments. Select the Add button on the toolbar and then select Add role assignment.
Reference:
<https://docs.microsoft.com/en-us/azure/service-bus-messaging/authenticate-application> <https://docs.microsoft.com/en-us/azure/service-bus-messaging/service-bus-managed-service-identity>

NEW QUESTION 55

- (Exam Topic 2)
Your company hosts multiple websites by using Azure virtual machine scale sets (VMSS) that run Internet Information Server (IIS). All network communications must be secured by using end to end Secure Socket Layer (SSL) encryption. User sessions must be routed to the same server by using cookie-based session affinity.
The image shown depicts the network traffic flow for the websites to the VMSS.

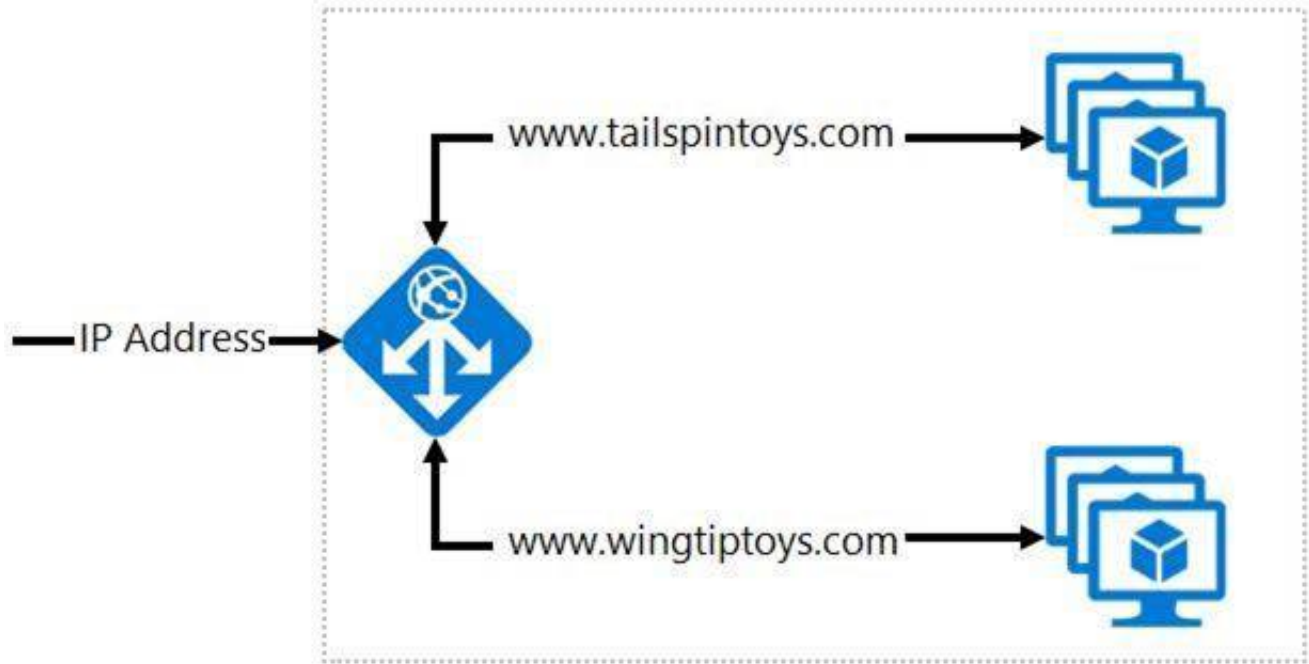

Use the drop-down menus to select the answer choice that answers each question.
NOTE: Each correct selection is worth one point.

Which Azure solution should you create to route the web application traffic to the VMSS?

	▼
Azure VPN Gateway	
Azure Application Gateway	
Azure ExpressRoute	
Azure Network Watcher	

What should you configure to make sure web traffic arrives at the appropriate server in the VMSS?

	▼
Routing rules and backend listeners	
CNAME and A records	
Routing method and DNS time to live (TTL)	
Path-based redirection and WebSockets	

- A. Mastered
- B. Not Mastered

Answer: A

Explanation:
Box 1: Azure Application Gateway
You can create an application gateway with URL path-based redirection using Azure PowerShell. Box 2: Path-based redirection and Websockets
Reference:
<https://docs.microsoft.com/bs-latn-ba/azure//application-gateway/tutorial-url-redirect-powershell>

NEW QUESTION 60

- (Exam Topic 2)
Your company plans to develop an application that will use a NoSQL database. The database will be used to store transactions and customer information by using JSON documents. Which two Azure Cosmos DB APIs can developers use for the application? Each correct answer presents a complete solution. NOTE: Each correct selection is worth one point.

- A. Cassandra
- B. Gremlin (graph)
- C. MongoDB
- D. Azure Table
- E. Core (SQL)

Answer: DE

NEW QUESTION 63

- (Exam Topic 2)

Your company has an Azure Container Registry named Registry1.

You have an Azure virtual machine named Server1 that runs Windows Server 2019. From Server1, you create a container image named image1.

You need to add image1 to Registry1.

Which command should you run on Server1? To answer, select the appropriate options in the answer area.

NOTE: Each correct selection is worth one point.

push

/image1

docker

AzCopy

Robocopy

esentutl

registry1.azurecr.io

registry1.onmicrosoft.com

https://registry1.onmicrosoft.com

\\registry1.blob.core.windows.net

- A. Mastered
- B. Not Mastered

Answer: A

Explanation:

An Azure container registry stores and manages private Docker container images, similar to the way Docker Hub stores public Docker images. You can use the Docker command-line interface (Docker CLI) for login, push, pull, and other operations on your container registry.

Reference:

<https://docs.microsoft.com/en-us/azure/container-registry/container-registry-get-started-docker-cli> <https://docs.docker.com/engine/reference/commandline/push/>

NEW QUESTION 68

- (Exam Topic 2)

A company plans to use third-party application software to perform complex data analysis processes. The software will use up to 500 identical virtual machines (VMs) based on an Azure Marketplace VM image.

You need to design the infrastructure for the third-party application server. The solution must meet the following requirements:

- > The number of VMs that are running at any given point in time must change when the user workload changes.
- > When a new version of the application is available in Azure Marketplace it must be deployed without causing application downtime.
- > Use VM scale sets.
- > Minimize the need for ongoing maintenance.

Which two technologies should you recommend? Each correct answer presents part of the solution.

NOTE: Each correct selection is worth one point.

- A. single storage account
- B. autoscale
- C. single placement group
- D. managed disks

Answer: BD

Explanation:

Introduction to Azure managed disks

<https://docs.microsoft.com/en-us/azure/virtual-machines/windows/managed-disks-overview> "Using managed disks, you can create up to 50,000 VM disks of a type in a subscription per region, allowing you to create thousands of VMs in a single subscription. This feature also further increases the scalability of virtual machine scale sets by allowing you to create up to 1,000 VMs in a virtual machine scale set using a Marketplace image."

NEW QUESTION 73

- (Exam Topic 2)

You have an Azure subscription that contains two virtual networks named VNet1 and VNet2. Virtual machines connect to the virtual networks.

The virtual networks have the address spaces and the subnets configured as shown in the following table.

Virtual network	Address space	Subnet	Peering
VNet1	10.1.0.0/16	10.1.0.0/24 10.1.1.0/26	VNet2
VNet2	10.2.0.0/26	10.2.0.0/24	VNet1

You need to add the address space of 10.33.0.0/16 to VNet1. The solution must ensure that the hosts on VNet1 and VNet2 can communicate.

Which three actions should you perform in sequence? To answer, move the appropriate actions from the list of actions to the answer area and arrange them in the correct order.

Actions	Answer Area
Remove peering between VNet1 and VNet2.	
Recreate peering between VNet1 and VNet2.	
On the peering connection in VNet1, allow gateway transit.	
Add the 10.33.0.0/16 address space to VNet1.	
On the peering conenction in VNet2, allow gateway transit.	
Create a new virtual network named VNet1.	
Remove VNet1.	

- A. Mastered
- B. Not Mastered

Answer: A

Explanation:

Step 1: Remove peering between Vnet1 and VNet2.
You can't add address ranges to, or delete address ranges from a virtual network's address space once a virtual network is peered with another virtual network. To add or remove address ranges, delete the peering, add or remove the address ranges, then re-create the peering. Step 2: Add the 10.44.0.0/16 address space to VNet1. Step 3: Recreate peering between VNet1 and VNet2 References:
<https://docs.microsoft.com/en-us/azure/virtual-network/virtual-network-manage-peering>

NEW QUESTION 78

- (Exam Topic 2)
You have Azure virtual machines deployed to three Azure regions. Each region contains a single virtual network that has four virtual machines on the same subnet. Each virtual machine runs an application named App1. App1 is accessible by using HTTPS. Currently, the virtual machines are inaccessible from the internet.
You need to use Azure Front Door to load balance requests for App1 across all the virtual machines. Which additional Azure service should you provision?

- A. a public Azure Load Balancer
- B. Azure Traffic Manager
- C. an internal Azure Load Balancer
- D. Azure Private Link

Answer: A

NEW QUESTION 80

.....

Thank You for Trying Our Product

We offer two products:

1st - We have Practice Tests Software with Actual Exam Questions

2nd - Questions and Answers in PDF Format

AZ-303 Practice Exam Features:

- * AZ-303 Questions and Answers Updated Frequently
- * AZ-303 Practice Questions Verified by Expert Senior Certified Staff
- * AZ-303 Most Realistic Questions that Guarantee you a Pass on Your FirstTry
- * AZ-303 Practice Test Questions in Multiple Choice Formats and Updatesfor 1 Year

100% Actual & Verified — Instant Download, Please Click
[Order The AZ-303 Practice Test Here](#)