

# CompTIA

## Exam Questions JK0-023

CompTIA Network+ certification



#### NEW QUESTION 1

- (Exam Topic 1)

For which of the following reasons could a single server's NIC transmit packets from multiple MAC address sources?

- A. The server contains several virtual machines and the MAC addresses are from the virtual machines.
- B. The server is hosting a web server and the MAC addresses are from connected browsers.
- C. The server is hosting a proxy server and the MAC addresses are from the connected clients.
- D. The server NIC is starting to fail and should be replaced.

**Answer:** A

#### NEW QUESTION 2

- (Exam Topic 1)

Which of the following differentiates a layer 3 switch from a layer 2 switch?

- A. Routing
- B. Bridging
- C. Switching
- D. Repeating

**Answer:** A

#### NEW QUESTION 3

- (Exam Topic 1)

Which of the following protocols are used to provide accurate time to network devices?

- A. SMTP
- B. FTP
- C. TLS
- D. NTP

**Answer:** D

#### NEW QUESTION 4

- (Exam Topic 1)

Which of the following has the LEAST amount of collisions in a domain?

- A. Bridge
- B. Hub
- C. Repeater
- D. Switch

**Answer:** D

#### NEW QUESTION 5

- (Exam Topic 1)

Which of the following DNS record types provides the hostname to IP address mapping?

- A. A record
- B. NS record
- C. CNAME record
- D. MX record

**Answer:** A

#### NEW QUESTION 6

- (Exam Topic 1)

Which of the following describes the amount of time it takes for a packet to transmit from one switch to another?

- A. Hop count
- B. Latency
- C. MTU limit
- D. Distance vector

**Answer:** B

#### NEW QUESTION 7

- (Exam Topic 1)

The TCP/IP application layer contains which of the following OSI layers?

- A. Layers 1,5,6,7
- B. Layers 4,7
- C. Layers 5,6,7
- D. Layer 7

**Answer:** C

**NEW QUESTION 8**

- (Exam Topic 1)

Which of the following protocols is the BEST choice for retrieving email on multiple devices?

- A. IMAP4
- B. SMTP
- C. FTP
- D. SNMPv3

**Answer:** A

**NEW QUESTION 9**

- (Exam Topic 1)

A technician has resolved a ticket to fix a user's printer and has verified that the user is able to print with no issues. Which of the following action steps should the technician perform FIRST?

- A. Document findings and outcomes
- B. Establish a theory of probable cause
- C. Upgrade the printer drivers
- D. Close out the service ticket

**Answer:** A

**NEW QUESTION 10**

- (Exam Topic 1)

Which of the following subnet masks would allow for 192.168.0.3 and 192.168.0.240 to be in the same subnet?

- A. 255.255.255.0
- B. 255.255.255.128
- C. 255.255.255.192
- D. 255.255.255.248

**Answer:** A

**NEW QUESTION 10**

- (Exam Topic 1)

Which of the following DNS records would a web browser access to determine the IP address of an Internet web page?

- A. CNAME
- B. A
- C. MX
- D. PTR

**Answer:** B

**NEW QUESTION 14**

- (Exam Topic 1)

An IP address is encapsulated at which of the following layers of the OSI model?

- A. Transport
- B. Data link
- C. Network
- D. Application

**Answer:** C

**NEW QUESTION 16**

- (Exam Topic 1)

Which of the following protocols would the network administrator use to protect login credentials when accessing a router terminal session?

- A. SCP
- B. SNMPv3
- C. SSL
- D. SSH

**Answer:** D

**NEW QUESTION 20**

- (Exam Topic 1)

Which of the following would Kim, a technician, use in voice over IP communications?

- A. SNTP
- B. SCP

- C. SMTP
- D. SIP

**Answer:** D

#### NEW QUESTION 21

- (Exam Topic 1)

Which of the following represents the physical address of a network access card?

- A. FF01:D2:C4:87::11
- B. 00-30-48-83-9B-C8
- C. 08-9D-35-22-L2-34-FF-21
- D. 2D1A:C3:0:1C3B:2AD:FF:FEFE:9D3A

**Answer:** B

#### NEW QUESTION 23

- (Exam Topic 1)

Which of the following protocols does DNS utilize on port 53?

- A. TCP
- B. FTP
- C. RTP
- D. ICMP

**Answer:** A

#### NEW QUESTION 25

- (Exam Topic 1)

Which of the following protocols is used to send time synchronization updates on a given network?

- A. NTP
- B. POP3
- C. DNS
- D. IMAP

**Answer:** A

#### NEW QUESTION 29

- (Exam Topic 1)

After a new firewall is installed, users report that they do not have connectivity to the Internet. The output of the ipconfig command shows an IP address of 169.254.0.101. Which of the following ports would need to be opened on the firewall to allow the users to obtain an IP address? (Select TWO).

- A. UDP 53
- B. UDP 67
- C. UDP 68
- D. TCP 53
- E. TCP 67
- F. TCP 68

**Answer:** BC

#### NEW QUESTION 30

- (Exam Topic 1)

Which of the following protocols would Lisa, a technician, use to disable switch ports automatically to prevent switching loops?

- A. RIP
- B. OSPF
- C. STP
- D. EGP

**Answer:** C

#### NEW QUESTION 34

- (Exam Topic 1)

After the technician has established a theory of probable cause of a user reported problem, which of the following should the technician do NEXT in the troubleshooting process?

- A. Implement the solution to the problem.
- B. Establish a plan of action.
- C. Identify the problem.
- D. Implement preventative measures.

**Answer:** B

#### NEW QUESTION 35

- (Exam Topic 1)

Which of the following uses port 23 by default?

- A. TELNET
- B. IMAP
- C. FTP
- D. SNMP

**Answer:** A

#### **NEW QUESTION 39**

- (Exam Topic 1)

An administrator has created several virtual machines on the same host server and requires them to each be on separate VLANs. Which of the following should the administrator configure to meet this goal?

- A. Set the VLAN preferences on the host's NIC
- B. Create each VLAN on the host's virtual switch
- C. Change the virtual machine NIC settings from private to bridged
- D. Create each VLAN on the host's gateway router

**Answer:** B

#### **NEW QUESTION 41**

- (Exam Topic 1)

At which layer of the OSI and TCP/IP model would HTTP and FTP be found?

- A. Application
- B. Network
- C. Session
- D. Data Link

**Answer:** A

#### **NEW QUESTION 43**

- (Exam Topic 1)

Which of the following is an invalid MAC address?

- A. AA:CE:58:FD:90:08
- B. 44:98:3E:F8:33:23
- C. 56:AD:BX:89:55:54
- D. 94:9E:FE:EE:8C:DF

**Answer:** C

#### **NEW QUESTION 46**

- (Exam Topic 1)

Which of the following is the broadcast address for a network defined as 192.168.0.0/24?

- A. 192.168.0.255
- B. 192.168.0.1
- C. 192.168.0.0
- D. 192.168.0.253

**Answer:** A

#### **NEW QUESTION 49**

- (Exam Topic 1)

Which of the following is considered a routing metric?

- A. Hop count
- B. QoS
- C. Subnet size
- D. IP address

**Answer:** A

#### **NEW QUESTION 50**

- (Exam Topic 1)

Which of the following uses distance vector algorithms to determine the BEST network route to a destination address?

- A. IS-IS
- B. OSPF
- C. BGP
- D. RIP

**Answer:** D

#### NEW QUESTION 54

- (Exam Topic 1)

Joe has a small office and is looking to replace his phone system with a lower cost solution that requires minimal in-house support. Which of the following is the BEST choice?

- A. Wide Area Network
- B. NAT
- C. Virtual PBX
- D. Virtual LAN

**Answer:** C

#### NEW QUESTION 57

- (Exam Topic 1)

A user is having difficulty connecting a laptop to the company's network via a wireless connection. The user can connect to the network via a wired NIC. The technician thinks the user's wireless NIC has failed. Which of the following network troubleshooting methodology steps should the technician perform NEXT?

- A. Test the theory to determine the cause.
- B. Implement the solution or escalate as necessary.
- C. Establish a plan of action to resolve the problem.
- D. Re-establish new theory or escalate.

**Answer:** A

#### NEW QUESTION 59

- (Exam Topic 1)

Which of the following network protocols is used to resolve FQDNs to IP addresses?

- A. DNS
- B. FTP
- C. DHCP
- D. APIPA

**Answer:** A

#### NEW QUESTION 64

- (Exam Topic 1)

Which of the following port numbers is used for SNMP?

- A. 61
- B. 151
- C. 161
- D. 1611

**Answer:** C

#### NEW QUESTION 68

- (Exam Topic 1)

Joe, a technician, has identified a problem, established and confirmed a theory, and has attempted to resolve the problem. Joe, however, does not appear to have the rights to make the needed changes. Which of the following should he do NEXT?

- A. Re-establish a new theory.
- B. Gather more information.
- C. Establish a plan of action.
- D. Escalate the problem.

**Answer:** D

#### NEW QUESTION 71

- (Exam Topic 1)

Layers 5, 6, and 7 from the OSI model correspond to which of the following layers of the TCP/IP model?

- A. Transport
- B. Application
- C. Internet
- D. Network Interface

**Answer:** B

#### NEW QUESTION 74

- (Exam Topic 1)

A company's database software runs in the cloud. The device hosting the software is an example of which of the following?

- A. Virtual server
- B. Virtual switch
- C. Virtual desktop
- D. Virtual PBX

**Answer:** A

**NEW QUESTION 75**

- (Exam Topic 1)

Which of the following exterior routing protocols uses an algorithm to determine the quickest route to a destination?

- A. RIP
- B. OSPF
- C. BGP
- D. RIPv2

**Answer:** C

**NEW QUESTION 80**

- (Exam Topic 1)

Which of the following reside at a minimum of Layer 3 of the OSI model? (Select TWO).

- A. Hub
- B. Switch
- C. MAC address
- D. IP address
- E. Router

**Answer:** DE

**NEW QUESTION 85**

- (Exam Topic 1)

Which of the following BEST describes how a layer 2 switch functions?

- A. Switches packets within the same subnet based on MAC addresses
- B. Switches packets between different subnets based on IP addresses
- C. Switches packets between different subnets based on MAC addresses
- D. Switches packets within the same subnet based on IP addresses

**Answer:** A

**NEW QUESTION 86**

- (Exam Topic 1)

A user reports intermittent network connectivity from their desktop PC. A technician determines the cause to be a bad wall jack and fixes the jack. Which of the following should the technician do NEXT?

- A. Test the theory
- B. Question the user
- C. Document the outcome
- D. Verify functionality

**Answer:** D

**NEW QUESTION 89**

- (Exam Topic 1)

The address 6FFE:FFFF:0000:2F3B:04AC:00FF:FEFE:5C4A is an example of which of the following?

- A. APIPA
- B. MAC
- C. IPv4
- D. IPv6

**Answer:** D

**NEW QUESTION 91**

- (Exam Topic 1)

A technician finds that the network card is no longer functioning. At which of the following OSI layers is the problem occurring?

- A. Layer 1
- B. Layer 3
- C. Layer 5
- D. Layer 7

**Answer:** A

**NEW QUESTION 93**

- (Exam Topic 1)

Lisa, a network technician, has determined that the initial theory of probable cause was incorrect. Which of the following would be the NEXT step in the troubleshooting process?

- A. Implement the solution
- B. Establish a plan
- C. Document findings
- D. Escalate the issue

**Answer:** D

**NEW QUESTION 96**

- (Exam Topic 2)

Which of the following fiber types is MOST often used indoors?

- A. Plenum
- B. Modal conditioning
- C. Multimode
- D. Singlemode

**Answer:** C

**NEW QUESTION 101**

- (Exam Topic 2)

Which of the following is a packet switching WAN technology?

- A. Frame relay
- B. T1
- C. Asynchronous transfer mode
- D. ISDN

**Answer:** A

**NEW QUESTION 103**

- (Exam Topic 2)

Which of the following technologies is used on cellular networks?

- A. Ethernet
- B. CDMA
- C. CSMA/CA
- D. POTS

**Answer:** B

**NEW QUESTION 107**

- (Exam Topic 2)

Which of the following network topologies is MOST likely used in remote access VPN?

- A. Point to Point
- B. Bus
- C. Ring
- D. Mesh

**Answer:** A

**NEW QUESTION 111**

- (Exam Topic 2)

Jeff, an administrator, is using a punch-down tool to connect a cable. To which of the following is Jeff MOST likely connecting?

- A. A 110 block
- B. A demarc
- C. A DB-9
- D. A smart jack

**Answer:** A

**NEW QUESTION 113**

- (Exam Topic 2)

Which of the following would be used to connect a singlemode fiber cable to a CAT6 connection?

- A. Media converter
- B. T1-crossover
- C. Multimode cable
- D. Coaxial

**Answer:** A

**NEW QUESTION 117**

- (Exam Topic 2)

A technician is trying to add another switch to the network with multiple VLANs. Which of the following should the technician configure on the interface to allow multiple VLANs?

- A. Mirroring
- B. Trunking
- C. Authenticating
- D. Bonding

**Answer:** B

#### NEW QUESTION 118

- (Exam Topic 2)

Which of the following is the FASTEST Ethernet technology?

- A. 10GBaseSR
- B. 10BaseT
- C. 100BaseFX
- D. 1000BaseT

**Answer:** A

#### NEW QUESTION 119

- (Exam Topic 2)

After a new user moves furniture into a cubicle, the computer does not connect to the network any longer. Which of the following would be the MOST likely reason? (Select TWO).

- A. Bad Ethernet switch port
- B. TX/RX reversed
- C. Bad connectors
- D. Bad patch cable
- E. Mismatched MTU

**Answer:** CD

#### NEW QUESTION 120

- (Exam Topic 2)

In a small office environment, one computer is set up to provide Internet access to three other computers that are not interconnected. This is an example of which of the following topology types?

- A. Peer-to-peer
- B. Point-to-multipoint
- C. Hybrid
- D. Point-to-point

**Answer:** B

#### NEW QUESTION 123

- (Exam Topic 2)

A technician notices a newly installed CAT5 cable is longer than the standard maximum length. Which of the following problems would this MOST likely cause?

- A. Split cable
- B. EMI
- C. DB loss
- D. Crosstalk

**Answer:** C

#### NEW QUESTION 128

- (Exam Topic 2)

Kim, a technician, is asked to run new cabling for an office that is 350 feet (107 meters) away from the networking equipment. The type of cable being run is CAT6. Kim purchases and installs a 500 foot (152 meters) CAT6 cable, but after installation, notices a weak signal between the office and the networking equipment. Which of the following would have been the BEST to install instead of the CAT6 cable?

- A. Install two CAT6 cables with a repeater.
- B. Install a 500 foot (152 meter) CAT5 cable.
- C. Install a 500 foot (152 meter) CAT5e cable.
- D. Install three CAT6 cables with a repeater.

**Answer:** A

#### NEW QUESTION 132

- (Exam Topic 2)

Which of the following cable types would have the LEAST amount of EMI?

- A. CAT3
- B. CAT5
- C. STP CAT6

D. Plenum CAT6

**Answer:** C

**NEW QUESTION 133**

- (Exam Topic 2)

Which of the following would the telecommunications carrier use to segregate customer traffic over long fiber links?

- A. VLAN
- B. MPLS
- C. VPN
- D. PSTN

**Answer:** B

**NEW QUESTION 137**

- (Exam Topic 2)

CAT6 has how many twisted copper pairs?

- A. 2
- B. 4
- C. 6
- D. 8
- E. 16

**Answer:** B

**NEW QUESTION 142**

- (Exam Topic 2)

Which of the following is used for SONET connections and requires a wavelength of 1310nm?

- A. 10GBASECX4
- B. 10GBASELX4
- C. 10GBASELW
- D. 10GBASESR

**Answer:** C

**NEW QUESTION 145**

- (Exam Topic 2)

The ISP needs to terminate the WAN connection. The connection should be located in the network server room where the company LAN equipment resides. Which of the following identifies the location?

- A. Smart jack
- B. MDF
- C. VPN
- D. 66 block

**Answer:** B

**NEW QUESTION 150**

- (Exam Topic 2)

Which of the following WAN technologies utilizes an optical SONET carrier and has a maximum bandwidth of 155.54Mbps?

- A. DS3
- B. E3
- C. OC3
- D. T3

**Answer:** C

**NEW QUESTION 153**

- (Exam Topic 2)

A user would like to connect two laptops together and transfer files via the Ethernet ports. Which of the following should MOST likely be provided to the user to accomplish this?

- A. Crossover
- B. Rollover
- C. Loopback
- D. Straight cable

**Answer:** A

**NEW QUESTION 158**

- (Exam Topic 2)

Which of the following are standard fiber cable connector types? (Select TWO).

- A. RJ-11
- B. F-connector
- C. MTRJ
- D. DB-9
- E. ST

**Answer:** CE

#### NEW QUESTION 160

- (Exam Topic 2)

Which of the following is an example of a CSMA/CD medium?

- A. WEP
- B. SONET
- C. Token ring
- D. Ethernet

**Answer:** D

#### NEW QUESTION 161

- (Exam Topic 2)

An organization currently has CAT5e cabling throughout its office. Kim, the network technician, is troubleshooting a new CAT6 run that supports network traffic, but does not meet specification when tested with a TDR. Which of the following is MOST likely the cause?

- A. Improper grounding
- B. TXRX reversed
- C. Incorrect termination
- D. Outdated NIC drivers

**Answer:** C

#### NEW QUESTION 166

- (Exam Topic 2)

Which of the following technologies can cause interference for 802.11g?

- A. RADAR
- B. 802.11a
- C. IrDA
- D. Bluetooth

**Answer:** D

#### NEW QUESTION 170

- (Exam Topic 2)

Which of the following cable types is required to run through an air duct?

- A. UTP
- B. Fiber
- C. PVC
- D. Plenum

**Answer:** D

#### NEW QUESTION 174

- (Exam Topic 2)

Kim, a technician, is connecting a new desktop computer to a switch. She was only able to locate one cable in the office for the installation. The wires at each end are color coded as follows:

End A: orange-white, orange, green-white, blue, blue-white, green, brown-white, brown End B: green-white, green, orange-white, blue, blue-white, orange, brown-white, brown Which of the following should Kim do to complete the installation?

- A. Re-end the provided cable, keeping the wiring the same.
- B. Use the provided cable.
- C. Purchase a crossover cable.
- D. Purchase a straight-through cable.

**Answer:** D

#### NEW QUESTION 178

- (Exam Topic 2)

The location where the Telco wiring stops and the clients wiring starts is known as the:

- A. MDF.
- B. demarc.
- C. IDF.
- D. 66 block.

**Answer:** B

**NEW QUESTION 180**

- (Exam Topic 2)

An administrator has added four switches to a campus network. The switch in wiring closet A is only connected to the switch in wiring closet C. The switch in wiring closet B is connected to the switch in wiring closet C as well as wiring closet D. The switch in wiring closet D is only connected to the switch in wiring closet B. Which of the following topologies is represented in this design?

- A. Ring
- B. Star
- C. Bus
- D. Mesh

**Answer:** C

**NEW QUESTION 181**

- (Exam Topic 2)

CAT6 Ethernet cabling has a rated maximum transmission capability of:

- A. 10Mbps
- B. 100Mbps
- C. 20,000Mbps
- D. 10,000Mbps

**Answer:** D

**NEW QUESTION 186**

- (Exam Topic 2)

A technician is tasked with replacing some older RS-232 serial printers. Which of the following ports would the technician most likely find on these printers?

- A. BNC
- B. DB-9
- C. LC
- D. RJ-11

**Answer:** B

**NEW QUESTION 189**

- (Exam Topic 2)

Which of the following is similar to MIMO?

- A. WPA
- B. SSID
- C. PoE
- D. Diversity

**Answer:** D

**NEW QUESTION 192**

- (Exam Topic 2)

Which of the following is the MAXIMUM distance a single 1000BaseT segment can cover?

- A. 100 kilometers (62 miles)
- B. 10 kilometers (6 miles)
- C. 1000 meters (3281 feet)
- D. 100 meters (328 feet)

**Answer:** D

**NEW QUESTION 193**

- (Exam Topic 2)

Which of the following uses copper wiring?

- A. 10GBaseER
- B. 10GBaseLW
- C. 100BaseFX
- D. 1000BaseT

**Answer:** D

**NEW QUESTION 198**

- (Exam Topic 3)

A network technician is concerned that a user is utilizing a company PC for file sharing and using a large amount of the bandwidth. Which of the following tools can be used to identify the IP and MAC address of the user's PC?

- A. System log
- B. History log
- C. Network sniffer
- D. Nslookup

**Answer:** C

**NEW QUESTION 201**

- (Exam Topic 3)

Which of the following would MOST likely be used by a network administrator to test DNS resolution?

- A. dig
- B. ipconfig
- C. netstat
- D. nbtstat

**Answer:** A

**NEW QUESTION 203**

- (Exam Topic 3)

The selection of the correct punch down tool to use depends on which of the following?

- A. Connector type
- B. Demarcation point location
- C. Block type
- D. Switch location

**Answer:** C

**NEW QUESTION 208**

- (Exam Topic 3)

Which of the following BEST describes a load balancer?

- A. A device that splits traffic between multiple nodes of a clustered service.
- B. A device that allows multiple computers to access the internet through a single public IP address.
- C. A device that filters internet content based on rules and ACLs.
- D. A device that separates users onto separate WAPs for even distribution.

**Answer:** A

**NEW QUESTION 212**

- (Exam Topic 3)

A technician suspects invalid information in the local DNS cache of a workstation. Which of the following commands can be used to clear this?

- A. nslookup
- B. ifconfig
- C. dig
- D. ipconfig

**Answer:** D

**NEW QUESTION 217**

- (Exam Topic 3)

A user is having trouble with their fax machine disconnecting during transmissions. The technician believes that a DSL signal may be on the same line as the fax. Which of the following tools would MOST likely help prove this hypothesis?

- A. Multimeter
- B. Cable tester
- C. Lineman's handset
- D. Toner probe

**Answer:** C

**NEW QUESTION 218**

- (Exam Topic 3)

Karen, a network technician, is troubleshooting in a wiring closet in 2011. The cabling to all the equipment does not match the documentation from 2007. Which of the following configuration management methods has been overlooked?

- A. Change management
- B. System logs
- C. Asset management
- D. Baselineing

**Answer:** A

**NEW QUESTION 222**

- (Exam Topic 3)

A network administrator suspects that recent traffic problems could be caused by a high CPU load on company routers. Which of the following would BEST be used to monitor CPU cycles on the routers?

- A. TACACS+
- B. SNMP
- C. Syslog
- D. DOCSIS

**Answer:** B

#### NEW QUESTION 223

- (Exam Topic 3)

Users report that an internal file server is inaccessible. Of the following commands, which would be the MOST useful in determining network-layer connectivity?

- A. dig
- B. nbtstat
- C. netstat
- D. ping

**Answer:** D

#### NEW QUESTION 227

- (Exam Topic 3)

Which of the following devices will allow Lisa, a user, to see a cached copy of websites?

- A. Content switch
- B. DNS server
- C. Proxy server
- D. Load balancer

**Answer:** C

#### NEW QUESTION 232

- (Exam Topic 3)

Which of the following handles HTTP requests on behalf of the client?

- A. Bandwidth shaper
- B. DNS server
- C. Proxy server
- D. Load balancer

**Answer:** C

#### NEW QUESTION 234

- (Exam Topic 3)

Which of the following performance optimization techniques would be MOST beneficial for a network-wide VoIP setup? (Select TWO).

- A. Proxy server
- B. Traffic shaping
- C. Caching engines
- D. Load balancing
- E. Quality of service

**Answer:** BE

#### NEW QUESTION 238

- (Exam Topic 3)

Which of the following describes a rationale for a network with redundant paths?

- A. VPN compatibility
- B. Unified communications implementation
- C. High availability requirement
- D. QoS

**Answer:** C

#### NEW QUESTION 242

- (Exam Topic 3)

Which of the following network scanners detects and sends out alerts for malicious network activity?

- A. Packet sniffers
- B. IDS
- C. Port scanners
- D. IPS

**Answer:** B

**NEW QUESTION 245**

- (Exam Topic 3)

Which of the following could Karen, a network technician, use to find the approximate location of a break in a long network cable?

- A. Protocol analyzer
- B. Time domain reflectometer
- C. Toner probe
- D. Multimeter

**Answer: B**

**NEW QUESTION 246**

- (Exam Topic 3)

Sandy, a network technician, is troubleshooting connectivity to a server at a remote office. Which of the following utilities should be used to locate the network issue?

- A. ipconfig
- B. arp
- C. tracert
- D. netstat

**Answer: C**

**NEW QUESTION 250**

- (Exam Topic 3)

Which of the following syslog severity codes indicates an emergency and that the system is unusable?

- A. 1
- B. 6
- C. 7

**Answer: A**

**NEW QUESTION 254**

- (Exam Topic 3)

When configuring a wireless access point, Kurt, a network administrator, needs to determine the MAC address of a local printer. Which of the following commands would be MOST helpful in determining the MAC address?

- A. ping
- B. arp
- C. route
- D. dig

**Answer: B**

**NEW QUESTION 255**

- (Exam Topic 3)

A new business' web server has seen a huge spike of legitimate traffic in the last week. The owners want to ensure the site has no problems as the business continues to grow. For Kim, a network administrator, which of the following is the MOST important concern for this company?

- A. Caching
- B. Asset management
- C. Traffic shaping
- D. High availability

**Answer: D**

**NEW QUESTION 259**

- (Exam Topic 3)

Which of the following methods would be implemented to correct a network slowdown caused by excessive video streaming?

- A. Traffic shaping
- B. Proxy server
- C. VPN concentrator
- D. High availability

**Answer: A**

**NEW QUESTION 264**

- (Exam Topic 3)

When troubleshooting a connectivity issue, which of the following commands will give the technician a list of the host names connected to the network?

- A. ping
- B. nbstat
- C. arp
- D. msconfig

**Answer:** B

**NEW QUESTION 265**

- (Exam Topic 3)

A user's computer is unable to access the Internet. Which of the following utilities can a technician use to determine if DNS is working?

- A. nbstat
- B. arp
- C. nslookup
- D. ipconfig

**Answer:** C

**NEW QUESTION 269**

- (Exam Topic 3)

A computer has lost network connectivity. The network technician determines the network cable and the cable drop are both good. Which of the following would the technician use to test the computer's NIC?

- A. Cable certifier
- B. Throughput tester
- C. Loopback plug
- D. Multimeter

**Answer:** C

**NEW QUESTION 270**

- (Exam Topic 3)

The technician is working on a DNS problem. Which of the following software tool is the technician MOST likely to use to troubleshoot this issue?

- A. nslookup
- B. ipconfig
- C. ping
- D. nbtstat

**Answer:** A

**NEW QUESTION 273**

- (Exam Topic 3)

Which of the following tools would BEST be used to verify if a network cable is properly terminated?

- A. Multimeter
- B. Cable certifier
- C. Toner probe
- D. Cable stripper

**Answer:** B

**NEW QUESTION 274**

- (Exam Topic 3)

A network administrator is reviewing logs and notices that a device with a public IP address is trying to access the web server RDP port. Which of the following tools can be used to resolve the domain of the public IP address?

- A. arp
- B. nslookup
- C. ipconfig
- D. netstat

**Answer:** B

**NEW QUESTION 276**

- (Exam Topic 3)

Users are reporting that external web pages load slowly. The network administrator determines that the Internet connection is saturated. Which of the following is BEST used to decrease the impact of web surfing?

- A. Caching
- B. Load balancing
- C. Port filtering
- D. Traffic analyzer

**Answer:** A

**NEW QUESTION 278**

- (Exam Topic 3)

Users report that an internal web server is not responding. Which of the following commands could be used on the server to confirm that the web service is running?

- A. nbtstat
- B. traceroute
- C. nslookup
- D. netstat

**Answer:** D

**NEW QUESTION 279**

- (Exam Topic 3)

Zach, a new network technician, is monitoring network traffic and notices the network is operating at 80% of capacity. Which of the following could be used to determine if this is abnormally high traffic use?

- A. Network maps
- B. Cable management documentation
- C. Wire schemes
- D. Baseline

**Answer:** D

**NEW QUESTION 281**

- (Exam Topic 3)

DNS lookups for a given host are intermittently failing. Which of the following would Kim, a technician, MOST likely use to verify this problem?

- A. arp
- B. nbtstat
- C. traceroute
- D. dig

**Answer:** D

**NEW QUESTION 284**

- (Exam Topic 3)

A company has been just opened a new site in another country. Both sites share information across the WAN continuously throughout the business day. Which of the following should be implemented to ensure both sites are accessible?

- A. Traffic shaping
- B. QoS
- C. Caching engines
- D. High availability

**Answer:** D

**NEW QUESTION 288**

- (Exam Topic 3)

Which of the following is used to verify configuration updates on a firewall?

- A. Signature identification
- B. Access control lists
- C. Scanning services
- D. Content filtering

**Answer:** A

**NEW QUESTION 289**

- (Exam Topic 4)

Which of the following security appliances would be used to only analyze traffic and send alerts when predefined patterns of unauthorized traffic are detected on the network?

- A. Host based IPS
- B. Network based firewall
- C. Signature based IDS
- D. Behavior based IPS

**Answer:** C

**NEW QUESTION 292**

- (Exam Topic 4)

A firewall that examines all the incoming traffic and decides if the traffic is going to be allowed though or dumped is a example of which of the following?

- A. Packet sniffing
- B. Packet filter
- C. Stateful inspection
- D. Content filter

**Answer:** C

**NEW QUESTION 295**

- (Exam Topic 4)

Which of the following should the last line of an ACL normally contain?

- A. Explicit allow
- B. Statically routed
- C. Random access
- D. Implicit deny

**Answer:** D

**NEW QUESTION 296**

- (Exam Topic 4)

A user at a hotel sees two SSIDs; both are called "HotelWireless". After the PC connects to one of the APs, the user notices their browser homepage has been changed. Which of the following BEST describes this AP?

- A. Man-in-the-middle
- B. DDoS
- C. Evil twin
- D. War driving

**Answer:** C

**NEW QUESTION 299**

- (Exam Topic 4)

Lisa, a network administrator, wants to be able to block all already known malicious activity. Which of the following would allow her to perform this activity?

- A. Behavioral Based IDS
- B. Signature Based IDS
- C. Behavioral Based IPS
- D. Signature Based IPS

**Answer:** D

**NEW QUESTION 304**

- (Exam Topic 4)

Lisa, a network administrator, needs to allow all websites to be accessible by the sales team for business purposes. Which of the following ports need to be enabled on the firewall? (Select TWO).

- A. 23
- B. 25
- C. 53
- D. 80
- E. 443

**Answer:** DE

**NEW QUESTION 308**

- (Exam Topic 4)

A company needs to implement a secure wireless system that would require employees to authenticate to the wireless network with their domain username and password. Which of the following would a network administrator deploy to implement these requirements? (Select TWO).

- A. 802.1q
- B. MAC address filtering
- C. WPA2 Personal
- D. WPA Enterprise
- E. 802.1x

**Answer:** DE

**NEW QUESTION 312**

- (Exam Topic 4)

Which of the following tools will scan a network for hosts and provide information on the installed operating system?

- A. DOCSIS
- B. NMAP
- C. IMAP
- D. BERT

**Answer:** B

**NEW QUESTION 313**

- (Exam Topic 4)

A network administrator is tasked with blocking unwanted spam which is being relayed by an internal email server. Which of the following is the FIRST step in preventing spam that is originating from bots on the network?

- A. Closing off port 25 on the firewall

- B. Closing off port 53 on the firewall
- C. Turning off the SMTP service on the email server
- D. Turning off the IMAP service on the email server

**Answer:** A

#### NEW QUESTION 317

- (Exam Topic 4)

A company has only three laptops that connect to their wireless network. The company is currently using WEP encryption on their wireless network. They have noticed unauthorized connections on their WAP and want to secure their wireless connection to prevent this. Which of the following security measures would BEST secure their wireless network? (Select TWO).

- A. Change the encryption method to WPA
- B. Limit the DHCP scope to only have three addresses total
- C. Enable the SSID broadcast
- D. Enable and configure MAC filtering
- E. Change the broadcast channel to a less commonly used channel

**Answer:** AD

#### NEW QUESTION 318

- (Exam Topic 4)

A user is unable to connect to a remote computer using RDP. The technician checks the firewall rules and notes that there is no rule that blocks RDP. Which of the following features of the firewall is responsible for blocking RDP?

- A. Stateful inspection
- B. NAT/PAT
- C. Port security
- D. Implicit deny

**Answer:** D

#### NEW QUESTION 321

- (Exam Topic 4)

Which of the following should be mitigated by employing proper coding techniques when developing software?

- A. Distributed denial of service attacks
- B. Buffer overflows
- C. War driving
- D. Packet sniffing

**Answer:** B

#### NEW QUESTION 325

- (Exam Topic 4)

Which of the following protocols is used by Windows to securely access a remote computer?

- A. RAS
- B. Telnet
- C. PPP
- D. RDP

**Answer:** D

#### NEW QUESTION 330

- (Exam Topic 4)

Which of the following is the MOST secure way to prevent malicious changes to a firewall?

- A. SNMPv2 access only
- B. TELNET access only
- C. SSH access only
- D. Console access only

**Answer:** D

#### NEW QUESTION 333

- (Exam Topic 4)

Lisa, an administrator, believes that the network has been attacked and there is no known definition or prevention method to help avoid this attack. Which of the following BEST describes this scenario?

- A. Zero day attack
- B. DDoS
- C. DoS
- D. SQL injection

**Answer:** A

**NEW QUESTION 334**

- (Exam Topic 4)

Which of the following uses SSL encryption?

- A. SMTP
- B. FTP
- C. HTTPS
- D. SNMP

**Answer:** C

**NEW QUESTION 339**

- (Exam Topic 4)

Which of the following is used to determine whether or not a user's account is authorized to access a server remotely?

- A. VPN
- B. RDP
- C. LDAP
- D. Encryption

**Answer:** C

**NEW QUESTION 344**

- (Exam Topic 4)

Which of the following solutions will detect and disable a rogue access point?

- A. Port scan
- B. Packet sniffer
- C. IPS
- D. IDS

**Answer:** C

**NEW QUESTION 348**

- (Exam Topic 4)

Which of the following would be used to test out the security of a specific network by allowing it to receive security attacks?

- A. Honeynet
- B. Honeypot
- C. Vulnerability scanner
- D. Network based IDS

**Answer:** A

**NEW QUESTION 349**

- (Exam Topic 4)

Sandy, an administrator, must connect to a remote UNIX server securely. Which of the following would be the MOST secure connection method?

- A. FTP
- B. PPP
- C. Telnet
- D. SSH

**Answer:** D

**NEW QUESTION 354**

- (Exam Topic 4)

A network administrator is setting up a WAP and wants to disable the ability of gaining access from the parking garage. Which of the following should the network administrator review?

- A. Signal strength
- B. SSID name
- C. WPA2 encryption
- D. WEP encryption

**Answer:** A

**NEW QUESTION 359**

- (Exam Topic 4)

Which of the following security protocols would BEST protect a connection to a remote email server and ensure full integrity of all transmitted email communication?

- A. TLS 1.2
- B. SNMPv3
- C. WPA2
- D. SMTP

**Answer:** A

**NEW QUESTION 360**

- (Exam Topic 4)

An administrator configuring remote access opens ports 500/UDP and 10000/UDP on the firewall. Which of the following services are MOST likely being allowed? (Select TWO).

- A. SSL
- B. IPSec
- C. Kerberos
- D. RDP
- E. L2TP
- F. PPTP

**Answer:** BE

**NEW QUESTION 363**

- (Exam Topic 4)

PKI is a method of user authentication which uses which of the following?

- A. Various router commands
- B. Access control lists
- C. Certificate services
- D. A RADIUS server

**Answer:** C

**NEW QUESTION 366**

- (Exam Topic 4)

Which of the following tools could attempt to detect operating system vulnerabilities?

- A. nslookup
- B. honeynet
- C. netstat
- D. nessus

**Answer:** D

**NEW QUESTION 368**

- (Exam Topic 4)

A NAS appliance has had a failed NIC replaced. Now the NAS appliance is no longer visible on the network. Which of the following is the MOST likely cause of the problem?

- A. The network cable connecting the NAS to the network switch is bad.
- B. The network port that the appliance is connected to is assigned to the wrong VLAN.
- C. Port security on the Ethernet switch has disabled the port.
- D. Firewall needs to be updated for the new NAS device.

**Answer:** C

**NEW QUESTION 371**

- (Exam Topic 4)

A technician needs to enter a username and password and have their fingerprint scanned to access a server. Which of following types of authentication is this an example of?

- A. Single sign-on
- B. Network access control
- C. PKI authentication
- D. Two-factor authentication

**Answer:** D

**NEW QUESTION 372**

- (Exam Topic 4)

Lisa, an administrator, believes that the network has been attacked and MAC addresses have been captured allowing unauthorized computers to access the network. Which of the following tools did the attackers MOST likely use to accomplish this?

- A. Intrusion prevention software
- B. Packet sniffer
- C. Intrusion detection software
- D. Port scanner

**Answer:** B

**NEW QUESTION 373**

- (Exam Topic 4)

Kim, a user, reports that the web browser is indicating the site certificate is not trusted. Which of the following attacks may be in progress?

- A. Man-in-the-middle
- B. Denial of service
- C. Ping flooding
- D. Smurfing

**Answer:** A

#### **NEW QUESTION 374**

- (Exam Topic 5)

Which of the following wireless parameters may need to be modified when a new cordless telephone is installed?

- A. Encryption type
- B. SSID
- C. IP address
- D. Channel

**Answer:** D

#### **NEW QUESTION 376**

- (Exam Topic 5)

A network administrator wants to perform a test to see if any systems are passing clear text through the network. Which of the following would be used?

- A. Social engineering
- B. Packet sniffing
- C. Rogue access point
- D. Man-in-the-middle

**Answer:** B

#### **NEW QUESTION 381**

- (Exam Topic 5)

Zach, a technician, discovers a switch is not communicating with the other switches in a stack. Which of the following is the MOST likely cause?

- A. Both T568A and T568B standards are being used.
- B. STP is disabled.
- C. The cable is not a crossover.
- D. The port is not trunked.

**Answer:** C

#### **NEW QUESTION 384**

- (Exam Topic 5)

The Network Interface Layer of the TCP/IP model corresponds to which of the following layers of the OSI model? (Select TWO).

- A. Network
- B. Session
- C. Transport
- D. Physical
- E. Data link

**Answer:** DE

#### **NEW QUESTION 385**

- (Exam Topic 5)

An administrator is troubleshooting analog telephony issues on the punch down block. Which of the following tools would be MOST useful in this scenario?

- A. T1 loopback
- B. Butt set
- C. Multimeter
- D. Protocol analyzer

**Answer:** B

#### **NEW QUESTION 386**

- (Exam Topic 5)

When installing new WAPs in a small office, which of the following is the BEST way to physically mitigate the threats from war driving?

- A. Implement multiple wireless encryption techniques.
- B. Implement PoE on each WAP.
- C. Decrease signal strength.
- D. Increase signal strength.

**Answer:** C

**NEW QUESTION 390**

- (Exam Topic 5)

A technician is looking to secure an entire network by blocking all non-essential ports. Which of the following devices would BEST provide this functionality?

- A. Firewall
- B. Honeynet
- C. IDS
- D. IPS

**Answer:** A

**NEW QUESTION 395**

- (Exam Topic 5)

Keeping an authoritative and timely record of network devices and their settings is a key activity of which of the following?

- A. Project management
- B. Quality of service
- C. Configuration management
- D. Bandwidth shaping

**Answer:** C

**NEW QUESTION 400**

- (Exam Topic 5)

Which of the following protocols is used for remote management of devices?

- A. SNMP
- B. TFTP
- C. Syslog
- D. SMTP

**Answer:** A

**NEW QUESTION 404**

- (Exam Topic 5)

A network technician is installing a simple SOHO router with wireless functionality. Which of the following wireless encryption standards would be BEST suited for the HIGHEST level of security?

- A. WPA2
- B. WPA
- C. WEP64
- D. WEP128

**Answer:** A

**NEW QUESTION 405**

- (Exam Topic 5)

You have been tasked with testing a CAT5 cable. A summary of the test results can be found on the screen. Step 1: Select the tool that was used to create the cable test results.

Step 2: Interpret the best results and select the options that explains the results.

### Cable Test

Step 1: Select the tool that was used to create the cable test results.

Cable Test Result			
1.	2	Open	7ft
3.	6	Short	7ft
4.	5	Open	7ft
7.	8	Open	7ft

### Tool Choices

- Multimeter
- Toner Probe
- Protocol Analyzer
- OTDR
- Cable Certifier
- Crimper
- Punch Down Tool

Step 2: Interpret the test results and select the option that explains the results.  
After you are done with your analysis, click the 'Submit Cable Test Analysis' button.

☐ Correctly crimped cable

☐ Incorrectly crimped cable

- A. Mastered
- B. Not Mastered

**Answer:** A

**Explanation:**

Cable certifier – incorrectly crimped cable.

**NEW QUESTION 410**

- (Exam Topic 5)

Which of the following protocols provides a secure connection between two networks?

- A. L2TP
- B. IPSec
- C. PPP
- D. PPTP

**Answer:** B

**NEW QUESTION 413**

- (Exam Topic 5)

A technician has installed a group of layer 2 switches with multiple VLANs. The VLANs cannot talk to each other. Which of the following network devices could correct this problem? (Select TWO).

- A. Hub
- B. DNS server
- C. DHCP server
- D. Layer 3 switch
- E. Router

**Answer:** DE

**NEW QUESTION 415**

- (Exam Topic 5)

Which of the following IP addresses would be classified as private?

- A. 10.100.200.0
- B. 169.253.10.20
- C. 172.168.5.0
- D. 200.100.25.0

**Answer:** A

**NEW QUESTION 419**

- (Exam Topic 5)

A user reports a network failure on a computer. The technician determines that the computer and NIC are operating properly. Which of the following tools can the technician use to trace the network cabling back to the punch down block?

- A. Protocol analyzer
- B. Multimeter
- C. Punch down tool
- D. Toner probe

**Answer:** D

**NEW QUESTION 420**

- (Exam Topic 5)

Which of the following is associated with DNS reverse lookup zones?

- A. CNAME
- B. TXT
- C. PTR
- D. MX

**Answer:** C

**NEW QUESTION 425**

- (Exam Topic 5)

Which of the following is the Telco end of a T1 demarc?

- A. Smart jack
- B. Network tap
- C. Proxy server
- D. IDF

Answer: A

NEW QUESTION 430

- (Exam Topic 5)

A company wants to simplify network authentication for their users. Which of the following would be used to implement wireless security with single sign-on?

- A. WPA2 enterprise
- B. WEP
- C. Stateful firewall
- D. PAT

Answer: A

NEW QUESTION 431

- (Exam Topic 5)

A customer wants to increase firewall security. Which of the following are common reasons for implementing port security on the firewall? (Select TWO).





- A. Preventing dictionary attacks on user passwords
- B. Reducing spam from outside email sources
- C. Shielding servers from attacks on internal services
- D. Blocking external probes for vulnerabilities
- E. Directing DNS queries to the primary server

Answer: CD

NEW QUESTION 432

- (Exam Topic 5)

Drag and drop each networking tool to the MOST appropriate descriptor. Each tool may only be used once.

Used to verify known good patch cables		
Used to correct open short on a cable		
Used to determine which port a CAT6 cable is connected to		
Used to verify functionality after a NIC is installed		
Used to terminate a cable at a 110 block		

- A. Mastered
- B. Not Mastered

**Answer: A**

**Explanation:**

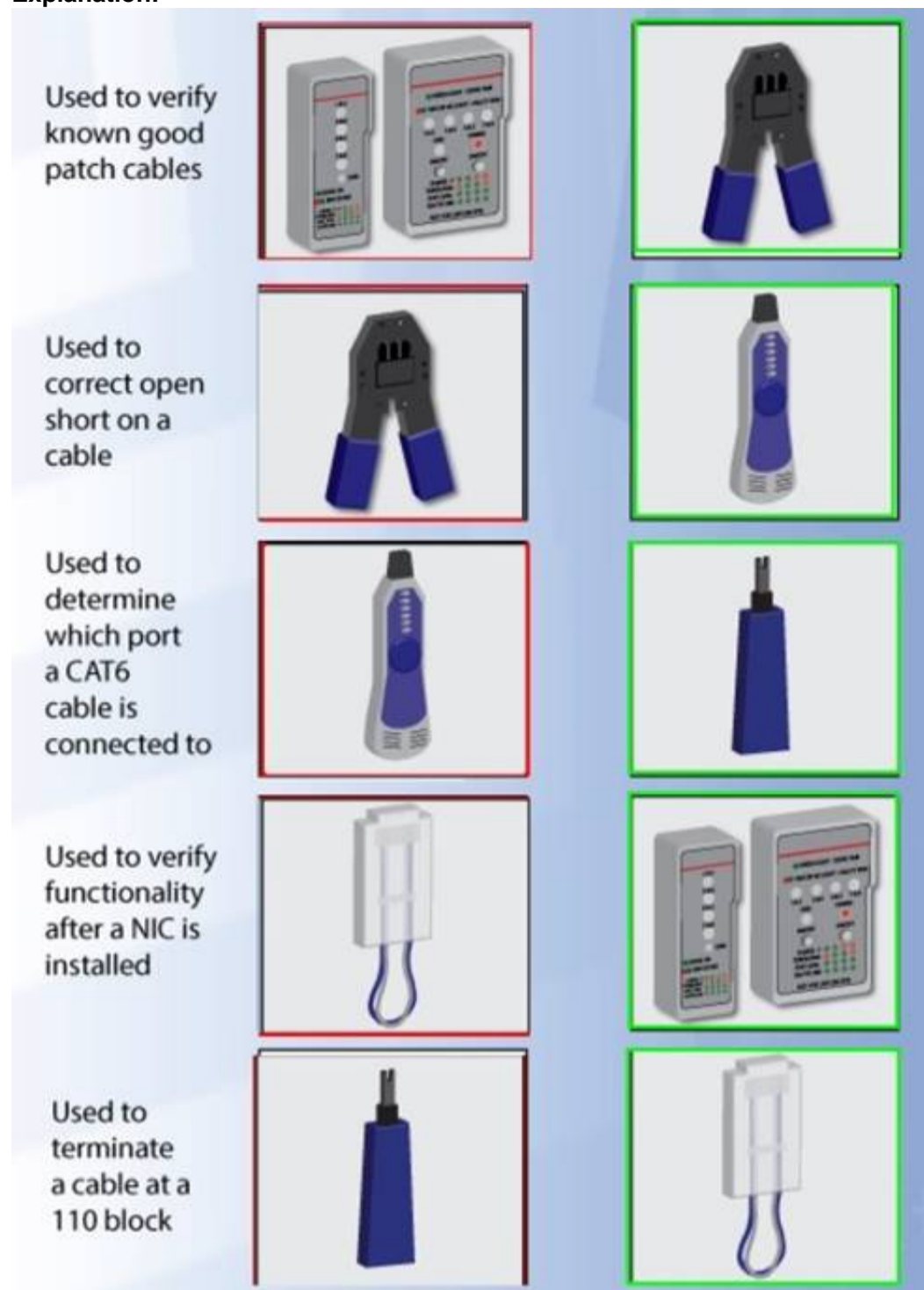

**NEW QUESTION 436**

- (Exam Topic 5)

The term virtual switch refers to which of the following?

- A. A switch that has not yet been implemented in the local network
- B. Migrating an entire environment to virtualization
- C. A computer component that controls environmental elements, such as lights and thermometers
- D. A logical, rather than a physical switch device

**Answer: D**

**NEW QUESTION 439**

- (Exam Topic 5)

Several users are reporting connectivity issues with their laptops. Upon further investigation, the network technician identifies that their laptops have been attacked from a specific IP address outside of the network. Which of the following would need to be configured to prevent any further attacks from that IP address?

- A. Port security
- B. IDS
- C. Firewall rules
- D. Switch VLAN assignments

**Answer: C**

**NEW QUESTION 444**

- (Exam Topic 5)

Which of the following can a technician use when a company implements redundant WAN links?

- A. Content filter
- B. Load balancer
- C. Proxy server
- D. VPN concentrator

**Answer: B**

**NEW QUESTION 448**

- (Exam Topic 5)

Which of the following is a Class A IP address?

- A. 10.4.0.1
- B. 169.254.0.1
- C. 192.168.0.1
- D. 254.200.0.1

**Answer:** A

**NEW QUESTION 449**

- (Exam Topic 5)

Which of the following WAN technology types has the GREATEST latency?

- A. ISDN
- B. Fiber
- C. Satellite
- D. Cable

**Answer:** C

**NEW QUESTION 453**

- (Exam Topic 5)

A DSL modem connects to the provider's network using which of the following authentication techniques?

- A. PoE
- B. MS-CHAP
- C. PPPoE
- D. EAP

**Answer:** C

**NEW QUESTION 454**

- (Exam Topic 5)

A network is having problems with traffic flowing to several critical websites that are used for necessary company work. Which of the following appliances would BEST handle network traffic to increase network performance?

- A. Caching engine
- B. Traffic shaper
- C. Network based firewall
- D. Packet sniffer

**Answer:** B

**NEW QUESTION 456**

- (Exam Topic 5)

A network technician visits a site that needs voice connectivity to the corporate office and installs four IP phones. The phone exchange resides at the telephone company. Which of the following technologies is being used?

- A. Virtual switch
- B. Virtual server
- C. Virtual desktop
- D. Virtual PBX

**Answer:** D

**NEW QUESTION 460**

- (Exam Topic 5)

Which of the following protocols can be implemented to provide encryption during transmission between email gateways?

- A. TLS
- B. PPTP
- C. SSH
- D. HTTPS

**Answer:** A

**NEW QUESTION 462**

- (Exam Topic 5)

Users trying to access a website using HTTPS are being blocked by the firewall. Which of the following ports needs to be allowed?

- A. 80
- B. 143
- C. 443
- D. 3389

**Answer:** C

**NEW QUESTION 463**

- (Exam Topic 5)

A network administrator wants to monitor traffic by deploying MIBs. Which of the follow network monitoring resources would be used?

- A. SCTP
- B. Packet sniffer
- C. DCCP
- D. SNMP

**Answer:** D

**NEW QUESTION 467**

- (Exam Topic 5)

A customer has requested a solution using multiple WAPs for wireless access. Which of the following should be different on each WAP to prevent wireless problems?

- A. Firewalls
- B. VLANs
- C. Channels
- D. Antenna types

**Answer:** C

**NEW QUESTION 470**

- (Exam Topic 5)

A network administrator is configuring PXE boot to reimage a computer lab. Which of the following must be configured on the existing DHCP server to specify the IP address of the imaging server from which the clients must boot?

- A. Scope
- B. Reservation
- C. Option
- D. Lease

**Answer:** C

**NEW QUESTION 473**

- (Exam Topic 5)

Which of the following can be used to decrypt SSL packets which encapsulate internal network addresses in the payload?

- A. Proxy server
- B. Content filter
- C. Load balancer
- D. VPN concentrator

**Answer:** D

**NEW QUESTION 474**

- (Exam Topic 5)

There is suspected virus activity on the network. Which of the following would Lisa, a technician, use to study network traffic?

- A. Protocol analyzer
- B. Cable tester
- C. Cable certifier
- D. Environmental monitor

**Answer:** A

**NEW QUESTION 478**

- (Exam Topic 5)

Lisa, a network technician, needs to introduce a few more cables to the existing patch panel. Which of the following tools would she use?

- A. OTDR
- B. Multimeter
- C. Punch down tool
- D. Temperature monitor

**Answer:** C

**NEW QUESTION 483**

- (Exam Topic 5)

Which of the following network topologies is ONLY possible between two users?

- A. Star

- B. Client-server
- C. Hybrid
- D. Peer-to-peer

**Answer:** D

**NEW QUESTION 488**

- (Exam Topic 5)

No link lights on a switch's SFP are functioning, so the network technician re-terminates the end. After testing the cable, the tester is showing a db loss of -9. Which of the following types of cable is MOST likely being tested?

- A. Fiber
- B. CAT3
- C. CAT5e
- D. CAT6a

**Answer:** A

**NEW QUESTION 492**

- (Exam Topic 5)

Which of the following media types can carry a standard Ethernet signal for network connectivity?

- A. USB
- B. Parallel
- C. Serial
- D. CAT6

**Answer:** D

**NEW QUESTION 495**

- (Exam Topic 5)

Zach, a technician, suspects a duplicate IP address assignment on the network. Which of the following resources can be used to verify this problem?

- A. Network map
- B. Environmental monitor
- C. Placement map
- D. Syslog

**Answer:** D

**NEW QUESTION 498**

- (Exam Topic 5)

A company wants to have a security zone to isolate traffic within the firewall. Which of the following could be used?

- A. VPN
- B. ACL
- C. DMZ
- D. VLAN

**Answer:** C

**NEW QUESTION 502**

- (Exam Topic 5)

After a technician has identified the problem and its impact, which of the following steps should be performed NEXT?

- A. Implement preventative measures.
- B. Establish a plan of action to resolve the problem.
- C. Establish a theory of probable cause.
- D. Implement the solution or escalate as necessary.

**Answer:** C

**NEW QUESTION 505**

- (Exam Topic 5)

Kim, a network administrator, should consult which documentation sources FIRST to determine the cause of recent network issues?

- A. Network map
- B. Cable management
- C. Change management
- D. Asset management

**Answer:** C

**NEW QUESTION 507**

- (Exam Topic 5)

Which of the following devices can be used to offload outbound web server SSL encryption overhead?

- A. NIPS
- B. Proxy server
- C. Content filter
- D. VPN concentrator

**Answer:** B

#### NEW QUESTION 510

- (Exam Topic 5)

An IP address assigned from a DHCP server is said to be which of the following?

- A. Hybrid
- B. Dynamic
- C. Secure
- D. Static

**Answer:** B

#### NEW QUESTION 515

- (Exam Topic 5)

The components of a NIC function at which of the following layers of the OSI model? (Select TWO).

- A. Layer 1
- B. Layer 2
- C. Layer 3
- D. Layer 4
- E. Layer 5

**Answer:** AB

#### NEW QUESTION 519

- (Exam Topic 5)

The network technician is working in an office that has both VoIP telephone lines and analog lines. A user states that the fax machine is not sending or receiving faxes. The network technician determines that the fax machine uses an analog phone line. Which of the following tools would the technician use to troubleshoot the issue?

- A. Cable tester
- B. Buttset
- C. Toner probe
- D. Cable certifier

**Answer:** B

#### NEW QUESTION 522

- (Exam Topic 5)

Sandy, a user, is unable to access the Internet. The network administrator notices that the workstation has an APIPA address. Which of the following is MOST likely not functioning correctly in this situation?

- A. Broadcast address
- B. Multicast address
- C. DNS
- D. DHCP

**Answer:** D

#### NEW QUESTION 525

- (Exam Topic 5)

A Linux-based workstation is unable to connect to an IP printer on the same network segment. The printer IP address settings have been verified. How would a network technician verify IP address settings on the Linux-based workstation?

- A. Run the dig command on the workstation.
- B. Run the nslookup command on the workstation.
- C. Run the ipconfig command on the workstation.
- D. Run the ifconfig command on the workstation.

**Answer:** D

#### NEW QUESTION 528

- (Exam Topic 5)

Which of the following methods limits access to a network based on characteristics of the network card?

- A. IP filtering
- B. MAC filtering
- C. Port filtering

D. Encryption

**Answer:** B

**NEW QUESTION 531**

- (Exam Topic 5)

Which of the following VPN technologies uses IKE and ISAKMP for key exchange?

- A. SSL
- B. IPSec
- C. L2TP
- D. PPTP

**Answer:** B

**NEW QUESTION 535**

- (Exam Topic 5)

A company has just installed a new network switch for an expanding department. The company is also piloting the use of a VoIP phone system for this department. Which of the following should be enabled on the new network switch?

- A. WINS
- B. QoS
- C. NAT
- D. DHCP

**Answer:** B

**NEW QUESTION 537**

- (Exam Topic 5)

Zach, a technician, is checking newly installed CAT5e cabling, and suspects that some of the ends were not properly terminated. Which of the following tools will verify this?

- A. Cable tester
- B. Toner probe
- C. OTDR
- D. Loopback plug

**Answer:** A

**NEW QUESTION 539**

- (Exam Topic 5)

A company needs to find a way to best route latency-sensitive traffic appropriately on an already congested network. Which of the following would be BEST suited for this purpose?

- A. QoS
- B. PPPoE
- C. RADIUS
- D. VPN

**Answer:** A

**NEW QUESTION 541**

- (Exam Topic 5)

Which of the following LAN technologies is used to provide a MAXIMUM bandwidth of 1Gbps through single mode fiber?

- A. 10GBaseLR
- B. 100BaseFX
- C. 100BaseTX
- D. 1000BaseX

**Answer:** D

**NEW QUESTION 543**

- (Exam Topic 5)

Tenants access multiple wireless networks in a building. Users report intermittent connectivity. Which of the following is the MOST likely cause of the problem?

- A. The channels are overlapping with other wireless networks and should be changed.
- B. The SSIDs are incompatible and should be renamed.
- C. The users have incompatible wireless network cards and should upgrade.
- D. The default idle period for logoff is too short and should be changed to a longer limit.

**Answer:** A

**NEW QUESTION 546**

- (Exam Topic 5)

The systems administrator has assigned an IP address and default gateway to a standard Layer 2 switch. Which of the following would be the primary purpose of doing this?

- A. Allow VLAN routing
- B. Enable packet filtering on the switch
- C. Allow remote administration of the switch
- D. Enable MAC filtering on the switch

**Answer: C**

#### NEW QUESTION 548

- (Exam Topic 5)

Which of the following security methods is used to attract users attempting to gain unauthorized access to various systems within a single network?

- A. Network based IDS
- B. Firewall
- C. Network based IPS
- D. Honeynet

**Answer: D**

#### NEW QUESTION 549

- (Exam Topic 5)

GigSwitch1 is currently configured with a speed of 100 and Duplex is set to Auto on all interfaces. Interface 2 will be connected to GigSwitch2 which is used for all departments. Interface 1 will be used for HR traffic only.

GigSwitch1 needs to be configured with the following parameters: Configure the necessary protocol to prevent switching loops Configure GigSwitch1 with a /24 IP address for management

Traffic across Interface 1 needs to be forced to accept and receive up to 100Mbps data at the same time Traffic across Interface 2 needs to be forced to use Gigabit speeds and maximum performance

Drag and drop the appropriate configurations to their corresponding requirements. All placeholders must be filled. Not all configurations will be used.

Global Switch Configuration	Interface 1	Interface 2
1 <input type="text"/>	1 <input type="text"/>	1 <input type="text"/>
2 <input type="text"/>	2 <input type="text"/>	2 <input type="text"/>
100/Full	1000/Full	IP Address 192.168.1.1 255.255.240.0
1000/Full		VLAN trunking/ multiplexing
100/Auto	1000/Auto	VLAN 10 HR
1000/Auto		Enable STP
Auto/Full	IP Address 192.168.1.1 255.255.240.0	VLAN 20 Sales
Auto/Auto	IP Address 192.168.1.1 255.255.255.0	VLAN 30 OPS
		Enable AAA
		Enable SNMPv3

- A. Mastered
- B. Not Mastered

**Answer: A**

**Explanation:**

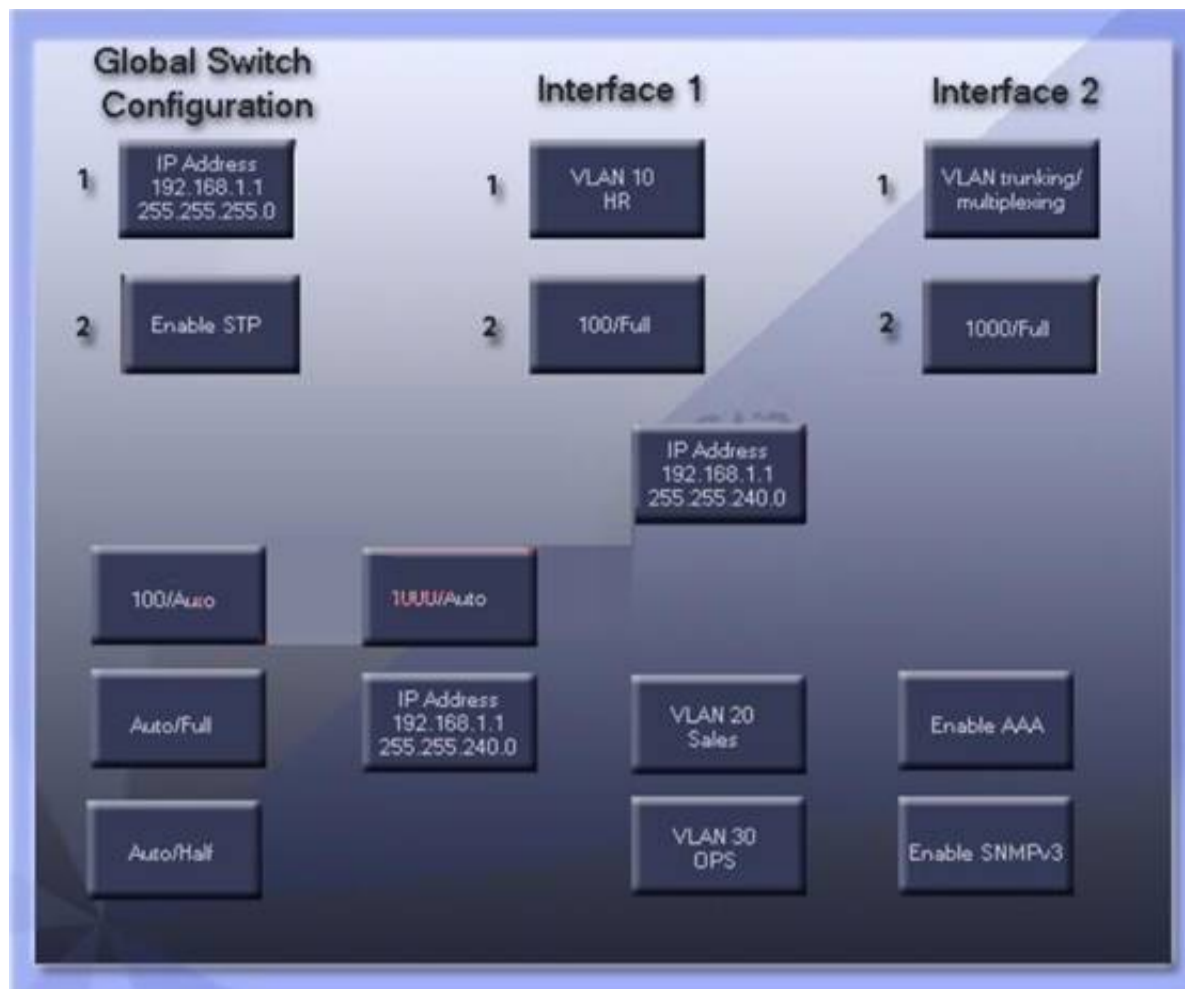

#### NEW QUESTION 550

- (Exam Topic 5)

Which of the following methods for network performance optimization is used to distribute traffic among similar devices?

- A. Fault tolerance
- B. QoS
- C. Proxy server
- D. Load balancing

**Answer: D**

#### NEW QUESTION 552

- (Exam Topic 5)

Which of the following cable types is unshielded?

- A. STP
- B. Twinax
- C. UTP
- D. Coax

**Answer: C**

#### NEW QUESTION 553

- (Exam Topic 5)

Which of the following network protocols is used for a secure command line interface for management of network devices?

- A. SSH
- B. TELNET
- C. IGMP
- D. HTTP

**Answer: A**

#### NEW QUESTION 557

- (Exam Topic 5)

A router operates at which of the following layers of the OSI model?

- A. Layer 2
- B. Layer 3
- C. Layer 4
- D. Layer 5

**Answer: B**

#### NEW QUESTION 559

- (Exam Topic 5)

Zach, a network technician, is configuring several switches to be managed remotely. Which of the following must be configured to connect via SSH to each of

those devices, as well as to retrieve various parameters?

- A. PoE settings and VTP configuration
- B. SNMP configuration only
- C. IP address and SNMP configuration
- D. QoS and PoE settings

**Answer:** C

#### NEW QUESTION 560

- (Exam Topic 5)

A network technician is doing a wireless audit and finds an SSID that does not match the company's SSID. The company uses the SSID of ABC123, and the SSID the technician found is Default. Which of the following threats did the network technician find?

- A. AP isolation
- B. DDoS
- C. Evil twin
- D. Rogue AP

**Answer:** D

#### NEW QUESTION 563

- (Exam Topic 5)

A company has attempted to introduce a new major network segment to allow growth in capacity. On the core switch, a GBIC was used to interconnect with a newly placed downstream distribution switch for the first time. Soon after this implementation, a network flood and an outage occurred between the core and new distribution network modules. Which of the following should the network administrator troubleshoot FIRST in order to rectify the issue?

- A. Check for switching loops between core and distribution switches.
- B. Check whether an incorrect VLAN has been assigned to the new distribution switch.
- C. Check for inconsistent or missing routes between the core and distribution switches.
- D. Check whether the GBIC was set to multi-mode instead of single-mode SFP.

**Answer:** A

#### NEW QUESTION 564

- (Exam Topic 5)

Which of the following TCP/IP model layers does the OSI model Presentation layer map to?

- A. Transport
- B. Internet
- C. Application
- D. Network Interface

**Answer:** C

#### NEW QUESTION 569

- (Exam Topic 5)

A new monitoring device is installed in the network that uses ping to determine whether critical network Internet routers are up. After three missing pings, the alarm reports the device is down. The device is now constantly reporting alarms, yet there are no reported Internet problems from users. Which of the following is the MOST likely cause?

- A. A missing route on the alarm device.
- B. Incorrect VLAN assignment on the router.
- C. A missing route on the network routers.
- D. Incorrect speed/duplex setting on the alarm device.

**Answer:** D

#### NEW QUESTION 574

- (Exam Topic 5)

Which of the following is a fiber connector that is slightly smaller than a standard copper network cable connector?

- A. BNC
- B. GBIC
- C. MT-RJ
- D. SC

**Answer:** C

#### NEW QUESTION 578

- (Exam Topic 5)

Some visitors are unable to access the wireless network. The network's wireless infrastructure is comprised of three different buildings with the configurations listed below. Wireless network in Building A and C is used exclusively for internal employees and Building B is used for visitors and requires no additional configuration on their devices. Which of the following settings would need to be modified to provide wireless access to all visitors?

Building A Building B Building C

Channel: 2 Channel: 6 Channel: 11

Encryption: WPA2 Encryption: WPA2 Encryption: WPA2

- A. Encryption set to Open in all Buildings
- B. Encryption set to Open in Building B
- C. Encryption set to WEP in Building B
- D. Channel set to 11 in Building B

**Answer:** B

**NEW QUESTION 583**

- (Exam Topic 5)

Drag and drop the following maximum speeds to their corresponding wireless standards. Tokens can be used more than once.

Wireless Standard	Maximum Speed
802.11a	<div></div> <div>10Mbps</div>
802.11b	<div></div> <div>11Mbps</div>
802.11g	<div></div> <div>54Mbps</div>
802.11n	<div></div> <div>56Mbps</div>
	<div></div> <div>&gt;100Mbps</div>

- A. Mastered
- B. Not Mastered

**Answer:** A

**Explanation:**

Wireless Standard	Maximum Speed	
802.11a	54Mbps	10Mbps
802.11b	11Mbps	11Mbps
802.11g	54Mbps	54Mbps
802.11n	>100Mbps	56Mbps
		>100Mbps

#### NEW QUESTION 585

- (Exam Topic 5)

Which of the following source ports is MOST likely to be used by a client when making an outbound TCP connection to a windows server?

- A. 80
- B. 445
- C. 3000
- D. 3389

**Answer: C**

#### NEW QUESTION 588

- (Exam Topic 5)

A small office home office (SOHO) customer is going to be replacing their switch. The customer also wants to add a WAP in a dropped ceiling; however, there are no power outlets above the drop ceiling, but there is a CAT5e network jack. Which of the following technologies should the new switch have to allow this WAP to be placed where the customer requests, without any other major changes to the environment?

- A. PoE
- B. Layer 3 switching
- C. STP
- D. VLAN

**Answer: A**

#### NEW QUESTION 591

- (Exam Topic 5)

A technician has low signal strength connecting two wireless bridges. Which of the following could be the problem?

- A. Low PoE wattage
- B. Opposing antenna polarizations
- C. Short distance between antennas
- D. WPA 2 encryption

**Answer: B**

#### NEW QUESTION 596

.....

## Thank You for Trying Our Product

### We offer two products:

1st - We have Practice Tests Software with Actual Exam Questions

2nd - Questions and Answers in PDF Format

### JK0-023 Practice Exam Features:

- \* JK0-023 Questions and Answers Updated Frequently
- \* JK0-023 Practice Questions Verified by Expert Senior Certified Staff
- \* JK0-023 Most Realistic Questions that Guarantee you a Pass on Your First Try
- \* JK0-023 Practice Test Questions in Multiple Choice Formats and Updates for 1 Year

**100% Actual & Verified — Instant Download, Please Click**  
**[Order The JK0-023 Practice Test Here](#)**