

# Microsoft

## Exam Questions PL-900

Microsoft Power Platform Fundamentals



### NEW QUESTION 1

HOTSPOT - (Topic 1)

A company plans to use Power Platform to build apps which address specific business challenges.

You need to recommend the appropriate types of Power Apps to use.

What should you recommend? To answer, select the appropriate option in the answer area.

NOTE: Each correct selection is worth one point.

Scenario	Tool
Field technicians need a mobile app to capture the location and the image of defective products.	<div><div></div><div>Canvas app</div><div>Power Apps portal</div><div>Common Data Service</div></div>
Sales representatives need to see different views and dashboards in the sales app.	<div><div></div><div>Canvas app</div><div>Model-driven app</div><div>Power Apps portal</div></div>
External customers need to view the progress of their service cases.	<div><div></div><div>Model-driven app</div><div>Power Apps portal</div><div>Common Data Service</div></div>

- A. Mastered  
B. Not Mastered

**Answer:** A

**Explanation:**

Scenario	Tool
Field technicians need a mobile app to capture the location and the image of defective products.	<div><div></div><div>Canvas app</div><div>Power Apps portal</div><div>Common Data Service</div></div>
Sales representatives need to see different views and dashboards in the sales app.	<div><div></div><div>Canvas app</div><div>Model-driven app</div><div>Power Apps portal</div></div>
External customers need to view the progress of their service cases.	<div><div></div><div>Model-driven app</div><div>Power Apps portal</div><div>Common Data Service</div></div>

### NEW QUESTION 2

- (Topic 1)

You are a customer service manager.

You need to implement a Power Apps portal that allows customers to submit cases. Which type of data source is used?

- A. Dynamics 365 Connector  
B. Microsoft SharePoint  
C. Microsoft Azure Storage  
D. Common Data Service

**Answer:** B

**Explanation:**

SharePoint can be set up to setup customer feedback.

Note: The PowerApp uses Finance and Operations connector to grab sales order information and SharePoint connector to connect and write the data to SharePoint list.

Reference:

<https://powerapps.microsoft.com/en-us/blog/scenario-2-collect-customer-feedback-in-sharepoint-after-order-delivery/>

### NEW QUESTION 3

DRAG DROP - (Topic 1)

A company uses Power Apps.

You need to perform administrative tasks for the company.

Which admin centers should you use? To answer, drag the appropriate admin centers to the correct requirements. Each admin center may be used once, more than once, or not at all. You may need to drag the split bar between panes or scroll to view content.

NOTE: Each correct selection is worth one point.

Admin centers	Requirement	Admin center
<div>Azure Active Directory</div>	Create user accounts for Power Apps.	<div>Admin center</div>
<div>Dynamics 365 Admin center</div>	Assign the Environment Maker role to a user.	<div>Admin center</div>
<div>Power Apps Admin center</div>		
<div>Power BI Admin portal</div>		

- A. Mastered
- B. Not Mastered

Answer: A

Explanation:

Box 1: Azure Active Directory  
Create the company users in the Azure Active Directory.  
Box 2: Power Apps admin center  
In the Power Apps Admin center, manage environments that you've created and those for which you have been added to the Environment Admin or System Administrator role. From the admin center, you can perform these administrative actions:  
Create environments. Rename environments.  
Add or remove a user or group from either the Environment Admin or Environment Maker role.  
Etc.

NEW QUESTION 4

- (Topic 1)  
A distribution company has multiple warehouses.  
Tax rates charged on sales orders need to be calculated based on locality and region. You need to recommend a cost-effective solution that can be implemented quickly. What should you recommend?

- A. Check AppSource for a tax add-on.
- B. Create alerts in Dynamics 365 Finance for tax table changes.
- C. Implement the Common Data Model.
- D. Run a Power BI report.
- E. Write scripts and code tax updates.

Answer: B

Explanation:

Reference:  
<https://docs.microsoft.com/en-us/dynamics365/finance/general-ledger/indirect-taxes- overview>

NEW QUESTION 5

HOTSPOT - (Topic 1)  
A rapidly growing company wants to empower users to build apps, automate business processes, and analyze data without requiring I expertise or development skills and without increasing IT expenses and dependencies.  
You need to recommend tools so that users can accomplish specific tasks.  
Which tools should you recommend? To answer, select the appropriate options in the answer area.  
NOTE: Each correct selection is worth one point.

Scenario	Application
Build automatic workflows that access multiple data sources.	<div>AI Builder</div> <div>Power Apps</div> <div>Microsoft Flow</div> <div>Azure Functions</div> <div>Power BI</div>
Create custom apps that address specific business needs.	<div>AI Builder</div> <div>Power Apps</div> <div>Microsoft Flow</div> <div>Azure Functions</div> <div>Power BI</div>
Design insightful data visualizations.	<div>AI Builder</div> <div>Power Apps</div> <div>Microsoft Flow</div> <div>Azure Functions</div> <div>Power BI</div>

- A. Mastered
- B. Not Mastered

Answer: A

Explanation:

Box 1: Microsoft Flow

Microsoft Flow, now called Power Automate, is cloud-based software that allows employees to create and automate workflows and tasks across multiple applications and services without help from developers.

Box 2: Power Apps

PowerApps is a suite of apps, services, connectors and data platform that provides a rapid application development environment to build custom apps for your business needs.

Box 3: Power BI

Power BI is a business analytics solution that lets you visualize your data and share insights across your organization, or embed them in your app or website. Connect to hundreds of data sources and bring your data to life with live dashboards and reports.

NEW QUESTION 6

- (Topic 1)

This question requires that you evaluate the BOLD text to determine if it is correct.

You have a Power Apps app. You create a new version of the app and then publish the new version. A customer goes through the process of restoring the previous version of the app. In the Version tab for the app, you will see two versions of the app.

Review the underlined text. If it makes the statement correct, select “No change is needed.” If the statement is incorrect, select the answer choice that makes the statement correct.

- A. No change is needed.
- B. one
- C. three
- D. four

Answer: C

Explanation:

Restore a canvas app to a previous version in PowerApps.

- \* 1. Open powerapps.com, and then click or tap Apps in the left navigation bar.
- \* 2. Near the right edge, click or tap the info icon for the app that you want to restore.
- \* 3. Click or tap the Versions tab, and then click or tap Restore for the version that you want to restore.

Details • Share • <u>Versions</u> • Settings • Analytics (preview)						
PowerApps keeps a version history of your apps.						
VERSION	MODIFIED	MODIFIED BY	POWERAPPS RELEASE ?	PUBLISHED	COMMENT	
2	8/20/2018 2:24:29 PM	Firstname Lastname	3.18081.19	Live	Restore Delete	
1	7/9/2018 10:55:48 AM	Firstname LastName	3.18071.36		<b>Restore</b> Delete	

- \* 4. In the confirmation dialog box, click or tap Restore. A new version is added to your list.

Details • Share • <u>Versions</u> • Settings • Analytics (preview)						
PowerApps keeps a version history of your apps.						
VERSION	MODIFIED	MODIFIED BY	POWERAPPS RELEASE ?	PUBLISHED	COMMENT	
3	8/20/2018 2:41:30 PM	Firstname Lastname	3.18071.36		Publish this version	
2	8/20/2018 2:24:29 PM	Firstname Lastname	3.18081.19	Live	Restore Delete	
1	7/9/2018 10:55:48 AM	Firstname Lastname	3.18071.36		Restore Delete	

Reference:

<https://docs.microsoft.com/en-us/powerapps/maker/canvas-apps/restore-an-app>

NEW QUESTION 7

DRAG DROP - (Topic 1)

A company has locations in multiple regions. The company develops solutions based on Power Apps and Power Automate.

You need to recommend features to support the implementation.

Which Power Platform features should you recommend? To answer, drag the appropriate features to the correct requirements. Each feature may be used once, more than once, or not at all. You may need to drag the split bar between panes or scroll to view content.

NOTE: Each correct selection is worth one point.

Features

Environment

Security group

SharePoint library

Answer Area

Requirement	Feature
Ensure fastest response times for each company location.	Feature
Create test and production copies of the data and apps.	Feature



- A. Mastered
- B. Not Mastered

Answer: A

Explanation:

Features

Environment

Security group

SharePoint library

Answer Area

Requirement

Ensure fastest response times for each company location.  
Create test and production copies of the data and apps.

Feature

Environment

Security group

NEW QUESTION 8

- (Topic 2)  
What is a benefit of deploying Microsoft 365 and Dynamics 365 apps in the same tenant?

- A. Use Common Data Services to connect to application data.
- B. You only need to set up groups in Microsoft 365 for permissions to all data.
- C. Users can access both Microsoft 365 and Dynamics 365 by using Single Sign-on (SSO).

Answer: A

NEW QUESTION 9

- (Topic 2)  
A company uses Microsoft 365 and Dynamics 365 Sales. The company does not have any developers on its staff. You need to explain to the executives the benefits of using Power Platform apps. What are two benefits? Each correct answer presents a complete solution. NOTE: Each correct selection is worth one point.

- A. Users can send emails from Dynamics 365 Sales to their personal email addresses.
- B. Users can create Power Apps to create apps for different departments.
- C. Users can use Power Automate to share information between Microsoft 365 and Dynamics 365 Sales.
- D. The company must unify all the mobile devices to one vendor.

Answer: BC

NEW QUESTION 10

HOTSPOT - (Topic 2)  
A business is evaluating AI Builder. Which actions can you perform?  
For each of the following statements, select Yes if the statement is true. Otherwise, select No.  
NOTE: Each correct selection is worth one point.

Statement	Yes	No
You can use a text classification model in AI Builder to retrieve text and perform sentiment analysis for ServiceNow incidents.	<input type="radio"/>	<input type="radio"/>
You can tag Instagram posts that mention your new product.	<input type="radio"/>	<input type="radio"/>
You can send results about the number of mentions of your new product in Instagram to Power BI for inclusion on a dashboard.	<input type="radio"/>	<input type="radio"/>

- A. Mastered
- B. Not Mastered

Answer: A

Explanation:

Statement	Yes	No
You can use a text classification model in AI Builder to retrieve text and perform sentiment analysis for ServiceNow incidents.	<input checked="" type="radio"/>	<input type="radio"/>
You can tag Instagram posts that mention your new product.	<input checked="" type="radio"/>	<input type="radio"/>
You can send results about the number of mentions of your new product in Instagram to Power BI for inclusion on a dashboard.	<input checked="" type="radio"/>	<input type="radio"/>

NEW QUESTION 10

HOTSPOT - (Topic 2)

A company is evaluating Power Platform and has questions about the role that Common Data Service plays in using Power Apps and Power Automate. For each of the following statements, select Yes if the statement is true. Otherwise, select No.  
NOTE: Each correct selection is worth one point.

Statement	Yes	No
Model-driven apps require a Common Data Service database.	<input type="radio"/>	<input type="radio"/>
A flow instance can only access one Common Data Service database.	<input type="radio"/>	<input type="radio"/>
Canvas apps require a Common Data Service database.	<input type="radio"/>	<input type="radio"/>

- A. Mastered  
B. Not Mastered

Answer: A

Explanation:

Statement	Yes	No
Model-driven apps require a Common Data Service database.	<input checked="" type="radio"/>	<input type="radio"/>
A flow instance can only access one Common Data Service database.	<input checked="" type="radio"/>	<input type="radio"/>
Canvas apps require a Common Data Service database.	<input checked="" type="radio"/>	<input type="radio"/>

NEW QUESTION 15

DRAG DROP - (Topic 2)

A bank uses Power Platform apps and flows to support business processes. The company would like to use historical client data to predict whether a client's loan application is likely to be approved or rejected. You need to use AI Builder to implement the solution. Which four actions should you perform in sequence? To answer, move the appropriate actions from the list of actions to the answer area and arrange them in the correct order.

Actions

Publish the model.

Export data into AI Builder.

Train the model.

Import data into Common Data Service.

Use the model in PowerApps or Microsoft Flow.

Answer area

➤

⬅

⬆

⬆

- A. Mastered  
B. Not Mastered

Answer: A

Explanation:

Step 1: Import data into Common Data Service.  
AI Builder requires the use of Common Data Service, which is the data platform for PowerApps and allows you to store and manage business data. Common Data Service is the platform on which Dynamics 365 apps are built so if you're a Dynamics 365 customer, your data is already in Common Data Service.  
Step 2: Train the model Step 3: Publish the model  
The last step is to publish your model.  
Step 4: Use the model in PowerApps or Microsoft Flow.

NEW QUESTION 18

DRAG DROP - (Topic 3)

A company is using Power BI to build visualizations. The company's IT support team needs to know when to install Power BI Desktop on users' computers and where the Power BI Service will suffice to perform tasks. You need to recommend solutions for the company. What should you recommend? To answer, drag the appropriate components to the correct requirements. Each component may be used once, more than once, or

not at all. You may need to drag the split bar between panes or scroll to view content. NOTE: Each correct selection is worth one point.

Tools

Power BI Service only

Power BI Desktop only

Power BI Desktop or Power BI Service

Answer Area

Requirement

Create dashboards.

Create reports.

Create calculated columns.

Configure security.

Configure sharing.

Component

Tool

Tool

Tool

Tool

Tool

- A. Mastered
- B. Not Mastered

Answer: A

**Explanation:**  
In a Venn diagram comparing Power BI Desktop and the Power BI service, the area in the middle shows how the two overlap. Some tasks you can do in either Power BI Desktop or the service. The two sides of the Venn diagram show the features that are unique to the application and the service.

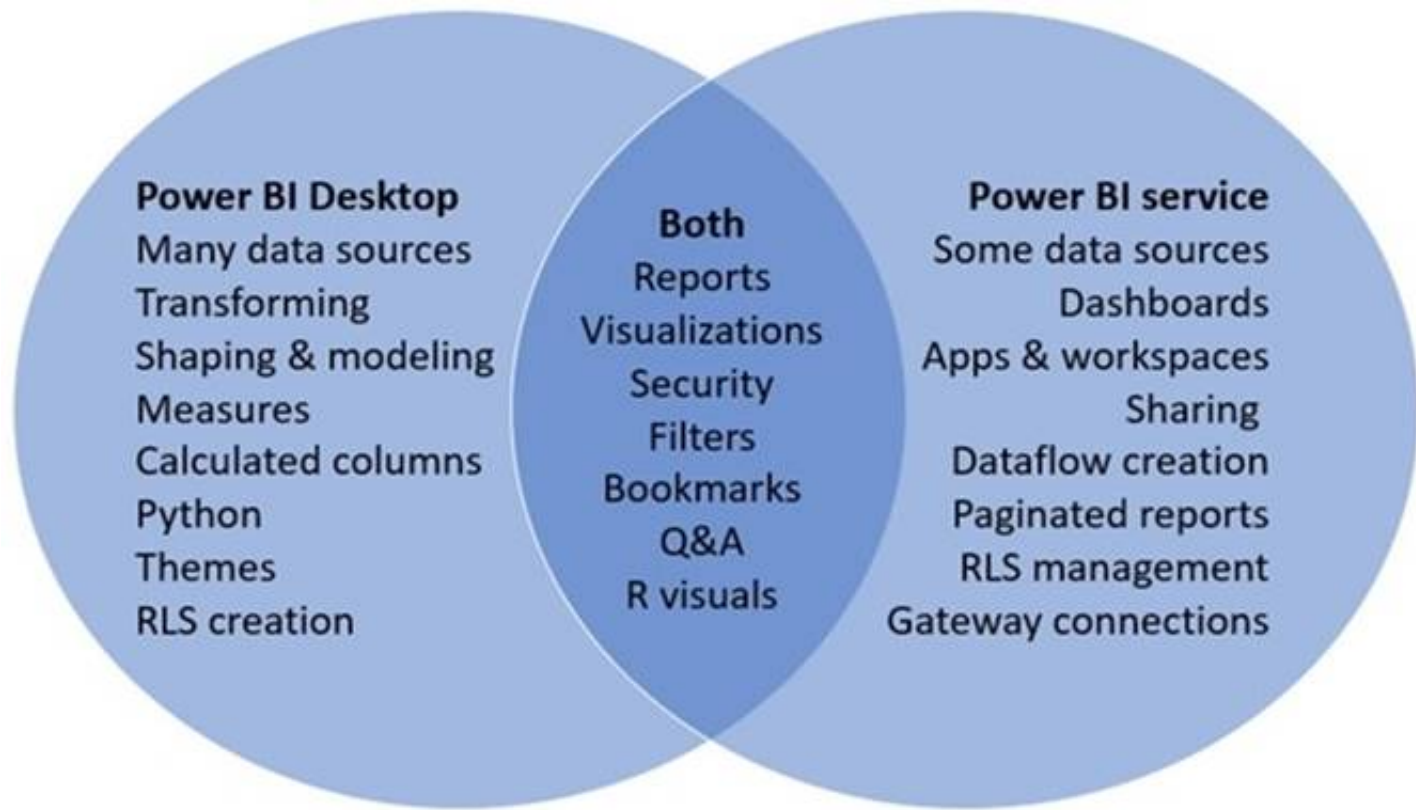

**NEW QUESTION 20**

- (Topic 3)  
A company manages a chain of retail stores. The company stores a list of retail store names and numbers in one Power BI table. The company stores sales transaction data including a transaction ID in another table. The transaction ID includes the store number. You need to show the store name for all retail transactions in all Power BI reports. Which tool should you use?

- A. Query Editor
- B. Power BI Service
- C. Microsoft Excel
- D. Data Connector

Answer: A

**Explanation:**  
Power BI Desktop comes with Query Editor, where you can connect to one or many data sources, shape and transform the data to meet your needs, then load that model into Power BI Desktop.  
Reference:  
<https://docs.microsoft.com/en-us/power-bi/desktop-query-overview>

**NEW QUESTION 25**

DRAG DROP - (Topic 3)  
A company needs to create a series of mobile applications to empower their field engineers to accomplish several tasks with varying degrees of complexity. Match each option to its answer. Instructions: To answer, drag the appropriate app type from the column on the left to its definition on the right. Each app type may be used once, more than once, or not at all. NOTE: Each correct match is worth one point.



App types	Answer Area	App type
<input type="text" value="model-driven"/>	<b>Definition</b>	<input type="text" value="App type"/>
<input type="text" value="dashboard"/>	Quickly create apps for very complex business processes with very little or no code.	
<input type="text" value="dataset"/>	Create simple apps with a highly customizable user interface layouts.	<input type="text" value="App type"/>
<input type="text" value="canvas"/>		

- A. Mastered  
B. Not Mastered

**Answer:** A

**Explanation:**

Box 1: canvas

Both model-driven and canvas apps allow you to easily build business apps. They both share access to the Common Data Service providing standard and custom entities. Canvas apps start with your user experience, crafting a highly tailored interface with the power of a blank canvas and connecting it to 200 data sources. Canvas apps can be built for web, mobile, and tablet applications. Model-driven apps start with your data model – building up from the shape of your core business data and processes in the Common Data Service to model forms, views, and other components. Model-driven apps automatically generate great UI that is responsive across devices.

Box 2: model-driven

**NEW QUESTION 28**

- (Topic 3)

You are using Dynamics 365 Sales.

You need to pull data into a Power BI report for your team. The City and State columns must be combined to form one column on the report.

Which function would you use? Each correct answer presents a complete solution. NOTE: Each correct selection is worth one point.

- A. Use Power Query to merge columns.  
B. Import the dat  
C. 18912E1457D5D1DDCBD40AB3BF70D5D  
D. Export data to Microsoft Excel.  
E. Create a view.

**Answer:** A

**Explanation:**

Reference:

<https://docs.microsoft.com/en-us/power-bi/desktop-shape-and-combine-data>

**NEW QUESTION 32**

- (Topic 3)

You are a sales representative. You create a Power BI report to visualize data from a Microsoft Excel workbook.

Users need to be able to view and share the report.

Which two actions should you perform? Each correct answer presents part of the solution. NOTE: Each correct selection is worth one point.

- A. Pin the report to a dashboard.  
B. Export the data.  
C. Publish the dashboard.  
D. Share the dashboard.

**Answer:** AD

**Explanation:**

Reference:

<https://docs.microsoft.com/en-us/power-bi/create-reports/service-dashboard-pin-live-tile-from-report>

<https://docs.microsoft.com/en-us/power-bi/collaborate-share/service-share-dashboards#limitations-andconsiderations>

**NEW QUESTION 33**

- (Topic 3)

A recent update has been made to a canvas app. The update has caused a negative impact to users. You need to roll back the app to a previous version. What should you do?

- A. Restore the previous version of the app.  
B. Uninstall the app for all users and reinstall by using the previous versions' package.  
C. Deactivate the live app, import the previous version of the app, and then activate the app.  
D. Delete the app and create a new app based on the previous version.

**Answer:** A

**Explanation:**

Restore a canvas app to a previous version in PowerApps. Restore an app from your account

? Open powerapps.com, and then click or tap Apps in the left navigation bar.

? Near the right edge, click or tap the info icon for the app that you want to restore.

? Click or tap the Versions tab, and then click or tap Restore for the version that you want to restore.



? In the confirmation dialog box, click or tap Restore. A new version is added to your list.

Reference:

<https://docs.microsoft.com/en-us/powerapps/maker/canvas-apps/restore-an-app>

#### NEW QUESTION 37

- (Topic 3)

You are creating Power BI reports.

You need to choose which filters you can use for reports.

Which three types of filters can you use? Each correct answer presents a complete solution.

NOTE: Each correct selection is worth one point.

- A. drill-down
- B. automatic
- C. database
- D. manual
- E. external

**Answer:** ABD

#### Explanation:

Reference:

<https://docs.microsoft.com/en-us/power-bi/power-bi-report-filter-types>

#### NEW QUESTION 38

- (Topic 3)

You need to display sales orders greater than a specific threshold in a Power BI report. What should you use?

- A. Common Data Service
- B. connector
- C. Power Query
- D. filter

**Answer:** D

#### NEW QUESTION 39

- (Topic 3)

You are using Dynamics 365 Sales.

You need to create a Power BI report that includes customer office locations. The City and State columns must be combined to form one column on the report. What should you do?

- A. Use Power Query Editor to merge columns.
- B. Import the data.
- C. Export data to Microsoft Excel.
- D. Create a view.

**Answer:** A

#### Explanation:

Reference:

<https://support.microsoft.com/en-us/office/merge-columns-power-query-80ec9e1e-1eb6-4048-b500-d5d42d9f0a8d>

#### NEW QUESTION 41

- (Topic 3)

This question requires that you evaluate the BOLD text to determine if it is correct.

You have a Power BI report with a page named RevReceived. The page shows revenue received by your company. You want to create an almost identical page that shows net revenue instead of gross revenue. To accomplish this task, you modify the RevReceived page.

Review the underlined text. If it makes the statement correct, “No change is needed”. If the statement is incorrect, select the answer choice that makes the statement correct.

- A. No change is needed.
- B. duplicate the RevReceived page.
- C. import the RevReceived page.
- D. copy the visuals from RevReceived to a new page.

**Answer:** B

#### Explanation:

Reference: [https://www.tutorialspoint.com/power\\_bi/power\\_bi\\_quick\\_guide.htm](https://www.tutorialspoint.com/power_bi/power_bi_quick_guide.htm)

#### NEW QUESTION 42

- (Topic 3)

You are a district manager for a large retail organization. You train each store manager to use Power BI to track sales and daily sales targets.

A store manager remembers learning about the Analyze in Excel option but cannot find the option in their Power BI dashboard.

You need to help the user resolve the issue. How should you advise the user?

- A. Install the Power BI Desktop app.
- B. Navigate to the report used by the dashboard.

- C. Select the Spotlight button on the dashboard tile.
- D. Subscribe to the dashboard and follow the email link.

Answer: B

Explanation:

Reference:  
<https://docs.microsoft.com/en-us/power-bi/collaborate-share/service-analyze-in-excel>

NEW QUESTION 45

HOTSPOT - (Topic 3)

A user is starting to learn about Power Apps.

Which objects should you use? To answer, select the appropriate options in the answer area.

NOTE: Each correct selection is worth one point.

A Power Apps app can call a

connector

flow

gateway

solution

Actions and triggers are properties of a

connector

flow

gateway

solution

- A. Mastered
- B. Not Mastered

Answer: A

Explanation:

A Power Apps app can call a

connector

flow

gateway

solution

Actions and triggers are properties of a

connector

flow

gateway

solution

NEW QUESTION 49

- (Topic 3)

You are creating visuals in Power BI.

You create area charts, pie charts, and donut charts that use your company's data. You need to display the charts to others at the company.

Which two objects can you add the charts to? Each correct answer presents a complete solution.

NOTE: Each correct selection is worth one point.

- A. Power BI service
- B. Power BI reports
- C. Power BI desktop
- D. Power BI dashboards

Answer: BD

Explanation:

Reference:  
<https://docs.microsoft.com/en-us/power-bi/visuals/power-bi-visualization-types-for-reports- and-q-and-a>

NEW QUESTION 53

DRAG DROP - (Topic 3)

You create a Power BI dashboard.

Match each option to its function. To answer, drag the appropriate option from the column on the left to its function on the right. Each option may be used once, more than once, or not at all.

NOTE: Each correct match is worth one point.

Products	Answer Area	
	Requirement	Product
<input type="text" value="Share"/>	Ensure that coworkers can see the dashboard.	<input type="text"/>
<input type="text" value="Embed"/>		
<input type="text" value="Get Data"/>	Display data from Microsoft Excel in the dashboard.	<input type="text"/>
<input type="text" value="Pin"/>		
<input type="text" value="Import"/>	Add a report tile to the dashboard.	<input type="text"/>

- A. Mastered  
B. Not Mastered

**Answer:** A

**Explanation:**

Products	Answer Area	
	Requirement	Product
<input type="text" value="Share"/>	Ensure that coworkers can see the dashboard.	<input type="text" value="Share"/>
<input type="text" value="Embed"/>		
<input type="text" value="Get Data"/>	Display data from Microsoft Excel in the dashboard.	<input type="text" value="Get Data"/>
<input type="text" value="Pin"/>		
<input type="text" value="Import"/>	Add a report tile to the dashboard.	<input type="text" value="Pin"/>

#### NEW QUESTION 58

- (Topic 3)

A carpet cleaning company uses Dynamics 365 Sales.

The process for entering customer information during onsite sales calls is very complicated.

The company

wants a simplified screen that allows salespeople to capture the customer name, phone number, and other information while speaking to the customer.

You need to recommend a solution that works on various types of mobile devices. What should you recommend?

- A. Common Data Service  
B. Microsoft Flow  
C. AI Builder  
D. Canvas app  
E. Power BI

**Answer:** D

**Explanation:**

Reference:

<https://powerapps.microsoft.com/en-us/build-powerapps/>

#### NEW QUESTION 60

- (Topic 3)

A company runs a call center to handle customer support inquiries.

The company tracks metrics including the number of incoming calls, call resolution rates, and escalations. The company wants to display the metrics on a shared screen that is visible to all call center staff.

You need to recommend a solution for the company. Which Power Platform feature should you recommend?

- A. AI Builder  
B. Power Automate  
C. Power Apps  
D. Power BI

**Answer:** D

#### NEW QUESTION 65

HOTSPOT - (Topic 3)

You are a regional sales manager for a large internet retailer. You create a series of Power BI reports and dashboards to help sales associates be more productive and increase sales.

Sales are not increasing as expected.

You need to determine if the new reports are being used and send emails to sales associates to provide guidance on how to use the reports and dashboards.

Which features should you use? To answer, select the appropriate options in the answer area.

NOTE: Each correct selection is worth one point.

### Requirement

Send an email to the sales associates on a predetermined schedule.

	▼
Subscribe	
Share	
Favorites	
Publisher	

Quantify the adoption usage from the sales associates.

	▼
Explore	
Favorites	
Usage metrics	
Performance inspector	

- A. Mastered
- B. Not Mastered

**Answer:** A

**Explanation:**

### Requirement

Send an email to the sales associates on a predetermined schedule.

	▼
Subscribe	
Share	
Favorites	
Publisher	

Quantify the adoption usage from the sales associates.

	▼
Explore	
Favorites	
Usage metrics	
Performance inspector	

### NEW QUESTION 66

- (Topic 3)

Your company has an on premises Microsoft SQL Server database that contains legacy sales data. You must display information from the database in a new Power Apps app.

You need to establish a secure connection between the database and the app.

What should you use?

- A. Data source
- B. App
- C. Gateway
- D. Flow

**Answer:** C

**Explanation:**

For an on-premises database, identify a data gateway that was shared with you (or create one).

Specify Connect using on-premises data gateway, type or paste the server name, the database name, the user name, and the password for the database that you want to use, and specify the authentication type and the gateway.

Reference:

<https://docs.microsoft.com/en-us/powerapps/maker/canvas-apps/connections/connection-azure-sqldatabase>

### NEW QUESTION 70

- (Topic 3)

What is a benefit of deploying Microsoft 365 and Dynamics 365 apps in the same tenant?

- A. You do not need to manually back up data.
- B. Both will use the same time zone.
- C. You can use Power BI to display data that comes from both environments.
- D. You can implement Single Sign-On (SSO).

**Answer:** C

**Explanation:**

Reference:



<https://docs.microsoft.com/en-us/power-platform/admin/use-power-bi>

**NEW QUESTION 71**

- (Topic 3)

You create a set of dashboards and reports for a project team that combines data from different sources in Power BI. Some of the data is considered sensitive. You need to distribute the dashboards and reports securely to the team. What should you create?

- A. a custom data connector
- B. a published app
- C. a Microsoft flow
- D. a Power BI workspace

**Answer:** B

**Explanation:**

Reference:

<https://docs.microsoft.com/en-us/power-bi/service-how-to-collaborate-distribute- dashboards-reports>

**NEW QUESTION 73**

DRAG DROP - (Topic 3)

A company plans to create an information portal that managers can use to view critical information about their teams.

You need to recommend the type of Power BI components that the company should use. What should you recommend? To answer, drag the appropriate components to the correct

requirements. Each component may be used once, more than once, or not at all. You may need to drag the split bar between panes or scroll to view content.

NOTE. Each correct selection is worth one point.

Component types	Requirement	Component type
<div>Dashboard</div>	Display data from a Microsoft Excel workbook that has multiple worksheets into one chart.	<div>Component type</div>
<div>Report</div>	Display the top departmental goal metrics and alert users when specific thresholds targets are met.	<div>Component type</div>
	Display Sales charts that can be filtered by region.	<div>Component type</div>

- A. Mastered
- B. Not Mastered

**Answer:** A

**Explanation:**

Box 1: Report

Reports are more detailed data displayed in many formats like chart, graphs list and in tabular, etc.

Box 2: Dashboard

Dashboards are a business key performance indicator view where it displays key values that can change business profits and can be glanced at one screen.

Box 3: Report

Power BI dashboards cannot slice and dice, but reports have many ways to filter and slice.

Note: Power BI dashboards are one placeholder to display the most important decision- making facts to run a business. But reports are more detailed data displayed in many formats like chart, graphs list and in tabular, etc. Reports are based on one dataset or one business unit data for example reports of a store belonging to California.

**NEW QUESTION 75**

DRAG DROP - (Topic 4)

You are creating a model-driven app to track requests for quotes. The app must use the following navigation structure:

Sales

? Sales Log

? Request for Quotes

? Projects

? Settings

? Customers

? Product Lines

? Sales Territories Administration

? User Admin

? Users

? Roles

You need to create the app navigation.

Which sitemap component types should you use? To answer, drag the appropriate component types to the correct navigation elements. Each component type may be used once, more than once, or not at all. You may need to drag the split bar between panes or scroll to view content.

NOTE: Each correct selection is worth one point.

Component types	Answer Area	
	Navigation element	Component type
<div>Area</div>	Administration	<div>Component type</div>
<div>Group</div>	Sales log	<div>Component type</div>
<div>Subarea</div>	Customers	<div>Component type</div>

- A. Mastered  
B. Not Mastered

Answer: A

Explanation:

Component types	Answer Area	
	Navigation element	Component type
<div>Area</div>	Administration	<div>Group</div>
<div>Group</div>	Sales log	<div>Subarea</div>
<div>Subarea</div>	Customers	<div>Subarea</div>

NEW QUESTION 78

- (Topic 4)  
You are creating a canvas app. You need to configure the app.  
Which two objects are provided by the connector? Each correct answer presents a complete solution.  
NOTE: Each correct selection is worth one point.

- A. customizations  
B. data sources  
C. actions  
D. tables  
E. triggers

Answer: CD

Explanation:

Reference:  
<https://docs.microsoft.com/en-us/powerapps/maker/canvas-apps/connections-list>

NEW QUESTION 79

DRAG DROP - (Topic 4)  
A company is considering implementing PowerApps to help manage business processes. Users are trying to understand the purposes and benefits of PowerApps components.  
Match each benefit to its tool. To answer, drag the appropriate benefit from the column on the left to its tool on the right. Each benefit may be used once, more than once, or not at all.  
NOTE: Each correct selection is worth one point.

Answer Area		
Tools	Benefit	Tool
<div>connectors</div>	Easy data integration	<div></div>
<div>canvas apps</div>	Low code / no code across applications	<div></div>
<div>AI Builder</div>	Easy to customize front end	<div></div>
<div>Power Automate</div>		
<div>portals</div>		

- A. Mastered
- B. Not Mastered

Answer: A

Explanation:

Tools

connectors

canvas apps

AI Builder

Power Automate

portals

Answer Area

Benefit

Easy data integration

Low code / no code across applications

Easy to customize front end

Tool

connectors

AI Builder

canvas apps

NEW QUESTION 84

DRAG DROP - (Topic 4)

A company plans to implement Power Apps in a Power Platform environment. You need to implement other required components. Match each option to its function. To answer, drag the appropriate option from the column on the left to its function on the right. Each option may be used once, more than once, or not at all.  
NOTE: Each correct match is worth one point.

Products

Microsoft Azure

custom connector

Microsoft Flow

model-driven app

canvas app

Answer Area

Function

Implement user authentication.

Send data to a Microsoft OneNote notebook in the same tenant.

Product

- A. Mastered
- B. Not Mastered

Answer: A

Explanation:

Products

Microsoft Azure

custom connector

Microsoft Flow

model-driven app

canvas app

Answer Area

Function

Implement user authentication.

Send data to a Microsoft OneNote notebook in the same tenant.

Product

Microsoft Azure

Microsoft Flow

NEW QUESTION 87

- (Topic 4)

A company has a Power Apps app that is used by most employees. The company is expanding to other countries/regions. You need to recommend a solution to translate text generated within the Power Apps in near real-time. What should you recommend?



- A. Microsoft Azure Synapse Analytics
- B. Microsoft Azure Cognitive Services
- C. Common Data Service connector
- D. Power BI

**Answer:** B

**Explanation:**

Reference:  
[https://docs.microsoft.com/en-gb/azure/cognitive-services/welcome?ocid=AID2339762\\_TWITTER\\_oo\\_spl100000827964250](https://docs.microsoft.com/en-gb/azure/cognitive-services/welcome?ocid=AID2339762_TWITTER_oo_spl100000827964250)  
<https://powerapps.microsoft.com/en-us/blog/cognitive-services-with-powerapps-using-custom-connectors/>

**NEW QUESTION 90**

- (Topic 4)  
A company uses Dynamics 365 Supply Chain Management.  
The company wants to build custom user interfaces that add additional functionality. You need to recommend a solution for the company.  
What should you recommend?

- A. Power BI
- B. Power Apps canvas apps
- C. AI Builder
- D. Microsoft Flow

**Answer:** B

**Explanation:**

Microsoft Power Apps provides a consistent experience for building apps and extending Office 365 and Dynamics 365. Investments include enhancements on Unified Interface, support for embedding canvas apps in model-driven apps and native support of the Common Data Service for Apps.  
Reference:  
<https://powerapps.microsoft.com/en-us/roadmap/>

**NEW QUESTION 93**

- (Topic 4)  
A company uses Microsoft 365, Power Platform, and Dynamics 365. You do not assign permissions to any licensed users.  
Users are able to create and edit Power Apps canvas apps.  
In which environment are users creating and editing the apps?

- A. Production
- B. Default
- C. Sandbox

**Answer:** C

**Explanation:**

Reference:  
<https://docs.microsoft.com/en-us/power-platform/admin/working-with-environments>

**NEW QUESTION 97**

HOTSPOT - (Topic 4)  
A user is creating their first canvas app in Power Apps.  
The user does not know what types of controls they can include. You need to recommend solutions for the user.  
Which types of controls would you recommend using in Power Apps? To answer, select the appropriate control in the dialog box in the answer area.  
NOTE: Each correct selection is worth one point.

Scenario	Control
View the date, time, and location of upcoming internal meetings.	<div><div></div><div>Meeting-screen template</div><div>Gallery</div><div>List box</div></div>
Create a meeting request from within the app.	<div><div></div><div>Meeting-screen template</div><div>Gallery</div><div>List box</div></div>
Drill down into customer contact records in Dynamics 365 Sales to view a photo of a customer you are meeting.	<div><div></div><div>Image</div><div>People-screen template</div><div>Add picture</div></div>

- A. Mastered
- B. Not Mastered

**Answer:** A

**Explanation:**

Box 1: Gallery  
A Gallery control can show multiple records from a data source, and each record can contain multiple types of data. For example, a Gallery control can show



multiple contacts with each item showing contact information that includes a name, an address, and a phone number for each contact.

Box 2: Meeting-screen template

In a canvas app, add a meeting screen that lets users create and send meeting requests from their Office 365 Outlook accounts. Users can search for attendees in their org and add external email addresses. If your tenant has meeting rooms built into Outlook, users can select a location as well.

Box 3: Image

If you add one or more Image controls to your app, you can show individual images that aren't part of a data set, or you can incorporate images from records in data sources.

**NEW QUESTION 98**

HOTSPOT - (Topic 4)

A company plans to build Power Apps portals.

For each of the following statements, select Yes if the statement is true. Otherwise, select No.

NOTE: Each correct selection is worth one point.

Statement	Yes	No
You must use standard templates for building portals.	<input type="radio"/>	<input type="radio"/>
You can test portals in non-prodcution environments and then migrate the portals into production environments.	<input type="radio"/>	<input type="radio"/>
When transitioning to the new version of a portal, you can display a customizable maintenance page until the new portal is ready to be used.	<input type="radio"/>	<input type="radio"/>

- A. Mastered
- B. Not Mastered

Answer: A

Explanation:

Statement	Yes	No
You must use standard templates for building portals.	<input checked="" type="radio"/>	<input type="radio"/>
You can test portals in non-prodcution environments and then migrate the portals into production environments.	<input checked="" type="radio"/>	<input type="radio"/>
When transitioning to the new version of a portal, you can display a customizable maintenance page until the new portal is ready to be used.	<input checked="" type="radio"/>	<input type="radio"/>

**NEW QUESTION 103**

- (Topic 4)

A company plans to create a canvas app that connects to three databases with different proprietary database formats. What is the minimum number of connectors required?

- A. 1
- B. 2
- C. 3

Answer: B

Explanation:

Reference:

<https://docs.microsoft.com/en-us/powerapps/maker/canvas-apps/working-with-data-sources>

**NEW QUESTION 104**

DRAG DROP - (Topic 4)

A company plans to create canvas apps.

What is the minimum number of connectors required? To answer, drag the appropriate number of connectors to the correct drop scenarios. Each number of connectors may be used once, more than once, or not at all. You may need to drag the split bar between panes or scroll to view content.

NOTE: Each correct selection is worth one point.

Number of connectors	Answer Area	Number of connectors
0	Scenario	
1	Synchronize data with three data sources that use different proprietary database formats.	
2	Create three Power Apps apps that each display data from a Microsoft SharePoint list.	
3	Create three Flows that each copy data to Microsoft Azure Data Lake on different schedules.	

- A. Mastered
- B. Not Mastered

Answer: A

Explanation:

Number of connectors	Answer Area	Number of connectors
0	Scenario	
1	Synchronize data with three data sources that use different proprietary database formats.	1
2	Create three Power Apps apps that each display data from a Microsoft SharePoint list.	3
3	Create three Flows that each copy data to Microsoft Azure Data Lake on different schedules.	3

NEW QUESTION 109

- (Topic 5)  
You are new to working with Microsoft Flow. You create a flow that extracts birth dates for users and then sends a birthday greeting email to users on their birthday. The flow does not properly extract birth dates. Where should you make changes?

- A. Connectors
- B. Expression
- C. Templates

Answer: A

Explanation:

Select the new Date Time connector. There you will see all of the actions, which help you to convert time zones to format them for local time in an email, add or subtract times, or just get the current time.  
Reference:  
<https://flow.microsoft.com/en-us/blog/nested-apply-to-each/>

NEW QUESTION 113

- (Topic 5)  
A company uses Dynamics 365 Customer Service. The company uses a manual process to manage call escalations. You must use Power Automate to automate the process for routing escalated calls. You need to create the flow. Which type of connector should you use?

- A. Microsoft Excel
- B. Common Data Service
- C. Office 365 Users

Answer: B

NEW QUESTION 117

HOTSPOT - (Topic 5)  
A company is using Power Automation to automate business processes. You need to recommend triggers for Instant flows. What trigger types should you recommend? To answer, select the appropriate options in the answer area.  
NOTE: Each correct selection is worth one point.

Requirement	Trigger type
Run a flow when the user presses a button in a canvas app.	<div><div></div><div>PowerApps for a selected row manually trigger a flow for a selected file (OneDrive for a Business)</div></div>
Run a flow when user presses a button in the mobile Flow app.	<div><div></div><div>PowerApps for a selected row manually trigger a flow for a selected file (SharePoint)</div></div>

- A. Mastered  
B. Not Mastered

Answer: A

Explanation:

Requirement	Trigger type
Run a flow when the user presses a button in a canvas app.	<div><div></div><div>PowerApps for a selected row manually trigger a flow for a selected file (OneDrive for a Business)</div></div>
Run a flow when user presses a button in the mobile Flow app.	<div><div></div><div>PowerApps for a selected row manually trigger a flow for a selected file (SharePoint)</div></div>

NEW QUESTION 119

HOTSPOT - (Topic 5)

You are learning about Power Apps and how to use triggers.

Which objects should you use? To answer, select the appropriate options in the answer area.

NOTE: Each correct selection is worth one point.

Answer Area

Statement	Component
A Power Apps app can trigger this when a condition is met.	<div><div></div><div>connector Power Automate flow gateway solution</div></div>
Actions and triggers are properties of a	<div><div></div><div>connector gateway solution</div></div>

- A. Mastered  
B. Not Mastered

Answer: A

Explanation:

Answer Area

Statement	Component
A Power Apps app can trigger this when a condition is met.	<div><div></div><div>connector Power Automate flow gateway solution</div></div>
Actions and triggers are properties of a	<div><div></div><div>connector gateway solution</div></div>

NEW QUESTION 123

- (Topic 5)

Users within a company use Flow for personal productivity.



Users often overwrite their working flows by editing the definitions and are unable to undo changes after saving a flow. You need to ensure that users can revert a flow to the current state. Which two options can you use? Each correct answer presents a complete solution. NOTE: Each correct selection is worth one point.

- A. Export
- B. Rename
- C. Save As
- D. Share

**Answer:** AC

**Explanation:**

A: You can export a flow as a package and import it into a different environment, or use it to restore the in the same environment at a later point in time.  
C: The ability to make a copy of your flow is often useful when you want to create a flow similar to something you've already created. Or, if you want to maintain a draft of your working flow as you work on adding more functionality.  
Here's how:  
Go to your My flows page. Click on the More (...) menu item next to the flow that you want to create a copy of. Click on the Save As command.  
Reference:  
<https://flow.microsoft.com/en-us/blog/import-export-bap-packages/> <https://flow.microsoft.com/en-us/blog/make-a-copy/>

**NEW QUESTION 126**

- (Topic 5)  
A company uses Dynamics 365 Sales. Every time an opportunity is created, a Power Automate flow runs to email the opportunity to the sales manager. The sales manager leaves the company. You disable all accounts for the sales manager. You need to ensure that the new sales manager automatically receives email about opportunities when they are created. What should you do?

- A. Modify the flow and ensure that the correct manager's email is listed in the From field.
- B. Modify the flow and ensure that the correct manager's email is listed in the To field.
- C. Grant the new sales manager access to the departed sales manager's inbox.
- D. Modify the flow and ensure that the flow prompts the user to type the correct email for the To field.
- E. Create a flow that automatically forwards opportunity emails to the new sales manager.

**Answer:** B

**Explanation:**

Reference:  
<https://www.inogic.com/blog/2020/09/power-automate-send-an-email-using-the-email-template-part-1/>

**NEW QUESTION 127**

DRAG DROP - (Topic 5)  
A company plans to use Microsoft Flow to automate tasks. Match each flow type to its function. To answer, drag the appropriate flow type from the column on the left to its description on the right. Each option may be used once, more than once, or not at all.  
NOTE: Each correct match is worth one point.

Flow types	Answer Area	
	Description	Flow type
automated		
business process	a flow that runs after it is triggered by an event	Flow type
scheduled	a flow that guides a user through a set of tasks	Flow type
instant	a flow that runs after a specified number of days	Flow type
	a flow that allows you to start tasks on-demand	Flow type

- A. Mastered
- B. Not Mastered

**Answer:** A

**Explanation:**

Box 1: automated  
Automated flows start with an event or trigger, such as an email being received. These also support a multitude of actions in the 200+ Flow connectors.  
Box 2: business process  
The business process flow that creates stages or screens that enforce a certain sequence of steps. It collects data from users for each step in the stage and can kick off automated workflows.  
Box 3: scheduled  
Scheduled flows run regular reports that are sent out to a team and summarize everything that's happened in the past week. This includes everything from simple daily scheduling to more complex scheduling like "every 3rd Monday."  
Box 4: instant  
An instant flow is triggered when you click a button inside of the Flow mobile app, SharePoint, Dynamics, PowerApps, or Excel that passes context directly into your flow.  
Note: There are four different Flow types that you can choose from when starting out. You can create a scheduled flow, automated flow, instant flow, or a business process flow.

**NEW QUESTION 131**



DRAG DROP - (Topic 5)  
You plan to use Microsoft Flow to monitor what people are saying about your company's products. You store the feedback for research and development purposes.  
You need to recommend Flow components to use for the solution.  
To answer, drag the appropriate components to the correct requirements. Each component may be used once, more than once, or not at all. You may need to drag the split bar between panes or scroll to view content.  
NOTE: Each correct selection is worth one point.

Components	Answer Area	Requirement	Component
action			
expression		Retrieve the top five posts from your company's Facebook page.	Component
service		Enter the resulting posts into the product database.	Component
trigger		Combine author and link fields into a single field.	Component
flow type		Run flow every hour.	Component

- A. Mastered
- B. Not Mastered

Answer: A

Explanation:

Box 1: Trigger  
A trigger is something that triggers or starts the workflow. It could be a new file uploaded to a document library, a new item created in the list or an email sent to your Inbox – something that will start (kick-off the workflow).  
There are two types of triggers:  
? Automatic trigger is pre-programmed into the workflow based on a certain rule (i.e. new document or item created, email sent, etc.)  
? Manual Trigger is a trigger initiated by a user. Unlike with automatic trigger above, the workflow will only start when initiated manually by the end user (for example, from the Document Library for a selected file). Manual trigger is only supported for certain types of workflows (i.e. Get feedback from your manager for the selected file)  
Box 2: action  
An action is something that occurs as a result of the workflow.  
Box 3: expression  
Sometimes users just need to do basic operations like getting the current time, adding numbers together, or replacing a part of a string of text. That's possible inline in any flow action. Microsoft Flow leverages the same Workflow Definition Language used by Azure Logic apps. For new users who are unfamiliar with the expression language, there is an inline help experience that shows how to use each expression as they build out their flow.  
Box 4: flow type  
There are four different Flow types that you can choose from when starting out. You can create a scheduled flow, automated flow, instant flow, or a business process flow.

NEW QUESTION 134

- (Topic 5)  
A company uses Dynamics 365 Supply Chain Management and Dynamics 365 Finance. User account data must be synchronized between the two system. You need to ensure that the synchronized data is stored in one place. What should you use?  
  
A. SQLServer  
B. Common Data Service  
C. Azure Active Directory  
D. Azure IoT Central

Answer: B

Explanation:

Reference:  
<https://docs.microsoft.com/en-us/power-platform/admin/data-integrator>

NEW QUESTION 138

- (Topic 5)  
You have Power Automate Flow to create a flow that automatically sends email to a project manager when project team members mark a task as complete. Project team members are prematurely marking tasks as complete. You must add quality control into the process by sending an email to a project lead for confirmation that the task is in fact complete before sending the email to the project manager.  
You need to modify the flow. Which component should you use?  
  
A. a process argument  
B. a condition  
C. an expression  
D. a trigger  
E. an action

Answer: B

Explanation:

Use a condition and set the action to send an email.  
Reference:  
<https://docs.microsoft.com/en-us/power-automate/add-condition>

NEW QUESTION 139

DRAG DROP - (Topic 5)  
You build a flow using a template. You want to add support for additional business scenarios.  
You need to ensure that the new workflow does not break existing functionality.  
Which flow editing utilities should you use? To answer, drag the appropriate tools to the correct requirements. Each tool may be used once, more than once, or not at all You may need to drag the split bar between panes or scroll to view content.  
NOTE: Each correct selection is worth one point.

Tools	Requirement	Tool
Test		
Flow Checker	Check the new flow for any errors or warnings.	Tool
	Run the flow using previously processed data.	Tool
	Monitor the flow as it is running.	Tool

- A. Mastered
- B. Not Mastered

Answer: A

Explanation:

Box 1: Flow Checker  
The Flow checker feature will promote higher quality flows by ensuring you follow best practices. By running the checker, you will be able to get answers to questions like: which areas of my flow implementation pose a performance or reliability risk?  
For each issue identified, the Flow checker points to specific occurrences within the flow where improvements may be required. And more importantly, you learn how to implement these improvements by following detailed guidance.  
Box 2: Test  
Box 3: Test

NEW QUESTION 140

- (Topic 5)  
A company uses Dynamics 365 Supply Chain Management.  
You need to use Microsoft Flow to automate the process of receiving and tracking raw materials.  
Which type of connector should you use?

- A. Common Data Service
- B. Dynamics 365
- C. Dynamics 365 for Fin & Ops
- D. Dynamic Signal

Answer: A

Explanation:

Dynamics 365 for Finance and Operations is now being licensed as Dynamics 365 Finance and Dynamics 365 Supply Chain Management.  
You can use Common Data Service to enable the flow of data between Finance and Operations apps and Dynamics 365 Sales.  
Reference:  
<https://docs.microsoft.com/en-us/dynamics365/fin-ops-core/dev-itpro/data-entities/data-integration-cds>

NEW QUESTION 145

- (Topic 5)  
You are building a Power Automate flow to manage sales.  
The sales team saves quotes as PDF files to a Microsoft OneDrive folder. You create a Microsoft SharePoint list to help the sales team manage follow ups to quotes. You need to copy the customer name, phone number, and the amount of the potential sale from the sales quote and insert the data into the SharePoint list. Which AI Builder model should you use?

- A. key phrase extraction
- B. sentiment analysis OC.
- C. text recognition
- D. language detection

Answer: C

Explanation:

Reference:  
<https://docs.microsoft.com/en-us/ai-builder/prebuilt-text-recognition>

NEW QUESTION 147

DRAG DROP - (Topic 5)  
You need to build a Power Virtual Agents chatbot for a company.  
Which components should you use? To answer, drag the appropriate components to the correct requirements. Each component may be used once, more than once, or not at all. You may need to drag the split bar between panes or scroll to view content.  
NOTE: Each correct selection is worth one point.

Components

Entity

Variable

Trigger Phrase

Answer Area

Requirement

Identify keywords or questions and relate them to issues.

Store a response that a user enters for later use.

Identify a specific type of information from a user response.

Component

Component

Component

- A. Mastered
- B. Not Mastered

Answer: A

Explanation:

Components

Entity

Variable

Trigger Phrase

Answer Area

Requirement

Identify keywords or questions and relate them to issues.

Store a response that a user enters for later use.

Identify a specific type of information from a user response.

Component

Trigger Phrase

Variable

Entity

NEW QUESTION 149

DRAG DROP - (Topic 5)  
A company provides on-site architectural consulting services to residential and business customers. The company wants to implement a simple alert system where a consultant can press a button on their mobile device to send the user's location to the company as a text notification.  
You need to build a button flow that sends the notification.  
In which order should you perform the actions? To answer, move all actions from the list of actions to the answer area and arrange them in the correct order.

Actions

Add a new step to the flow.

Add a trigger.

Select a connector and action to send text notifications.

Set the actions properties.

Save the flow.

Answer Area

- A. Mastered
- B. Not Mastered

Answer: A

Explanation:

Actions	Answer Area
Add a new step to the flow.	Add a new step to the flow.
Add a trigger.	Select a connector and action to send text notifications.
Select a connector and action to send text notifications.	Set the actions properties.
Set the actions properties.	Add a trigger.
Save the flow.	Save the flow.

#### NEW QUESTION 154

- (Topic 5)

A company builds and sells residential apartments. The company uses Dynamics 365 Sales to manage sales opportunities. Management must receive notifications on their mobile devices when sales opportunities are created.

You need to select recommend Power Platform components to address the requirements. Which two components should you recommend? Each correct answer presents part of the solution.

NOTE: Each selection is worth one point.

- A. Common Data Service connector
- B. Power BI
- C. Power Automate
- D. AI Builder

**Answer:** AC

#### Explanation:

Reference:

<https://www.powerobjects.com/blog/2019/04/05/flow-approval-process/>

#### NEW QUESTION 157

- (Topic 5)

You have a Power Automate flow that saves attachments from emails into OneDrive for Business. You need to determine why the flow is not working.

What are three possible ways to achieve the goal? Each correct answer presents a complete solution. NOTE: Each correct selection is worth one point.

- A. Navigate to the Power Automate web portal and click view notifications.
- B. Enable Repair Tips for the flow.
- C. Navigate to the Action Items section of the Power Automate portal.
- D. Navigate to the Power Automate admin center and view the projects.
- E. Navigate to the flow and view the run history.

**Answer:** BCE

#### Explanation:

Reference:

<https://docs.microsoft.com/en-us/power-automate/fix-flow-failures>

#### NEW QUESTION 162

- (Topic 6)

You create a Power Virtual Agents chatbot for a company.

The management wants to learn about the effectiveness of the chatbot.

You need to identify the percentage of customers who stop responding to prompts from the chatbot.

Which report should you view?

- A. Customer satisfaction
- B. Engagement over time
- C. Escalation rate drivers
- D. Session outcomes overtime

**Answer:** B

#### Explanation:

Reference:

<https://docs.microsoft.com/en-us/power-virtual-agents/teams/analytics-csat-teams>

#### NEW QUESTION 166

HOTSPOT - (Topic 6)

You are authoring a Power Virtual Agents chatbot for a company.



For each of the following statements, select Yes if the statement is true. Otherwise, select No.  
NOTE: Each correct selection is worth one point.

Statements	Yes	No
You must create a custom action to display a knowledge base article that answers a common support question.	<input type="radio"/>	<input type="radio"/>
You can use Power Automate to retrieve a customer's contact number in order to verify they are an authorized user and their support plan SLA.	<input type="radio"/>	<input type="radio"/>

- A. Mastered
- B. Not Mastered

Answer: A

Explanation:

Statements	Yes	No
You must create a custom action to display a knowledge base article that answers a common support question.	<input type="radio"/>	<input checked="" type="radio"/>
You can use Power Automate to retrieve a customer's contact number in order to verify they are an authorized user and their support plan SLA.	<input checked="" type="radio"/>	<input type="radio"/>

NEW QUESTION 167

- (Topic 6)  
You are building a Power Virtual Agents chatbot for a company.  
You are working with an existing topic and would like to call an action. Which technology is available to perform the action?

- A. Power Virtual Agent Entity
- B. Power Apps
- C. Power Automate
- D. Power BI

Answer: C

Explanation:

Reference:  
<https://docs.microsoft.com/en-us/power-virtual-agents/advanced-flow>

NEW QUESTION 170

HOTSPOT - (Topic 6)  
You are developing a Power Virtual Agents chatbot for a company.  
For each of the following statements, select Yes if the statement is true. Otherwise, select No.  
NOTE: Each correct selection is worth one point.

Statement	Yes	No
You must create a topic to specify how a chatbot responds to a user.	<input type="radio"/>	<input type="radio"/>
You can use prebuilt entities or custom defined entities.	<input type="radio"/>	<input type="radio"/>

- A. Mastered
- B. Not Mastered

Answer: A

Explanation:

Statement	Yes	No
You must create a topic to specify how a chatbot responds to a user.	<input checked="" type="radio"/>	<input type="radio"/>
You can use prebuilt entities or custom defined entities.	<input checked="" type="radio"/>	<input type="radio"/>

NEW QUESTION 173

- (Topic 6)  
You are planning to allow members of your team to test your chatbot. You must ensure this is done in a secure way.  
A team member named User1 must test the chatbot. You need to ensure that User1 can complete testing. What should you do?

A. Sign in to the authoring environment as the chatbot author.  
B. Sign in to Microsoft Azure DevOps as the chatbot author.  
C. Sign in to Microsoft Azure DevOps as User1.  
D. Sign in to the authoring environment as User1.

Answer: A

NEW QUESTION 174

HOTSPOT - (Topic 7)  
You are building Power BI visualizations for a team.  
For each of the following statements, select Yes if the statement is true. Otherwise, select No.  
NOTE: Each correct selection is worth one point.

Statements	Yes	No
Power BI can only retrieve data from up to two different sources for each dashboard.	<input type="radio"/>	<input type="radio"/>
Power BI visualizations can be used in canvas apps and model driven apps.	<input type="radio"/>	<input type="radio"/>
Power BI can display charts and list boxes on dashboards.	<input type="radio"/>	<input type="radio"/>

- A. Mastered  
B. Not Mastered

Answer: A

Explanation:

Statements	Yes	No
Power BI can only retrieve data from up to two different sources for each dashboard.	<input checked="" type="radio"/>	<input type="radio"/>
Power BI visualizations can be used in canvas apps and model driven apps.	<input type="radio"/>	<input checked="" type="radio"/>
Power BI can display charts and list boxes on dashboards.	<input checked="" type="radio"/>	<input type="radio"/>

NEW QUESTION 175

HOTSPOT - (Topic 7)  
A company plans to implement Power Platform solutions.  
For each of the following statements, select Yes if the statement is true. Otherwise, select No.  
NOTE: Each correct selection is worth one point.

Answer Area		
	Yes	No
Users can interact with canvas apps directly in Microsoft SharePoint and Teams.	<input type="radio"/>	<input type="radio"/>
Users can interact with model-driven apps directly in Microsoft SharePoint and Teams.	<input type="radio"/>	<input type="radio"/>

- A. Mastered
- B. Not Mastered

Answer: A

Explanation:

Answer Area		
	Yes	No
Users can interact with canvas apps directly in Microsoft SharePoint and Teams.	<input checked="" type="radio"/>	<input type="radio"/>
Users can interact with model-driven apps directly in Microsoft SharePoint and Teams.	<input type="radio"/>	<input checked="" type="radio"/>

NEW QUESTION 176

- (Topic 7)  
A company currently does not separate testing, development, and production as per standard Application Lifecycle Management (ALM) protocol. The company uses Power for accounting and sales processes. The company needs login only one login account per user. The company also must prevent developing and testing from impacting production. You need to implement a solution to meet the requirements. Which method should you select?

- A. separate Microsoft Azure Storage Blobs
- B. separate connectors
- C. separate tenants
- D. separate environments

Answer: D

NEW QUESTION 179

- (Topic 7)  
A company plans to move an on-premises customer service data management system to a cloud-managed solution. The customer service application must be replaced by a model-driven application. The company uses Microsoft SQL Server Integration Services (SSIS) packages to move data from the on-premises database system to a third-party enterprise resource planning (ERP) system. You need to replace the SSIS packages for data transfer. What should the company use in place of the packages to move the data?

- A. Microsoft Azure Data Lake
- B. Power Virtual Agents
- C. Data Migration Framework
- D. Power Platform connector

Answer: C

NEW QUESTION 182

HOTSPOT - (Topic 7)  
You are authoring a Power Virtual Agents bot for a company that sells flowers and shrubs. For each of the following statements, select Yes if the statement is true. Otherwise, select No. NOTE: Each correct selection is worth one point.

Statement	Yes	No
You can use the prebuilt Postal Code entity to recommend plants that will work within a customer’s growing zone.	<input type="radio"/>	<input type="radio"/>
You can create a custom entity to offer color and plant choices for landscaping options that can be made available for customer orders.	<input type="radio"/>	<input type="radio"/>

- A. Mastered
- B. Not Mastered

Answer: A



**Explanation:**

Box 1: Yes

Chatbots built with Power Virtual Agents will understand and display content that's locally relevant to the user. Localized handling and formatting are based on the user's browser locale setting, and include the following elements within a chat conversation:

- ? Date and time
- ? Numbers
- ? ZIP or postal code
- ? Currency
- ? Speed

Box 2: Yes Custom entities:

The prebuilt entities cover commonly used information types, but on some occasions, such as when building a bot that serves a specific purpose, you'll need to teach the bot's language understanding model some domain-specific knowledge.

For instance, let's say you want to build a bot for an outdoor store. In this case, you'll need to teach the bot to acknowledge the "outdoor gears product" category in a dialog.

**NEW QUESTION 186**

- (Topic 7)

A company uses a custom-built system to record financial data that runs on a manager's machine.

The system does not have an API. New customer details must be manually entered into the system by the manager from a central spreadsheet. The user interface of the system contains the complex business logic that is needed for the manual customer data entry process.

You need to ensure that new customer details can be entered into the system automatically by using Power Automate.

Which type of flow should you create?

- A. business process
- B. desktop
- C. automated cloud
- D. instant cloud

**Answer: B**

**NEW QUESTION 187**

DRAG DROP - (Topic 7)

A company creates a new instance of Microsoft Dataverse to store customer information.

Customer service agents require a simple, three-screen canvas app to interact with the Dataverse data.

You need to create the app.

Which four actions should you perform in sequence? To answer, move the appropriate actions from the list of actions to the answer area and arrange them in the correct order.

**Actions**

Choose whether to connect directly or through an on-premises data gateway.

Select Dataverse from the Start from section.

Create a Dataverse connection.

Choose a table.

Switch to the environment with Dataverse.

>

<

**Answer Area**

↑

↓

- A. Mastered
- B. Not Mastered

**Answer: A**

**Explanation:**

**Actions**

Choose whether to connect directly or through an on-premises data gateway.

Select Dataverse from the Start from section.

Create a Dataverse connection.

Choose a table.

Switch to the environment with Dataverse.

>

<

**Answer Area**

Select Dataverse from the Start from section.

Create a Dataverse connection.

Choose a table.

Switch to the environment with Dataverse.

↑

↓

**NEW QUESTION 192**

- (Topic 7)

A company uses a model-driven app for their mobile sales activities.

The company wants to modify the view that is used for sales orders. You must apply a new default filter to the view. You must also modify the default sorting for sales orders.

You need to make the changes to the view.

In which three locations can you make the changes? Each correct answer presents a complete solution.

NOTE: Each correct selection is worth one point.

- A. Power Apps site
- B. Solution Explorer
- C. Microsoft Azure DevOps
- D. App Designer

**Answer: ACD**

**Explanation:**



You can edit or remove a filter condition through the Power Apps site. You can create and edit Analytics views in Azure DevOps.  
An alternative to editing views in the tables is to edit views from the app designer.  
Reference:  
<https://docs.microsoft.com/en-us/powerapps/maker/model-driven-apps/create-edit-view-filters>  
<https://docs.microsoft.com/en-us/azure/devops/report/powerbi/analytics-views-create> <https://docs.microsoft.com/en-us/powerapps/maker/model-driven-apps/create-edit-views-app-designer>

**NEW QUESTION 197**

DRAG DROP - (Topic 7)

You need to create a mobile application which will allow sales associates to enter customer sales leads.  
Which four actions should you perform in sequence? To answer, move the appropriate actions from the list of actions to the answer area and arrange them in the correct order.

Actions

Save the app.

Add components to the app.

Publish the app.

Add flows to the app.

Go to the Office 365 admin center.

Create a new Power Apps app.

>

<

Answer area

↑

↓

- A. Mastered
- B. Not Mastered

Answer: A

Explanation:

Actions

Save the app.

Add components to the app.

Publish the app.

Add flows to the app.

Go to the Office 365 admin center.

Create a new Power Apps app.

>

<

Answer area

Create a new Power Apps app.

Add components to the app.

Save the app.

Publish the app.

↑

↓

**NEW QUESTION 199**

- (Topic 7)

A company is creating a chatbot to replace a frequently asked questions (FAQ) site  
You must perform step-by-step testing for al scenarios that are part of a complex user interaction that includes multiple topics. Testers must be able to see the workflow while interacting with the chatbot.  
You need to test the chatbot. What should you do?

- A. Publish the chatbot and test it in the demo website.
- B. Use the chatbot designer to test the chatbot
- C. View analytics for a chatbot conversation.
- D. Publish the chatbot and test it in any channel

Answer: B

Explanation:

Test and maintain chatbots through an incredibly easy-to-use graphical interface. Recognize and act on dozens of common entities in the user’s conversation such as colors, currencies, ages, dates and times, or create your own, and store user information in variables and use them to branch or create complex conversations.

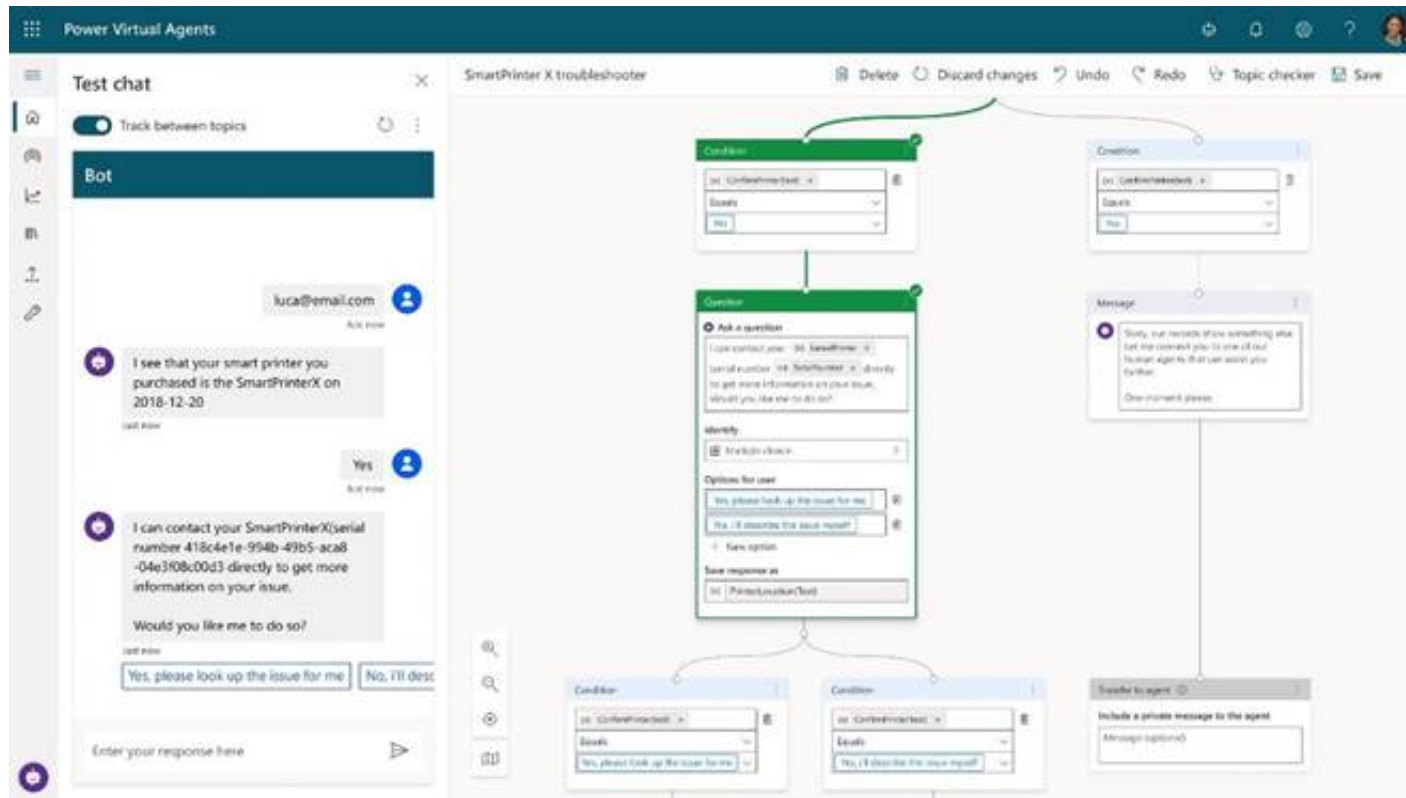

<https://powervirtualagentsblogcdn.azureedge.net/wp-content/uploads/2019/11/Tracking.png>

### NEW QUESTION 200

- (Topic 7)

You are developing reports for a company.

You must create visualizations that include the following data:

? Invoices due from a third-party enterprise resource planning (ERP) system

? Number of calls made to the client from Microsoft Dataverse

? Microsoft Excel file data

The reports must be displayed in a single page. You need to create the visualizations.

What should you use?

- A. deployment pipelines
- B. tables
- C. columns
- D. dashboards

**Answer: D**

### NEW QUESTION 204

- (Topic 7)

A company is using Power Virtual Agents with Dynamics 365 Customer Service. You create a new topic. The topic performs as expected during testing.

Customers report that the new topic is not visible in the frequently asked questions section of the company's website.

You need to ensure customers can see the new topic. What should you do?

- A. Analyze the chatbot
- B. Paste the link to the website
- C. Publish the topic.
- D. Create a new variable.
- E. Delete and recreate the topic.

**Answer: C**

### NEW QUESTION 207

- (Topic 7)

You are using the Power BI service to view a visual on a report that has been shared with you. You need to add the visual to a dashboard as a tile. Which action should you perform?

- A. Copy
- B. Spotlight
- C. Export data
- D. Pin

**Answer: D**

### NEW QUESTION 210

HOTSPOT - (Topic 7)

You are creating Power BI visualizations.

You need to display the visuals where a user can perform each function.

Which solution should you use? To answer, select the appropriate option in the answer area.

NOTE: Each correct selection is worth one point.

Answer Area

Requirement

Solution

Make decisions by analyzing high-level KPIs.

▼

Power BI service

Power BI Desktop

Power BI dashboards

Drill down into the details of a visual.

▼

Power BI reports

Power BI Desktop

Power BI dashboards

- A. Mastered
- B. Not Mastered

Answer: A

Explanation:

Answer Area

Requirement

Solution

Make decisions by analyzing high-level KPIs.

▼

Power BI service

Power BI Desktop

Power BI dashboards

Drill down into the details of a visual.

▼

Power BI reports

Power BI Desktop

Power BI dashboards

Text, letter  
Description automatically generated

NEW QUESTION 212

- (Topic 7)  
A company stores its customer warranty information in Microsoft Dataverse. Authenticated and authorized customers must be able to access their own warranty information without requiring a user-assigned Microsoft Power Platform license. You need to share warranty information with these customers. What should you use?

- A. Canvas app
- B. Model-driven app
- C. Power BI report
- D. Power Pages site

Answer: D

NEW QUESTION 214

HOTSPOT - (Topic 7)  
For each of the following statements, select Yes if the statement is true. Otherwise, select No.  
NOTE: Each correct selection is worth one point.

Answer Area

Statement	Yes	No
Power Virtual Agent chatbots can be created directly in Microsoft Teams.	<input type="radio"/>	<input type="radio"/>
Power Virtual Agent chatbots can use the bot testing feature directly within Microsoft Teams.	<input type="radio"/>	<input type="radio"/>

- A. Mastered
- B. Not Mastered

Answer: A

Explanation:

Answer Area

Statement	Yes	No
Power Virtual Agent chatbots can be created directly in Microsoft Teams.	<input checked="" type="radio"/>	<input type="radio"/>
Power Virtual Agent chatbots can use the bot testing feature directly within Microsoft Teams.	<input type="radio"/>	<input checked="" type="radio"/>

NEW QUESTION 217

- (Topic 7)

The front desk of a hotel uses a model-driven app to check in guests. The hotel wants to create a canvas app for the housekeeping staff to manage cleaning supplies. The canvas app will connect to a new instance of Microsoft Dataverse. You need to create a new environment for the housekeeping staff. What should you use?

- A. Microsoft Azure portal
- B. Power Apps maker portal
- C. Microsoft 365 admin center
- D. Microsoft Power Platform admin center

Answer: D

NEW QUESTION 218

- (Topic 7)

You develop a Power Virtual Agents chatbot in a Microsoft Teams channel named Expenses. You need to identify the operations the chatbot can perform. Which two actions can the chatbot perform? Each correct answer presents a complete solution. NOTE: Each correct selection is worth one point.

- A. Transfer a chat to a live person if the chatbot cannot answer the question.
- B. Staff who are not members of the Expenses team can use the chatbot.
- C. Trigger a request for approval from a senior manager for high-value expenses.
- D. Upload and process a PDF file.

Answer: BC

NEW QUESTION 221

HOTSPOT - (Topic 7)

A tutoring company has developed and deployed a model-driven app for the administration staff and a canvas app for teachers. Instructions: For each of the following statements, select Yes if the statement is true. Otherwise, select No. NOTE: Each correct selection is worth one point.

Answer Area

Statements	Yes	No
Teachers can access the canvas app by using desktops and mobile devices.	<input type="radio"/>	<input type="radio"/>
Only assignments of security roles are required for canvas app access.	<input type="radio"/>	<input type="radio"/>
Administration staff can create personal views and dashboards in the model-driven app.	<input type="radio"/>	<input type="radio"/>

- A. Mastered
- B. Not Mastered

Answer: A

Explanation:

Answer Area

Statements	Yes	No
Teachers can access the canvas app by using desktops and mobile devices.	<input checked="" type="radio"/>	<input type="radio"/>
Only assignments of security roles are required for canvas app access.	<input type="radio"/>	<input checked="" type="radio"/>
Administration staff can create personal views and dashboards in the model-driven app.	<input checked="" type="radio"/>	<input type="radio"/>

NEW QUESTION 224



HOTSPOT - (Topic 7)  
A company plans to implement Microsoft Power Platform apps. The company does not plan to use any development tools or plug-ins. Which actions can you perform?  
For each of the following statements, select Yes if the statement Is true. Otherwise, select No.  
NOTE: Each correct selection is worth one point.

Statement	Yes	No
You can synchronize account information from Dynamics 365 Sales with a third-party database.	<input type="radio"/>	<input type="radio"/>
You can create invoices from orders and then send the invoices to the customer by using a Power Automate flow.	<input type="radio"/>	<input type="radio"/>

- A. Mastered
- B. Not Mastered

Answer: A

Explanation:

Statement	Yes	No
You can synchronize account information from Dynamics 365 Sales with a third-party database.	<input checked="" type="radio"/>	<input type="radio"/>
You can create invoices from orders and then send the invoices to the customer by using a Power Automate flow.	<input checked="" type="radio"/>	<input type="radio"/>

NEW QUESTION 226

DRAG DROP - (Topic 7)  
You are assigning record level privileges for Power Apps and Model-Driven Apps. Which privilege should you use to ensure access for each scenario? To answer, drag the appropriate privileges to the correct requirements. Each privilege may be used once, more than once, or not at all. You may need to drag the split bar between panes or scroll to view content.  
NOTE: Each correct selection is worth one point.

Privileges	Requirement	Privilege
Append	Allow users to grant access to a record they own to other users.	
Assign	Grant ownership of a record to another user.	
Share	Allow the users to associate the current record with another record.	

- A. Mastered
- B. Not Mastered

Answer: A

Explanation:

Privileges	Requirement	Privilege
Append	Allow users to grant access to a record they own to other users.	Share
Assign	Grant ownership of a record to another user.	Assign
Share	Allow the users to associate the current record with another record.	Append

NEW QUESTION 229

- (Topic 7)  
A company is implementing Power Automate to streamline operations. The head of customer support relations needs a Power Automate flow that texts a manager when an email meets the following criteria:  
• The email is sent as high priority.  
• The email is from a customer.  
You need to identify how the flow's decision point will know whether the criteria are met. What should you use?

- A. data operations
- B. expressions
- C. variables
- D. actions
- E. triggers

Answer: C

NEW QUESTION 234

- (Topic 7)  
You create a model-driven app for a department. You need to make the model-driven app available to other department members. Which two methods should you use? Each correct answer presents a complete solution.  
NOTE: Each correct selection is worth one point.

- A. Publish the app to AppSource.
- B. Send the application's Web URL to other team members by email.
- C. Deploy the application to other user's instances through PowerShell.
- D. Use the Share feature in the Power Apps designer.

Answer: AD

NEW QUESTION 238

HOTSPOT - (Topic 7)

You are authoring a Power Virtual Agents chatbot for a company for each of the following statements, select Yes if the statement is true. Otherwise, select No.  
NOTE: Each correct selection is worth one point.

Statement	Yes	No
When escalating to a live person from a chatbot, the customer must restate their issue and other information collected.	<input type="radio"/>	<input type="radio"/>
You can customize the greeting topic for every chatbot that you author.	<input type="radio"/>	<input type="radio"/>

- A. Mastered
- B. Not Mastered

Answer: A

Explanation:

Statement	Yes	No
When escalating to a live person from a chatbot, the customer must restate their issue and other information collected.	<input type="radio"/>	<input checked="" type="radio"/>
You can customize the greeting topic for every chatbot that you author.	<input checked="" type="radio"/>	<input type="radio"/>

NEW QUESTION 240

HOTSPOT - (Topic 7)

A company is evaluating ways to connect Power Platform apps to external services to perform complex activities. For each of the following statements, select Yes if the statement is true. Otherwise, select No. NOTE: Each correct selection is worth one point.

Answer Area

Statement	Yes	No
You can create a canvas app that scans and parses documents using Azure Cognitive Services and then adds the appropriate information to Dynamics 365 Sales.	<input type="radio"/>	<input type="radio"/>
You can create a canvas app that uses Azure Cognitive Services to read incident records and identify tickets that need to be escalated based on sentiment score.	<input type="radio"/>	<input type="radio"/>

- A. Mastered
- B. Not Mastered

Answer: A

Explanation:

Answer Area

Statement	Yes	No
You can create a canvas app that scans and parses documents using Azure Cognitive Services and then adds the appropriate information to Dynamics 365 Sales.	<input checked="" type="radio"/>	<input type="radio"/>
You can create a canvas app that uses Azure Cognitive Services to read incident records and identify tickets that need to be escalated based on sentiment score.	<input checked="" type="radio"/>	<input type="radio"/>

NEW QUESTION 241

- (Topic 7)

A company uses Microsoft 365. SharePoint Online, and Dynamics 365 Sales.  
You need to recommend tools to build a solution that meets the following requirements:

- Synchronize data daily (rom an external Microsoft SQL Server instance.
  - Send a report automatically to specific company executives.
  - Ensure that opportunities over a specified amount are approved by a sales manager.
- Which two tools of components should you recommend? Each correct answer presents pan of the solution NOTE: Each correct selection is worth one point.

- A. Microsoft Word
- B. Common Data Service
- C. Power Automate
- D. Microsoft Excel
- E. Power BI

**Answer:** AE

**NEW QUESTION 242**

DRAG DROP - (Topic 7)

You need to explain the major components of the Common Data Model (CDM) and their functions.

Match each term to its definition.

Instructions: To answer, drag the appropriate term from the column on the left to its definition on the right. Each term may be used once, more than once, or not at all. Each correct match is worth one point.

NOTE: Each correct selection is worth one point.

Tools		Answer Area	
		Purpose	Tool
Entities	Data connectors	Helps jumpstart application development by leveraging business logic, security, and integrations	
Common Data Service	Common Data Model	A set of records used to store data	
Workflows			

- A. Mastered
- B. Not Mastered

**Answer:** A

**Explanation:**

Tools		Answer Area	
		Purpose	Tool
Entities	Data connectors	Helps jumpstart application development by leveraging business logic, security, and integrations	Common Data Service
Common Data Service	Common Data Model	A set of records used to store data	Entities
Workflows			

**NEW QUESTION 245**

- (Topic 7)

User1 creates several Power BI dashboards for a company. User1 shares a dashboard with User2 who works for another company. User2 reports that she is able to view the dashboard User2 forwards the email containing the dashboard sharing link that she received to User3.

User3 reports that he receives an error message when he selects the link to view the dashboard. User3 can view a dashboard that he has created.

You need to determine why User 3 receives an error. What is the issue?

- A. Forwarding the email does not share the dashboard with User3.
- B. User3 is running an out-of-date version of Power BI and must upgrade to a newer version.
- C. User1 is signed in using the wrong organizational account for Power BID- User2 is signed in to the dashboard and must sign out before User3 can sign in

**Answer:** A

**NEW QUESTION 248**

DRAG DROP - (Topic 7)

A company plans to implement Power BI.

The company wants to implement some specific features that Power BI does not include. You need to recommend solutions for the company.

What should you recommend? To answer, drag the appropriate solutions to the correct requirement. Each solution may be used once, more than once, or not at all. You may need to drag the split bar between panes or scroll to view content.

NOTE: Each correct selection is worth one point.

Solutions	Answer Area	
	Requirement	Solution
Microsoft AppSource	Evaluate solutions that meet current gaps in Power BI capabilities.	Solution
Microsoft Lifecycle Services	Evaluate the services of multiple companies to identify a partner that can assist in building a proof-of-concept solution.	Solution
Microsoft Azure Marketplace		

- A. Mastered
- B. Not Mastered

**Answer:** A

**Explanation:**

Solutions	Requirement	Solution
Microsoft AppSource	Evaluate solutions that meet current gaps in Power BI capabilities.	Microsoft AppSource
Microsoft Lifecycle Services	Evaluate the services of multiple companies to identify a partner that can assist in building a proof-of-concept solution.	Microsoft AppSource
Microsoft Azure Marketplace		

NEW QUESTION 250

- (Topic 7)

A company is building an interactive chatbot to answer questions about products and product warranties You need to create conversation paths re questions about product warranties. Which tool should you use?

- A. Azure Bot Framework
- B. Power Platform admin center
- C. Conversation node
- D. Authoring canvas
- E. Power Virtual Agents portal

Answer: E

NEW QUESTION 251

HOTSPOT - (Topic 7)

You are building Power BI visualizations for a team.

For each of the following statements, select Yes if the statement is true. Otherwise, select No.

NOTE: Each correct selection is worth one point.

Answer Area	Statement	Yes	No
	Power BI can only retrieve data from up to two different sources for each dashboard.	<input type="radio"/>	<input type="radio"/>
	Power BI visualizations can be used in canvas apps and model driven apps.	<input type="radio"/>	<input type="radio"/>
	Power BI can display charts and list boxes on dashboards.	<input type="radio"/>	<input type="radio"/>

- A. Mastered
- B. Not Mastered

Answer: A

Explanation:

Answer Area	Statement	Yes	No
	Power BI can only retrieve data from up to two different sources for each dashboard.	<input checked="" type="radio"/>	<input type="radio"/>
	Power BI visualizations can be used in canvas apps and model driven apps.	<input checked="" type="radio"/>	<input type="radio"/>
	Power BI can display charts and list boxes on dashboards.	<input checked="" type="radio"/>	<input type="radio"/>

NEW QUESTION 255

HOTSPOT - (Topic 7)

A company plans to implement Power BI.

Instructions: For each of the following statements, select Yes if the statement is true. Otherwise, select No.

NOTE: Each correct selection is worth one point.

Answer Area	Statements	Yes	No
	Power BI Report Builder is the only tool used to create reports to be published to the Power BI service.	<input type="radio"/>	<input type="radio"/>
	Power BI service can include calculated columns.	<input type="radio"/>	<input type="radio"/>
	Power BI Desktop can include calculated columns.	<input type="radio"/>	<input type="radio"/>

- A. Mastered
- B. Not Mastered

Answer: A

Explanation:



Answer Area

Statements	Yes	No
Power BI Report Builder is the only tool used to create reports to be published to the Power BI service.	<input type="radio"/>	<input checked="" type="radio"/>
Power BI service can include calculated columns.	<input type="radio"/>	<input checked="" type="radio"/>
Power BI Desktop can include calculated columns.	<input checked="" type="radio"/>	<input type="radio"/>

NEW QUESTION 257

DRAG DROP - (Topic 7)

A customer service department uses Microsoft Dynamics 365 Customer Service to manage repair requests. The repair team tracks their efforts using a Microsoft SharePoint list. The company must use Microsoft Power Platform to connect the repair team with the Dynamics 365 Customer Service solution. The solution must meet the following requirements:

Requirement Number	Requirement
Requirement 1	From a custom page in the Dynamics 365 interface, allow the customer service team to input a repair number, view the details of the corresponding SharePoint list item, and add notes for the repair team.
Requirement 2	Create a report that visualizes real-time customer service information that the repair team can access online and use to create dashboards.
Requirement 3	Automatically send a Microsoft Teams message to a customer service agent and an email to the customer when a repair team member completes a repair.

You need to implement the appropriate technologies to meet the requirements. Which technologies should you use? To answer, drag the appropriate technologies to the correct scenarios. Each technology may be used once, more than once, or not at all. You may need to drag the split bar between panes or scroll to view content. NOTE: Each correct selection is worth one point.

Technologies

Microsoft Power BI

Canvas app

Microsoft Power Automate

Microsoft Power Virtual Agents chatbot

Answer Area

Scenario

Requirement 1

Requirement 2

Requirement 3

Technology

- A. Mastered
- B. Not Mastered

Answer: A

Explanation:

Technologies

Microsoft Power BI

Canvas app

Microsoft Power Automate

Microsoft Power Virtual Agents chatbot

Answer Area

Scenario

Requirement 1

Requirement 2

Requirement 3

Technology

Microsoft Power Automate

Microsoft Power BI

Microsoft Power Virtual Agents chatbot

NEW QUESTION 258

- (Topic 7)

You overwrite a Power Automate flow by editing the definition and saving the changes. You need to be able to revert a flow to the current state. Which two options can you use? Each correct answer presents a complete solution. NOTE: Each correct selection is worth one point.

- A. Save As
- B. Rename
- C. Export
- D. Share

Answer: AC

NEW QUESTION 261

HOTSPOT - (Topic 7)

For each of the following statements, select Yes if the statement is true. Otherwise, select No. NOTE: Each correct selection is worth one point.

Answer Area

Statement	Yes	No
You can embed a canvas app in a Microsoft Forms form to collect user feedback.	<input type="radio"/>	<input type="radio"/>
You can embed a canvas app within a Microsoft Excel worksheet to allow users to interact with data in a structured way.	<input type="radio"/>	<input type="radio"/>
You can embed a canvas app within a Power Platform model-driven app.	<input type="radio"/>	<input type="radio"/>

- A. Mastered
- B. Not Mastered

Answer: A

Explanation:

Answer Area

Statement	Yes	No
You can embed a canvas app in a Microsoft Forms form to collect user feedback.	<input checked="" type="radio"/>	<input type="radio"/>
You can embed a canvas app within a Microsoft Excel worksheet to allow users to interact with data in a structured way.	<input type="radio"/>	<input checked="" type="radio"/>
You can embed a canvas app within a Power Platform model-driven app.	<input checked="" type="radio"/>	<input type="radio"/>

NEW QUESTION 265

HOTSPOT - (Topic 7)

Instructions: For each of the following statements, select Yes if the statement is true. Otherwise, select No.  
NOTE: Each correct selection is worth one point.

	Yes	No
You can customize buttons and menu items in canvas apps but cannot reorder the screens.	<input type="radio"/>	<input type="radio"/>
You can add sections to your canvas app forms at any time. Screens can only be added when the canvas app is created.	<input type="radio"/>	<input type="radio"/>
You can edit buttons in a Power Apps app only by using a third-party application.	<input type="radio"/>	<input type="radio"/>

- A. Mastered
- B. Not Mastered

Answer: A

Explanation:

Box 1: No

You can reorder screens.

In the left navigation bar, hover over a screen that you want to move up or down, select the ellipsis button that appears, and then select Move up or Move down.

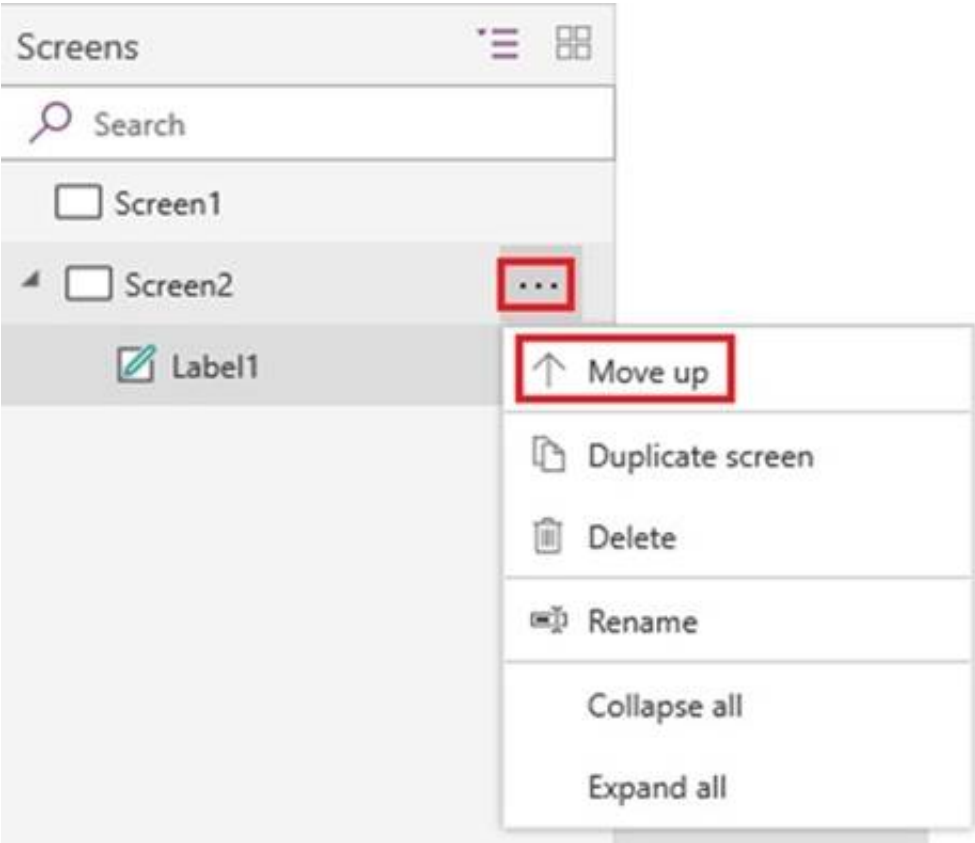

Box 2: No  
You can add screens to the app after it has been created.

Box 3: No  
For example, you can change a button's shape. By default, Power Apps creates a rectangular Button control with rounded corners. You can make basic modifications to the shape of a Button control by setting its Height, Width, and Radius properties.

NEW QUESTION 268

HOTSPOT - (Topic 7)

Instructions: For each of the following statements, select Yes if the statement is true. Otherwise, select No.  
NOTE: Each correct selection is worth one point.

Answer Area

Statements	Yes	No
You can connect to external resources with Power BI Desktop but not with the Power BI service.	<input type="radio"/>	<input type="radio"/>
You can build and edit Power BI reports by using Power BI Desktop or the Power BI service.	<input type="radio"/>	<input type="radio"/>
The only way to distribute a Power BI Desktop report is by sending the PBIX file to others.	<input type="radio"/>	<input type="radio"/>

- A. Mastered
- B. Not Mastered

Answer: A

Explanation:

Answer Area

Statements	Yes	No
You can connect to external resources with Power BI Desktop but not with the Power BI service.	<input checked="" type="radio"/>	<input type="radio"/>
You can build and edit Power BI reports by using Power BI Desktop or the Power BI service.	<input checked="" type="radio"/>	<input type="radio"/>
The only way to distribute a Power BI Desktop report is by sending the PBIX file to others.	<input type="radio"/>	<input checked="" type="radio"/>

NEW QUESTION 269

HOTSPOT - (Topic 7)

For each of the following statements, select Yes if the statement is true, Otherwise, select No.  
NOTE: Each correct selection is worth one point.

Answer Area

Statement	Yes	No
Power Apps apps can run only on mobile devices.	<input type="radio"/>	<input type="radio"/>
Power Apps can run only with Dynamic 365 products.	<input type="radio"/>	<input type="radio"/>
If a user runs a Power Apps app that accesses information to which the user does not have access, the app grants the user permissions.	<input type="radio"/>	<input type="radio"/>

- A. Mastered
- B. Not Mastered

Answer: A

Explanation:

Answer Area	
Statement	YesNo
Power Apps apps can run only on mobile devices.	<input type="radio"/> <input checked="" type="radio"/>
Power Apps can run only with Dynamic 365 products.	<input type="radio"/> <input checked="" type="radio"/>
If a user runs a Power Apps app that accesses information to which the user does not have access, the app grants the user permissions.	<input checked="" type="radio"/> <input type="radio"/>

NEW QUESTION 272

HOTSPOT - (Topic 7)

A user is creating their first Power Apps canvas app.

Which types of controls should you use for each scenario? To answer, select the appropriate options in the answer area.

NOTE: Each correct selection is worth one point.

Answer Area	
Scenario	Control
View the date, time, and location of upcoming internal meetings.	Meeting-screen template Gallery List box
Create a meeting request from within the app.	Meeting-screen template Gallery List box
Drill down into customer contact records in Dynamics 365 Sales to view a photo of a customer you are meeting.	Image People-screen template Add picture

- A. Mastered
- B. Not Mastered

Answer: A

Explanation:

Answer Area	
Scenario	Control
View the date, time, and location of upcoming internal meetings.	Meeting-screen template Gallery List box
Create a meeting request from within the app.	Meeting-screen template Gallery List box
Drill down into customer contact records in Dynamics 365 Sales to view a photo of a customer you are meeting.	Image People-screen template Add picture

NEW QUESTION 275

DRAG DROP - (Topic 7)

A manufacturing company is building a model-driven app to manage its warehouse. The app has two custom tables: Order and Batch.

You need to identify the appropriate component for each required function of the app. Which component should you choose for each function? To answer, drag the appropriate

components to the correct functions. Each component may be used once, more than once,

or not at all. You may need to drag the split bar between panes or scroll to view content. NOTE: Each correct selection is worth one point.

Components	Answer Area	
Business process flow Business rule Dashboard View	Function	Component
	Display a set of charts visualizing the order and batch data at the same time.	
	Guide users through the standard process of picking and shipping an order.	
	Show a list of all orders and allow users to reorder the columns.	
	Make the shelf number mandatory on a form when a user records the aisle location of a batch.	

- A. Mastered
- B. Not Mastered

Answer: A

Explanation:



Components

Business process flow

Business rule

Dashboard

View

Answer Area

Function

Display a set of charts visualizing the order and batch data at the same time.

Guide users through the standard process of picking and shipping an order.

Show a list of all orders and allow users to reorder the columns.

Make the shelf number mandatory on a form when a user records the aisle location of a batch.

Component

Dashboard

Business process flow

View

Business rule

NEW QUESTION 276

- (Topic 7)  
You are developing a Microsoft Power Platform solution. The solution uses data stored in Microsoft Excel, a Microsoft Dataverse database, and an Azure SQL database.  
You must create several visuals to enable the data to display on a screen without moving the data out of its source location.  
You need to create the visuals. Which tool should you use?

- A. Power Virtual Agents
- B. Power Automate
- C. Power BI
- D. Power Platform Center of Excellence Starter Kit

Answer: C

NEW QUESTION 278

HOTSPOT - (Topic 7)  
You are creating a model-driven app. You need to add forms to the app.  
Which form types should you use> To answer, select the appropriate options in the answer area.  
NOTE: Each correct selection is worth one point.

Requirement	Form type
a compact form for mobile devices	<div><div></div><div>Card</div><div>Quick Create</div><div>Quick View</div></div>
a basic form for data entry	<div><div></div><div>Main</div><div>Quick Create</div><div>Quick View</div></div>
a compact form for use in web clients to edit records	<div><div></div><div>Advanced Find Views</div><div>Associated Views</div><div>Lookup Views</div><div>Public Views</div></div>

- A. Mastered
- B. Not Mastered

Answer: A

Explanation:

Requirement	Form type
a compact form for mobile devices	<div><div></div><div>Card Quick Create Quick View</div></div>
a basic form for data entry	<div><div></div><div>Main Quick Create Quick View</div></div>
a compact form for use in web clients to edit records	<div><div></div><div>Advanced Find Views Associated Views Lookup Views Public Views</div></div>

**NEW QUESTION 280**  
HOTSPOT - (Topic 7)  
For each of the following statements, select Yes if the statement is true. Otherwise, select No.  
NOTE: Each correct selection is worth one point.

Statements	Yes	No
Sharing a model-driven app with a user is the only security required for users to access the app.	<input type="radio"/>	<input type="radio"/>
You can change the order of the columns in a view once you have created and published a view.	<input type="radio"/>	<input type="radio"/>
System views must be shared for everyone to view them.	<input type="radio"/>	<input type="radio"/>

- A. Mastered
- B. Not Mastered

**Answer:** A  
**Explanation:**  
Yes, No, No

**NEW QUESTION 284**  
- (Topic 7)  
You are creating a canvas app to enable users to order tickets. You create an input field for users to input the number of tickets to order. Users must order a maximum of four tickets and a minimum of two tickets. If a user enters a number except 2, 3, or 4, the input field must display in red. If a user enters the numbers 2, 3, or 4, the input field must display in green. You need to color the input field based on the user input. What should you use?

- A. formula
- B. calculated column
- C. gallery
- D. connector

**Answer:** A

**NEW QUESTION 285**  
HOTSPOT - (Topic 7)  
\_\_\_\_\_. You want to create a Power Apps app that allows you to define a custom Sitemap. What should you do? To answer, select the appropriate options in the answer area.

- A. Mastered
- B. Not Mastered

**Answer:** A  
**Explanation:**

Navigate to the Power Apps portal and create

a canvas app.  
a model-driven app.  
a portal app.  
an app by using a template.

NEW QUESTION 290

HOTSPOT - (Topic 7)

For each of the following statements, select Yes if the statement is true. Otherwise, select No. NOTE: Each correct selection is worth one point.

Answer Area

Statement	Yes	No
Security roles are modified in Microsoft Azure Active Directory.	<input type="radio"/>	<input type="radio"/>
Security Roles are assigned to each table.	<input type="radio"/>	<input type="radio"/>

- A. Mastered
- B. Not Mastered

Answer: A

Explanation:

Answer Area

Statement	Yes	No
Security roles are modified in Microsoft Azure Active Directory.	<input type="radio"/>	<input checked="" type="radio"/>
Security Roles are assigned to each table.	<input checked="" type="radio"/>	<input type="radio"/>

NEW QUESTION 292

HOTSPOT - (Topic 7)

You ate creating a model-driven app.

Instructions: For each of the following statements, select Yes if the statement is true. Otherwise, select No.

NOTE: Each correct selection is worth one point.

Answer Area

	Yes	No
To add entities to an app, entities are dragged onto the app canvas from the components area.	<input type="radio"/>	<input type="radio"/>
View definition is created in the component area of the app designer.	<input type="radio"/>	<input type="radio"/>
You must save, validate, and publish your app for others to see the changes.	<input type="radio"/>	<input type="radio"/>

- A. Mastered
- B. Not Mastered

Answer: A

Explanation:

Answer Area

	Yes	No
To add entities to an app, entities are dragged onto the app canvas from the components area.	<input type="radio"/>	<input checked="" type="radio"/>
View definition is created in the component area of the app designer.	<input checked="" type="radio"/>	<input type="radio"/>
You must save, validate, and publish your app for others to see the changes.	<input checked="" type="radio"/>	<input type="radio"/>

NEW QUESTION 297

DRAG DROP - (Topic 7)

A company is creating a canvas app to manage weekly status reports from users about projects.

Status reports must be created weekly. Users can enter project tasks with descriptions. Users can also add escalation requests for tasks that are late or at risk.

When a status report is submitted with an escalation request the app must automatically send a text message to the submitter's manager. A reminder must be sent at 8 PM on Sunday to everyone who has not yet submitted a status report for the previous week.

You need to identify the appropriate components to use in the solution.

What should you use? To answer, drag the appropriate implementation mechanisms to the correct requirements. Each implementation mechanism may be used once, more than once, or not at all. You may need to drag the split bar between panes or scroll to view content

NOTE: Each correct selection is worth one point

Implementation Mechanisms

Actions

Triggers

Conditions

Business process flows

Answer Area

Action	Implementation Mechanism
Automatically send a text message based on the report submission.	
Automatically send a reminder at 8 PM based on a missing status report.	

- A. Mastered
- B. Not Mastered

Answer: A

Explanation:

Implementation Mechanisms

Actions

Triggers

Conditions

Business process flows

Answer Area

Action	Implementation Mechanism
Automatically send a text message based on the report submission.	Triggers
Automatically send a reminder at 8 PM based on a missing status report.	Actions

NEW QUESTION 298

HOTSPOT - (Topic 7)

A company plans to create Power Platform apps that use industry-standard and proprietary data sources. For each of the following statements, select Yes if the statement is true. Otherwise, select No.

NOTE: Each correct selection is worth one point.

Answer Area

Statement	Yes	No
Custom connectors can be used if a standard connector for the service is available.	<input type="radio"/>	<input type="radio"/>
Custom connectors are supported in instant flows only.	<input type="radio"/>	<input type="radio"/>
Standard and custom connectors can be mixed within the same flow or app.	<input type="radio"/>	<input type="radio"/>

- A. Mastered
- B. Not Mastered

Answer: A

Explanation:

Answer Area

Statement	Yes	No
Custom connectors can be used if a standard connector for the service is available.	<input checked="" type="radio"/>	<input type="radio"/>
Custom connectors are supported in instant flows only.	<input type="radio"/>	<input checked="" type="radio"/>
Standard and custom connectors can be mixed within the same flow or app.	<input checked="" type="radio"/>	<input type="radio"/>

NEW QUESTION 303

DRAG DROP - (Topic 7)

A company uses Microsoft Power Apps and Microsoft Azure to modernize its mobile workforce. The company needs to identify solutions for three use cases:

- \* An app to audit retail store displays with a tablet-specific layout for its unique screen dimensions
- \* An app to create sales orders that uses business process flows
- \* An app to display product information that uses data for a Microsoft Dataverse instance, Microsoft Excel, and Microsoft Sharepoint

You need to identify the correct app types to use.



Which apps should you use? To answer, drag the appropriate app types to the correct apps. Each app type may be used once, more than once, or not at all. You may need to drag the split bar between panes or scroll to view content.  
NOTE: Each correct selection is worth one point.

App types

Logic

Canvas

Model-driven

Answer Area

App

App to audit retail store displays

App to create sales orders

App to display product information

App type

- A. Mastered
- B. Not Mastered

Answer: A

Explanation:

App types

Logic

Canvas

Model-driven

Answer Area

App

App to audit retail store displays

App to create sales orders

App to display product information

App type

Canvas

Model-driven

Canvas

NEW QUESTION 305

- (Topic 7)  
You create a multi-page Power BI report for an organization. You must enable salespeople in the organization to use the report to view data relevant to their sales region only. You need to enable security for the report. What should you use?

- A. Microsoft Trust Center
- B. row-level security
- C. data loss prevention policies
- D. sensitivity labels
- E. Microsoft Azure Active Directory

Answer: B

NEW QUESTION 306

HOTSPOT - (Topic 7)  
You are creating a Power Automate approval flow. Instructions: For each of the following statements, select Yes if the statement is true. Otherwise, select No.  
NOTE: Each correct selection is worth one point.

Statements	Yes	No
The addition of an expense report to a Microsoft OneDrive folder can initiate an approval flow.	<input type="radio"/>	<input type="radio"/>
Approvals must follow a sequential order of approval.	<input type="radio"/>	<input type="radio"/>

- A. Mastered
- B. Not Mastered

Answer: A

Explanation:

Box 1: Yes  
Box 2: No  
Parallel approvals, integrated approvals, and unanimous approvals are also allowed.

NEW QUESTION 307

- (Topic 7)  
You build a custom AI Builder model and use it in Power Automate cloud flows. Users report that they are not able to use the model in their flows. You need to allow users to access the model in their flows. Which action should you perform on the model?

- A. edit
- B. share
- C. train
- D. publish

Answer: C

NEW QUESTION 309

- (Topic 7)

A company is evaluating ways that they can implement AI Builder.  
For which two scenarios can you use AI Builder? Each correct selection presents a complete solution.  
NOTE: Each correct selection is worth one point.

- A. Send emails to all ai users who subscribe to a service.
- B. Synchronize data from an external database.
- C. Collect data from several data sources and display a dashboard that shows trending data.
- D. Interpret images and perform an action on the image.
- E. Detect patterns in data and predict outcomes

Answer: BD

NEW QUESTION 313

DRAG DROP - (Topic 7)

You create a Power Pages site to share Microsoft Dataverse data with external customer. Customer must be authenticated to view data.  
Which component should you use for each requirement? To answer, drag the appropriate component to the correct requirements. Each component may be used more once than once, or not at all. You may need to drag the spilt bar between panes or scroll to view content.

Components

Form

iFrame

List

Section

Answer Area

Requirement

Collect data from customers and store the data in a table.

Display multiple rows from a table.

Component

- A. Mastered
- B. Not Mastered

Answer: A

Explanation:

Components

Form

iFrame

List

Section

Answer Area

Requirement

Collect data from customers and store the data in a table.

Display multiple rows from a table.

Component

Form

List

NEW QUESTION 316

HOTSPOT - (Topic 7)

A company plans to use Power Platform to build apps that address specific business challenges. You need to recommend the appropriate types of Power Apps to use. What should you recommend? To answer, select the appropriate options in the answer area.  
NOTE: Each correct selection Is worth one point

Answer Area

Scenario

Field technicians need a mobile app to capture the location and the image of defective products.

Sales representatives need to see different views and dashboards in the sales app.

Tool

Canvas app

Power Apps Portals

Common Data Service

Canvas app

Model-driven app

Power Apps Portals

- A. Mastered
- B. Not Mastered

Answer: A

Explanation:

Passing Certification Exams Made Easy

visit - <https://www.surepassexam.com>

Answer Area

Scenario

Field technicians need a mobile app to capture the location and the image of defective products.  
Sales representatives need to see different views and dashboards in the sales app.

Tool

Canvas app

Power Apps Portals

Common Data Service

Canvas app

Model-driven app

Power Apps Portals

NEW QUESTION 318

- (Topic 7)  
A hotel develops a housekeeping checklist for its housekeeping staff to use when they finish cleaning a room.  
The housekeeping staff must be able to use their mobile device to add a check mark for each completed task and take a picture of the prepared bed.  
The results of the checklist for each room must be stored in a SharePoint list.  
You need to select the Microsoft Power Platform component that fulfills the requirement. Which component should you select?

- A. Power Pages site
- B. Power Virtual Agents Chabot
- C. Power BI report
- D. Model-driven app
- E. Canvas app

Answer: E

NEW QUESTION 319

HOTSPOT - (Topic 7)  
A company uses Microsoft Dataverse to manage business data.  
You need to import data into Dataverse from other data sources by using dataflows.  
For each of the following statement, select Yes if the statement is true. Otherwise, select No.  
NOTE: Each correct selection is worth one point.

Answer Area

Statements	Yes	No
You can access data sources in a dataflow by using the connectors that are used with Power Automate.	<input type="radio"/>	<input type="radio"/>
You can use Power Query to shape and transform the data in a dataflow.	<input type="radio"/>	<input type="radio"/>
You can run dataflows on a schedule to refresh the data in Dataverse.	<input type="radio"/>	<input type="radio"/>

- A. Mastered
- B. Not Mastered

Answer: A

Explanation:

Answer Area

Statements	Yes	No
You can access data sources in a dataflow by using the connectors that are used with Power Automate.	<input checked="" type="radio"/>	<input type="radio"/>
You can use Power Query to shape and transform the data in a dataflow.	<input checked="" type="radio"/>	<input type="radio"/>
You can run dataflows on a schedule to refresh the data in Dataverse.	<input checked="" type="radio"/>	<input type="radio"/>

NEW QUESTION 320

- (Topic 7)  
A user requests removal of the fax column from the following form in a model-driven app:

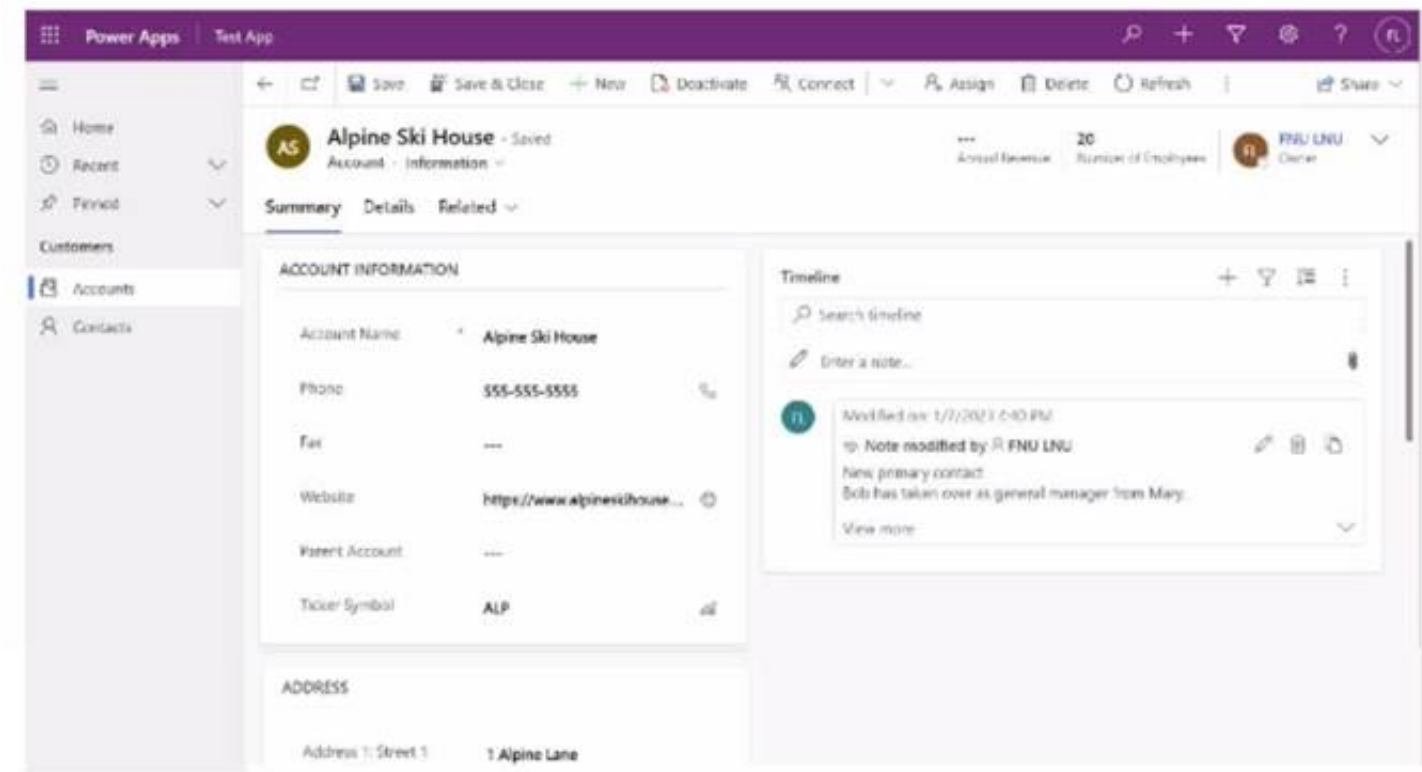

You need to remove the fax column.  
Which from should you open in the app designer?

- A. Alpine Ski House
- B. Summary
- C. Information
- D. Account

Answer: D

NEW QUESTION 325

HOTSPOT - (Topic 7)

Instructions: For each of the following statements, select Yes if the statement is true. Otherwise, select No.  
NOTE: Each correct selection is worth one point.

Answer Area

	Yes	No
The date and time are the triggers for a scheduled cloud flow.	<input type="radio"/>	<input type="radio"/>
Cloud flows must be exported to a Microsoft Excel file to copy them to another environment.	<input type="radio"/>	<input type="radio"/>
Users must create desktop flows to share them without being an administrator.	<input type="radio"/>	<input type="radio"/>

- A. Mastered
- B. Not Mastered

Answer: A

Explanation:

Answer Area

	Yes	No
The date and time are the triggers for a scheduled cloud flow.	<input type="radio"/>	<input checked="" type="radio"/>
Cloud flows must be exported to a Microsoft Excel file to copy them to another environment.	<input type="radio"/>	<input checked="" type="radio"/>
Users must create desktop flows to share them without being an administrator.	<input type="radio"/>	<input checked="" type="radio"/>

NEW QUESTION 327

DRAG DROP - (Topic 7)

A company uses Microsoft power platform to manage support tickets.  
Customers submit support requests by sending an email to a support email address.  
All high-priority emails must be logged into a Microsoft Excel sheet for historical purposes. You need to identify the components that are required for logging the email in Excel. Which components should you use? To answer, drag the appropriate components to the correct requirements. Each component may be used once, more than once, or not at all. You may need to drag the spilt bar between panes or scroll to view content.  
Note: Each correct selection is worth one point.



Components

Action

Connector

Trigger

Answer Area

Requirement

Start a workflow when an email is sent to a specific email address.

Evaluate whether an email is high priority in the flow by using a condition.

Create a row in Excel with information about incoming high-priority email.

Component

- A. Mastered
- B. Not Mastered

Answer: A

Explanation:

Components

Action

Connector

Trigger

Answer Area

Requirement

Start a workflow when an email is sent to a specific email address.

Evaluate whether an email is high priority in the flow by using a condition.

Create a row in Excel with information about incoming high-priority email.

Component

Trigger

Action

Connector

NEW QUESTION 328

.....

## Thank You for Trying Our Product

### We offer two products:

1st - We have Practice Tests Software with Actual Exam Questions

2nd - Questions and Answers in PDF Format

### PL-900 Practice Exam Features:

- \* PL-900 Questions and Answers Updated Frequently
- \* PL-900 Practice Questions Verified by Expert Senior Certified Staff
- \* PL-900 Most Realistic Questions that Guarantee you a Pass on Your First Try
- \* PL-900 Practice Test Questions in Multiple Choice Formats and Updates for 1 Year

**100% Actual & Verified — Instant Download, Please Click**  
**[Order The PL-900 Practice Test Here](#)**